



## HIGH ROAD, NW10

£1,600 per month

This spacious one-bedroom, second-floor apartment is ideally located in Willesden, within easy reach of local amenities and excellent transport links.

Double bedroom  
Open plan  
Integrated kitchen

Tiled shower  
Great storage  
Allocated parking

# STEP INSIDE HIGH ROAD

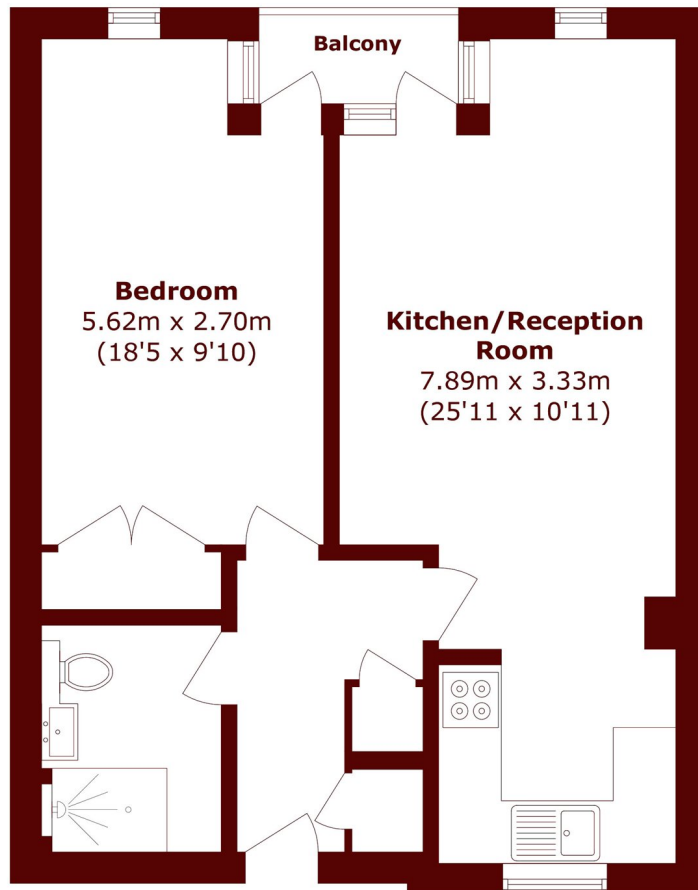

## Second Floor

Total area (approx.): 45.1 sq. m (485.4 sq. ft)

Balcony area (approx.): 2.5 sq. m (26.9 sq. ft)

Willesden Green  
020 8939 1780

Energy Rating: D We aim to make our particulars both accurate and reliable. However, they are not guaranteed; nor do they form part of an offer or contract. If you require clarification on any points then please contact us, especially if you're traveling some distance to view. Please note that appliances and heating systems have not been tested and therefore no warranties can be given as to their good working order

MARSH &  
PARSONS