

Avon Road,
Worcester

Offers Around £40,000

DESCRIPTION

A one bedroom ground floor maisonette with enclosed rear garden. Comprising of front elevation concrete steps to covered walkway, timber gate to rear elevation. Garden with timber fence surround, lawned area, brick-built storage, mainly laid to lawn with a paved patio area and door through to kitchen. Kitchen with single sink and drainer, plumbing for washing machine, various high and low level cupboards and drawers, roll top work surfaces. Hallway with panelled door to WC, understairs storage door to bathroom, lounge and bedroom. WC comprising of low level WC. Lounge with patio door to rear elevation, dado rail, coving to ceiling and gas fire point. Bedroom with double glazed window to front elevation, built-in wardrobes, dado rail. Shower room with shower cubicle and wash hand basin. The property enjoys the benefit of partial double glazing, mains gas and electricity. EPC rating is Grade E - a copy of the full EPC will be available on request

DIRECTIONS

From Shaw Street bear right onto the A38, branch left onto Lowesmoor, bear left onto Lowesmoor Terrace (B4530), at the mini roundabout turn right onto Lowesmoor Place, (B4205), continue forward onto Tolladine Road (B4637), turn right onto Teme Road and then turn right onto Avon Road and you will have arrived

LOCATION

The property is located within close proximity to Worcester Royal Hospital and Worcester Shrubhill Railway Station. The Tolladine Road which is close by allows you main road access to the M5 motorway, a great location

OUR VIEW

A fabulous opportunity to own a one bedroom investment or first time buyer property that could delivery yield of up to 12 percent. The property enjoys the benefit of a spacious garden and would appeal to tenants and landlords alike

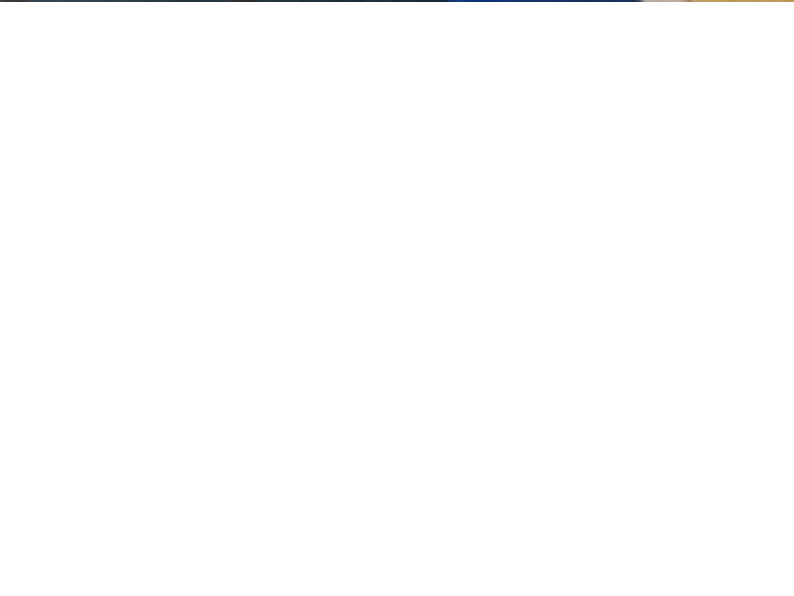

Ground Floor
Floor Size: 34.9 m², 375.9 ft²

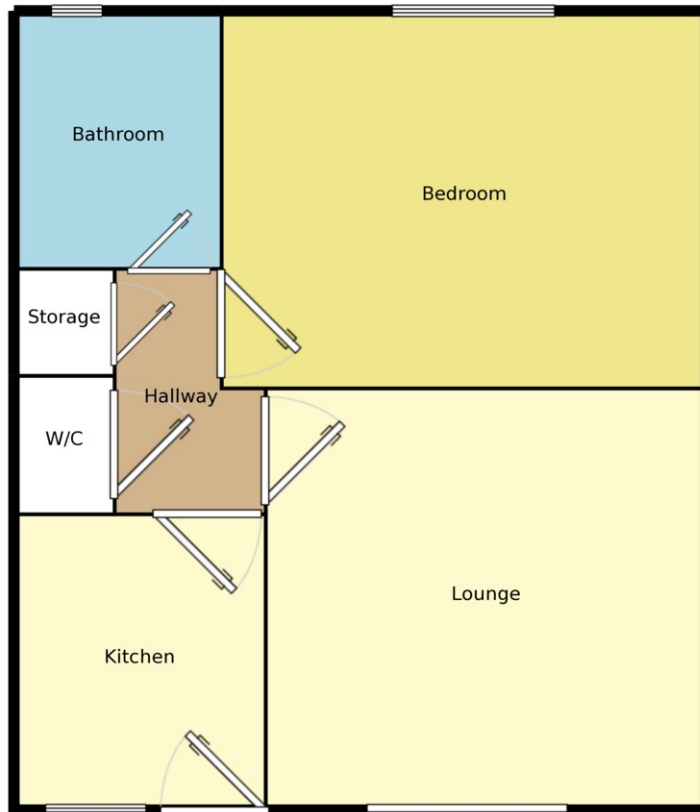

Measurements are approximate. Not to scale. For illustrative purposes only.



For full EPC please contact the branch

Your Move is a trading name of your-move.co.uk, registered in England at Newcastle House, Albany Court, Newcastle Business Park, Newcastle upon Tyne NE4 7YB (number 01864469).

IMPORTANT NOTE TO PURCHASERS: We endeavour to make our sales particulars accurate and reliable, however, they do not constitute or form part of an offer or any contract and none is to be relied upon as statements of representation or fact. The services, systems and appliances listed in this specification have not been tested by us and no guarantee as to their operating ability or efficiency is given. All measurements have been taken as guide to prospective buyers only, and are not precise. Floor plans where included are not to scale and accuracy is not guaranteed. If you require clarification or further information on any points, please contact us, especially if you are travelling some distance to view. Fixtures and fittings other than those mentioned are to be agreed with the seller.

Draft Details

The above details have been submitted to our clients but at the moment have not been approved by them and we therefore cannot guarantee their accuracy and they are distributed on this basis. Please ensure that you have a copy of our approved details before committing yourself to any expense.

*Source: Nielsen, Oct 2012.

**Calls may be recorded and/or monitored for training and/or security purposes.



Foregate Street, Worcester, WR1 1EB

tel: 01905 23456 **

email: Worcester@your-move.co.uk

www.your-move.co.uk - The UK's most visited estate agency website*

Our properties also appear on... **Zoopla.co.uk**

rightmove.co.uk

PrimeLocation.com



YOUR MOVE

WWW.YOUR-MOVE.CO.UK