

# bear

*Estate Agents*



\* Please enquire to Rightmove to request a viewing \* Bear Lettings are delighted to offer to let this Refurbished first floor one bedroom flat, the property boasts open plan living space, modern kitchen and bathroom and spacious bedroom. Available Now.

- Refurbished
- First Floor
- Open Plan Living
- Close to Southend Hospital
- Gas Central Heating
- One Bedroom
- Modern Decor
- Available Now!
- Double Glazing

## Ramuz drive

Westcliff on sea

**£1,050 Per Month**

Per Month



# Ramuz drive





# Floor Plan

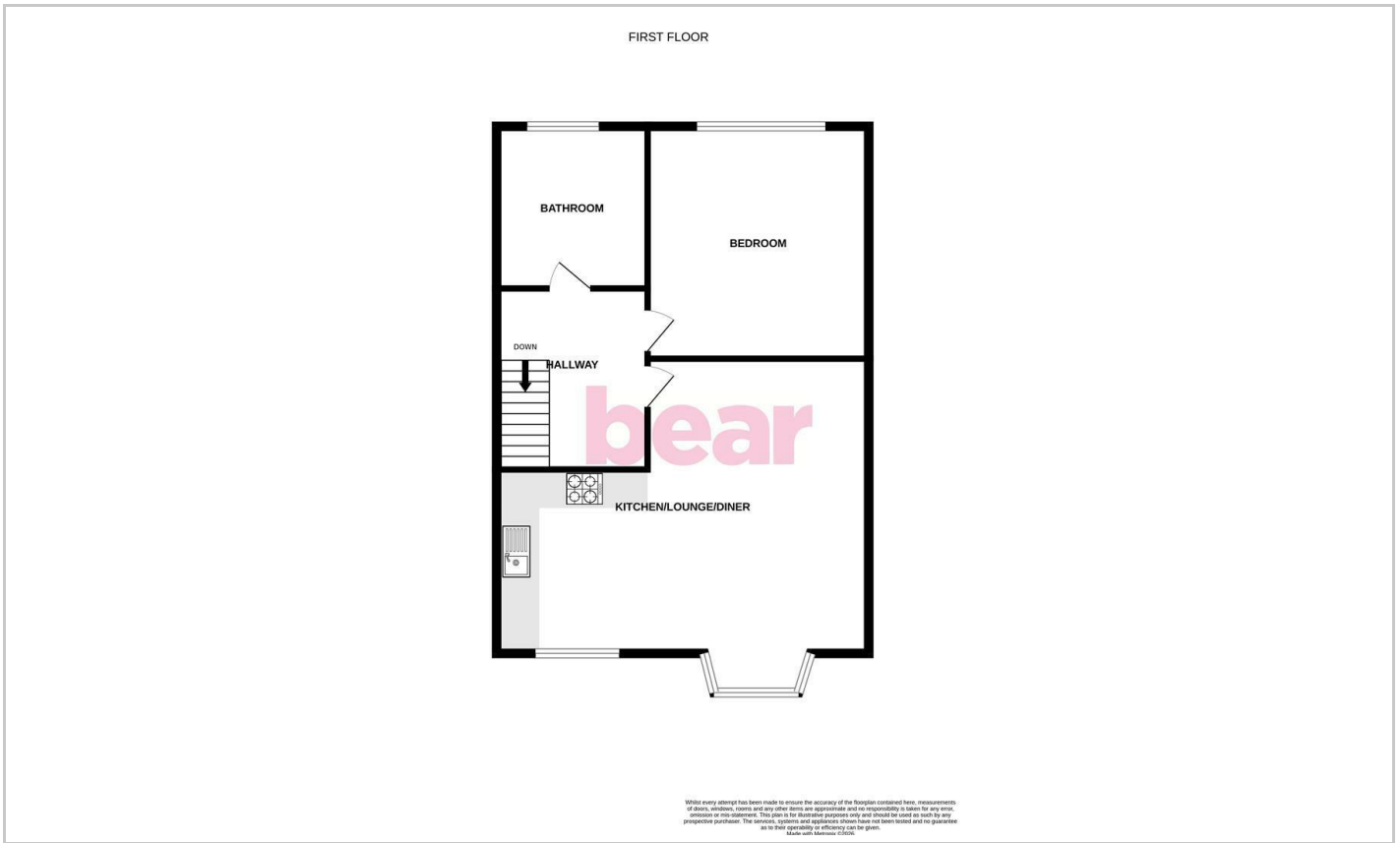

# Area Map

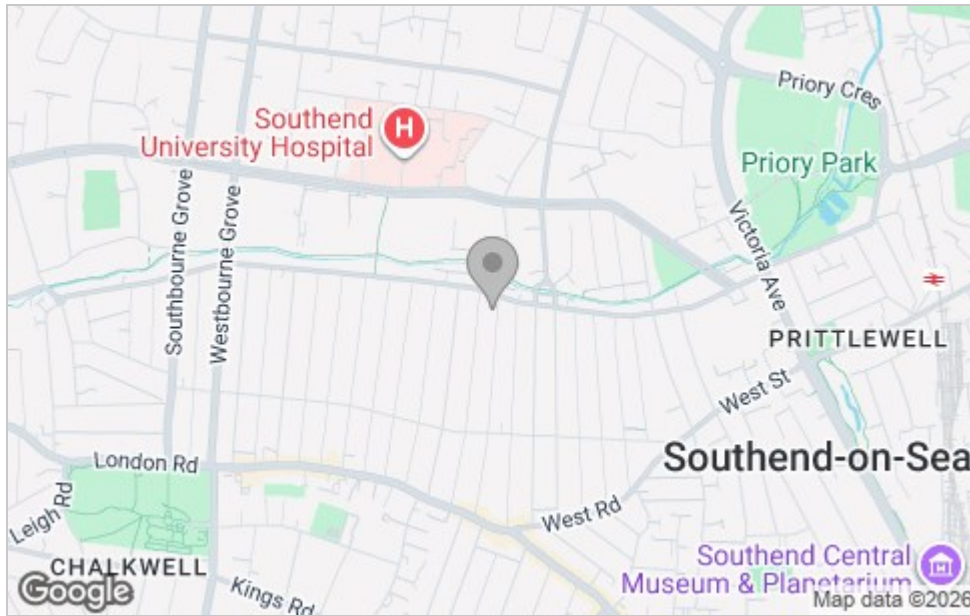

# Viewing

Please contact our Westcliff-on-Sea Office on 01702 899 780 if you wish to arrange a viewing appointment for this property or require further information.

These particulars, whilst believed to be accurate are set out as a general outline only for guidance and do not constitute any part of an offer or contract. Intending purchasers should not rely on them as statements of representation of fact, but must satisfy themselves by inspection or otherwise as to their accuracy. No person in this firm's employment has the authority to make or give any representation or warranty in respect of the property.

797 London Road, Westcliff-on-Sea, Essex, SS0 9SY

Office: 01702 899 780 [info@bearlettings.co.uk](mailto:info@bearlettings.co.uk)

# Energy Efficiency Graph

