



Asking Price Of £130,000

Eight Acre Drive, White
Rock, Paignton, TQ4
7FY

A well presented three bedroom semi detached family home located in the popular white rock development of Paignton. The property comprises of a welcoming entrance hallway, a useful downstairs cloakroom, an open plan lounge/kitchen/diner, three bedrooms with the master being en-suite, a further family bathroom, sunny rear gardens and off road parking. The property is being sold as a shared ownership with a 50% share. The house is ideally situated within easy reach of schools, supermarkets, bus links, South Devon college and more.



ENTRANCE HALL A double glazed composite entrance door opens into the welcoming inner hallway. Features include a useful storage cupboard, radiator, thermostat control, staircase rising to the first floor and doors leading to the cloakroom and main living accommodation.

OPEN-PLAN KITCHEN / DINING / LIVING ROOM A spacious and bright open plan living space offering ample room for both dining and lounge furniture.

The kitchen area is fitted with a comprehensive range of wall and base units with work surfaces over. Integrated appliances include an electric oven and grill, four ring gas hob with extractor hood, fridge/freezer, and a stainless steel sink with drainer. There is additional space and plumbing for a washing machine, tumble dryer and fridge freezer. A front facing double glazed window provides natural light, while a cupboard houses the gas combination boiler.

The living and dining areas offer a flexible layout with two radiators, internet and television point, double glazed French doors, accompanied by full height side panels windows, open directly onto the rear garden.

CLOAKROOM A useful downstairs cloakroom fitted with a low level WC and pedestal wash hand basin. Additional features include a radiator and an obscured double glazed window.

FIRST FLOOR

BEDROOM ONE A generously sized principal bedroom positioned to the front of the property. Features include a double glazed window, radiator, space suitable for wardrobes and access to the en-suite shower room.

EN-SUITE Comprising a walk in shower enclosure, low level WC and pedestal wash hand basin. Finished with part tiled walls, radiator and extractor fan.

BEDROOM TWO A comfortable double bedroom overlooking the rear garden, benefiting from a double glazed window and radiator.

BEDROOM THREE A versatile room suitable as a child's bedroom, nursery, or home office. Includes a double glazed window and radiator.

FAMILY BATHROOM Fitted with a panelled bath, pedestal wash hand basin and low level WC. Additional features include a radiator, extractor fan and obscured double glazed window.

OUTSIDE

REAR GARDEN The south facing rear garden has been arranged for ease of maintenance and incorporates a patio seating area, lawn and raised decking, providing an ideal setting for outdoor dining and relaxation.

PARKING Off road parking is available directly to the front of the property.

AGENT'S NOTE This property is being offered on a 50% shared ownership basis.

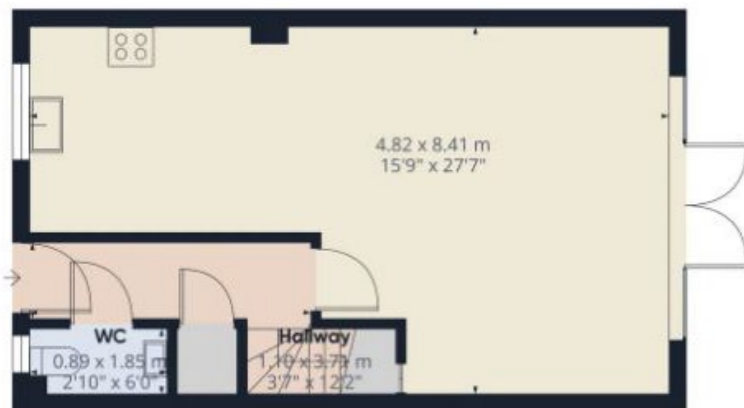

Floor 0

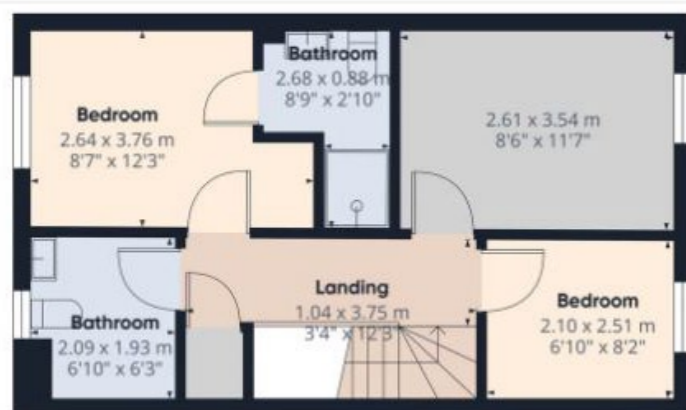

Floor 1

Address 'Eight Acre Drive, White Rock, Paignton, TQ4 7FY'

Tenure 'Share Of Freehold'

Council Tax Band 'C'

EPC Rating '84 | B'

Taylor's Estate Agents
256 Torquay Road
Paignton
TQ3 2EZ