



**Banfield's, Shillingford Tiverton EX16 9BA**



**welcome to**

## **Banfield's, Shillingford Tiverton**

This two bedroom mid terrace home offers spacious accommodation throughout. In brief this includes a Kitchen/diner a spacious lounge. There are two double bedrooms and a modern shower room. Outside, there is a rear enclosed garden and allocated parking.NO ONWARD CHAIN.

### **Description**

Located in a Cul de sac position you will find this two-bedroom mid terrace home. On approaching is residents parking. On opening the front door is a spacious lounge, to the rear kitchen/ dining room with access to the garden. Upstairs you will find two double bedrooms and a modern shower room.

Outside, the rear garden is enclosed and laid to lawn. This property is offered to the market with NO ONWARD CHAIN and will be offered for sale at our auction unless sold prior. For more information contact Fox & Sons Tiverton.

For Sale by Traditional Auction. Grand Connaught Rooms, Great Queen Street 61-65, Covent Garden, London, WC2B 5DA

### **Entrance Hall**

UPVC door to front. Door to lounge, stairs to first floor, radiator.

### **Lounge**

16' 3" Max x 10' 11" Max ( 4.95m Max x 3.33m Max )  
Double glazed window to front. Door to kitchen, open fire, radiator.

### **Kitchen**

19' 3" Max x 7' 5" ( 5.87m Max x 2.26m )  
Three double glazed windows to rear and door to rear. The kitchen is equipped with a range of wall and base units with worktop over. Stainless steel sink one bowl and drainer, induction hob, extractor hood, electric oven built in. Radiator, Understairs storage area.



**Bedroom One**

16' 2" Max x 9' 8" Max ( 4.93m Max x 2.95m Max )  
Double glazed window to front. Built in airing cupboard, radiator.

**Bedroom Two**

10' 10" Max x 8' 8" Max ( 3.30m Max x 2.64m Max )  
Double glazed window to rear. Radiator.

**Bathroom**

Double glazed window to rear. Wash hand basin, WC, walk in shower.

**Front Garden**

Laid to lawn.

**Rear Garden**

The rear garden is fully enclosed and mainly laid to lawn with a concrete area, mature trees and shrubs. Outside shed, oil tank.



***view this property online*** [fox-and-sons.co.uk/Property/TVT105865](https://fox-and-sons.co.uk/Property/TVT105865)



welcome to

## Banfields, Shillingford Tiverton

- Mid terrace two Bedroom House
- Kitchen/ diner
- Spacious Lounge
- Rear Enclosed Garden
- NO ONWARD CHAIN

Tenure: Freehold EPC Rating: D

Council Tax Band: B

**£130,000**

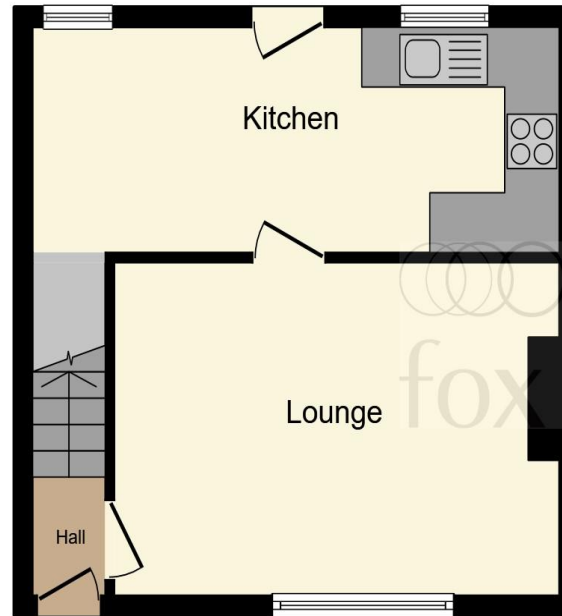

**Ground Floor**

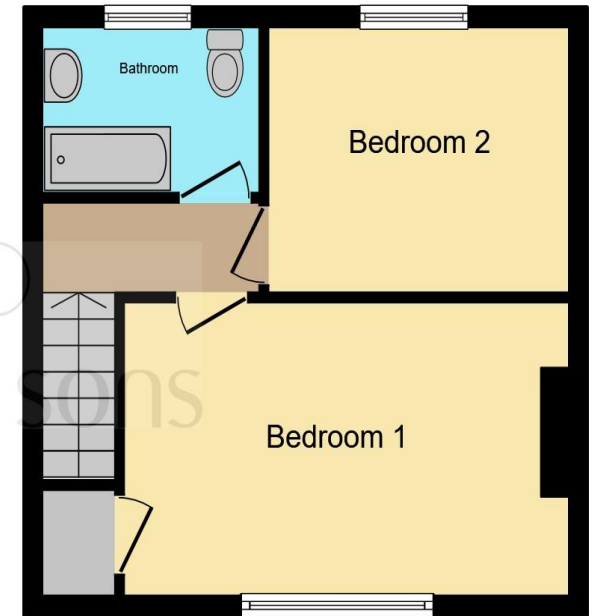

**First Floor**

This floor plan is for illustrative purposes only. It is not drawn to scale. Any measurements, floor areas (including any total floor area), openings and orientation are approximate. No details are guaranteed, they cannot be relied upon for any purpose and they do not form part of any agreement. No liability is taken for any error, omission or misstatement. A party must rely upon its own inspection(s). Powered by [www.focalagent.com](http://www.focalagent.com)

**view this property online** [fox-and-sons.co.uk/Property/TVT105865](http://fox-and-sons.co.uk/Property/TVT105865)



Property Ref:  
TVT105865 - 0006

1. MONEY LAUNDERING REGULATIONS Intending purchasers will be asked to produce identification documentation at a later stage and we would ask for your co-operation in order that there is no delay in agreeing the sale. 2. These particulars do not constitute part or all of an offer or contract. 3. The measurements indicated are supplied for guidance only and as such must be considered incorrect. Potential buyers are advised to recheck measurements before committing to any expense. 4. We have not tested any apparatus, equipment, fixtures or services and it is in the buyers interest to check the working condition of any appliances. 5. Where an EPC, or a Home Report (Scotland only) is held for this property, it is available for inspection at the branch by appointment. If you require a printed version of a Home Report, you will need to pay a reasonable production charge reflecting printing and other costs. 6. We are not able to offer an opinion either written or verbal on the content of these reports and this must be obtained from your legal representative. 7. Whilst we take care in preparing these reports, a buyer should ensure that his/her legal representative confirms as soon as possible all matters relating to title including the extent and boundaries of the property and other important matters before exchange of contracts.

Fox & Sons is a trading name of Sequence (UK) Limited which is registered in England and Wales under company number 4268443, Registered Office is Cumbria House, 16-20 Hockliffe Street, Leighton Buzzard, Bedfordshire, LU7 1GN. VAT Registration Number is 500 2481 05.

  
fox & sons



**01884 256041**



[tiverton@fox-and-sons.co.uk](mailto:tiverton@fox-and-sons.co.uk)



36 Bampton Street, TIVERTON, Devon, EX16 6AH



**[fox-and-sons.co.uk](http://fox-and-sons.co.uk)**