



## Lowdell Close, Yiewsley, West Drayton, UB7 8BD

- Ground Floor
- Communal garden
- Easy reach of Hillingdon Hospital
- Available NOW
- Own front door
- Allocated parking
- Part Furnished
- EPC Rating -D

**£1,300 PCM**



**Description**

Offered to the lettings market for the first time, a one bedroom ground floor maisonette with its own entrance located in a popular area close to Hillingdon Hospital, Stockley Business Park, Heathrow, Brunel University and access to the West Drayton Station. Benefits from wood laminate flooring and repainted throughout. Allocated parking and communal garden. Presented part furnished and available for NOW.

**Ground Floor**  
Approx. 39.6 sq. metres (426.4 sq. feet)

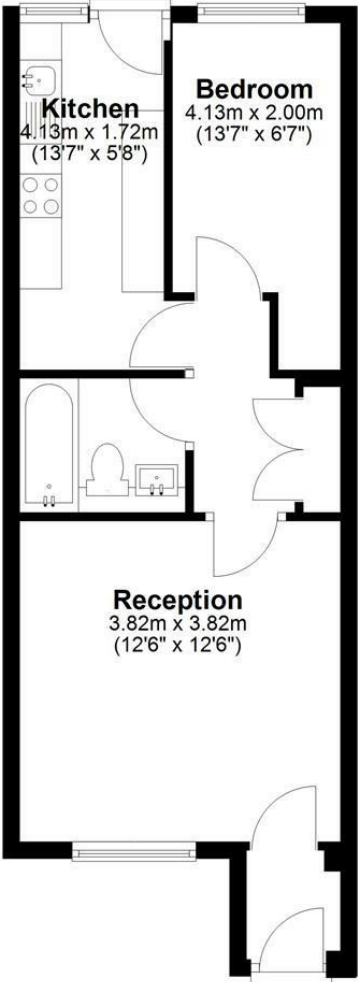

Total area: approx. 39.6 sq. metres (426.4 sq. feet)

**IMPORTANT NOTICE**

These particulars have been prepared upon information supplied by the Vendor and should be verified by your surveyors and solicitors. We have prepared these sales particulars as a general guide to give a broad description of the property. They are not intended to constitute part of an offer or contract. We have not carried out a structural survey and the services, appliances and specific fittings have not been tested. All photographs, measurements, floor plans and distances referred to are given as a guide only and should not be relied upon for the purchase of carpets or any other fixtures or fittings. Lease details service charge and ground rent (where applicable) are given as a guide only and should be checked and confirmed by your solicitor prior to exchange of contracts