

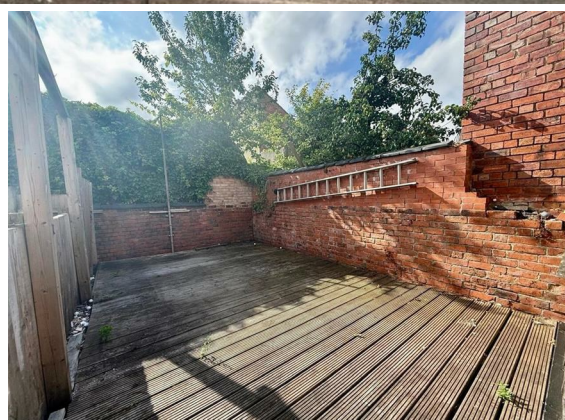

2 Bed
House
located in

£795 Per month



SMART STREET
THE PROPERTY PEOPLE

GROUND FLOOR

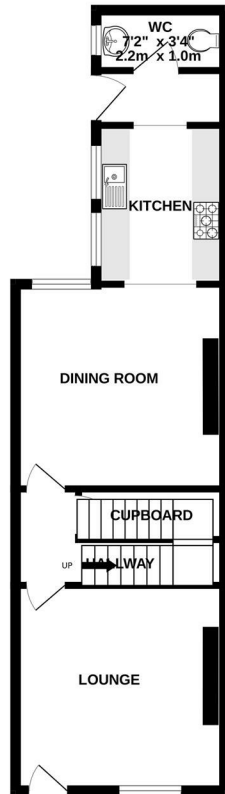

1ST FLOOR



TWO BEDROOMS, TWO STORY

Whilst every attempt has been made to ensure the accuracy of the floorplan contained here, measurements of doors, windows, rooms and any other items are approximate and no responsibility is taken for any error, omission or mis-statement. This plan is for illustrative purposes only and should be used as such by any prospective purchaser. The services, systems and appliances shown have not been tested and no guarantee as to their operability or efficiency can be given.
Made with Metropix (©2026)

DIRECTIONS

CONTACT

14 Withambrook Park
Grantham
NG31 9ST

E: info@smartstreetproperty.com
T: 01476 247107

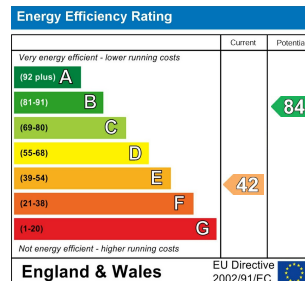

SMART STREET
THE PROPERTY PEOPLE