



Kings Keep, Fleet GU52 7UW

£1,950 PCM

Luff
ASSOCIATES
letting specialists



Kings Keep, Fleet. GU52 7UW

£1,950 PCM

- Semi detached bungalow
- Two reception rooms
- Driveway parking
- Private rear garden
- Two - three bedrooms
- Good size kitchen
- Garage
- Unfurnished



Description

This delightful two - three bedroom semi-detached bungalow offers a perfect blend of comfort and convenience. With one - two reception rooms and a conservatory, this property provides ample space for relaxation and entertaining guests. The bungalow features two bedrooms; one on the ground floor and one on the first floor, but there is the possibility of using one of the other rooms as a third bedroom if required. The bathroom is thoughtfully designed, ensuring both functionality and comfort.

One of the standout features of this property is the driveway, accommodating 2 - 3 cars, which is a rare find in this desirable location. It also boasts a garage, perfect for storage or keeping a small car in. The garden is laid to lawn and patio and great for the summer months.

Unfurnished and available 1st July 2026

Council tax band: D

EPC rating: D

Deposit = 5 weeks rent - £2,250

First Months rent - £1,950

Holding deposit - £450 (will be deducted from the first months rent upon move in)



Floorplan

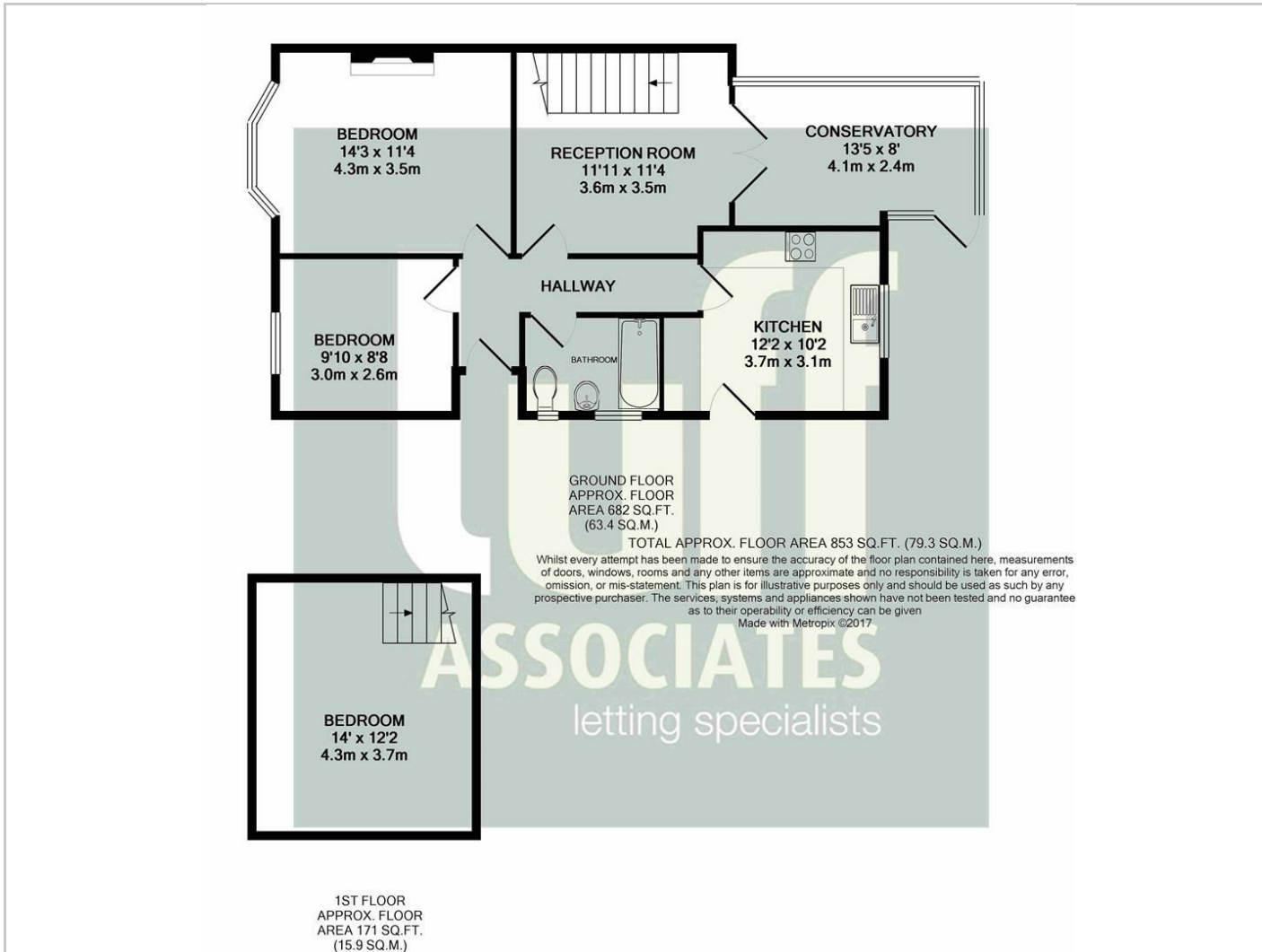

Area Map

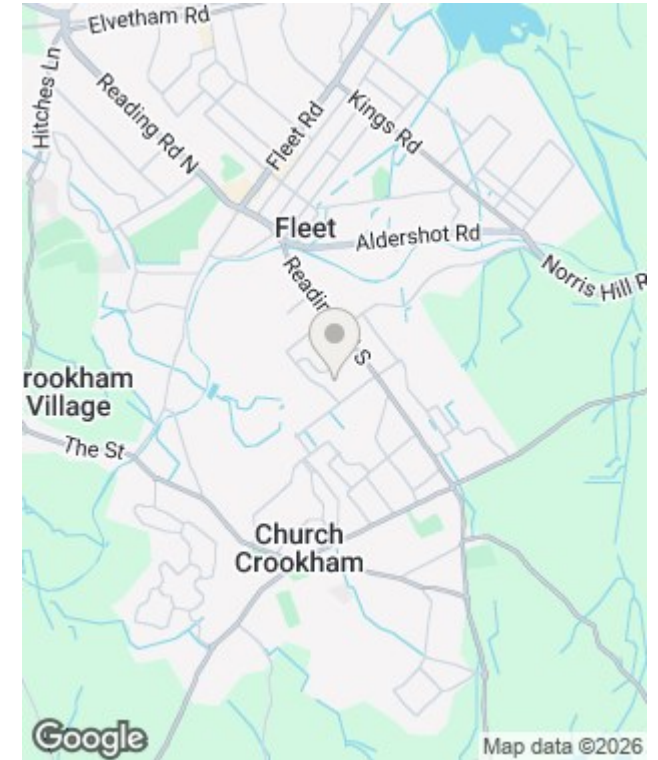

Energy Efficiency Rating	
Current	Potential
Very energy efficient - lower running costs	
(92 plus) A	
(81-91) B	
(69-80) C	
(55-68) D	
(39-54) E	
(21-38) F	
(1-20) G	
Not energy efficient - higher running costs	
67	85
England & Wales EU Directive 2002/91/EC	

Environmental Impact (CO ₂) Rating	
Current	Potential
Very environmentally friendly - lower CO ₂ emissions	
(92 plus) A	
(81-91) B	
(69-80) C	
(55-68) D	
(39-54) E	
(21-38) F	
(1-20) G	
Not environmentally friendly - higher CO ₂ emissions	
England & Wales EU Directive 2002/91/EC	



In partnership with
LUFF & WILKIN
 sales 01252 838 899

Disclaimer: The Rent advertised does not include the Tenancy Deposit or any fee's or charges which are payable. Further information can be obtained from the agent or at the point of viewing. These details have been prepared and issued in good faith and do not constitute representations of fact or form part of any offer or contract Luff Associates Ltd have not carried out a structural survey of the property, nor have we tested any of the services or appliances. All measurements are intended to be approximate only and all photographs show parts of the property as they were at the time they were taken. Any reference to alterations or particular use of the property wherever stated, is not a statement that planning, building regulations or other relevant sent has been obtained