



**Haydons Road, SW19**  
**£799,950**

**Dexters**



## Haydons Road, SW19

A fine example of a three bedroom, two bathroom Victorian terraced house, within the Poets. The south west facing garden has been landscaped to a stunning standard, with the house measuring 1,250 square feet.

The ground floor has a reception room, with engineered wood flooring. The high specification follows throughout, in to the extended kitchen. The kitchen has granite work surfaces and bi-folding doors to the south west facing garden.

The first floor offers two double bedrooms, both with built in wardrobes and a family bathroom. The loft was converted in 2019 to offer a stunning principle bedroom, complete with built in wardrobes, Juliette balcony and unique Balinese lava stone walk-in shower room.

The house has been virtually totally re-plumbed and rewired, extended to the back and loft, providing the perfect luxury three bedroom house for any buyer to settle down.

Located close to the Town Centre, with South Park Gardens nearby and a number of stations including South Wimbledon (Northern Line) and Wimbledon (District Line, Mainline and Overground).

### Features

- Three Double Bedrooms
- Two Bathrooms
- South West Garden
- Loft and Rear Extended
- Lava Stone Bathroom
- Rewired and Re-Plumbed













# Haydons Road, London, SW19

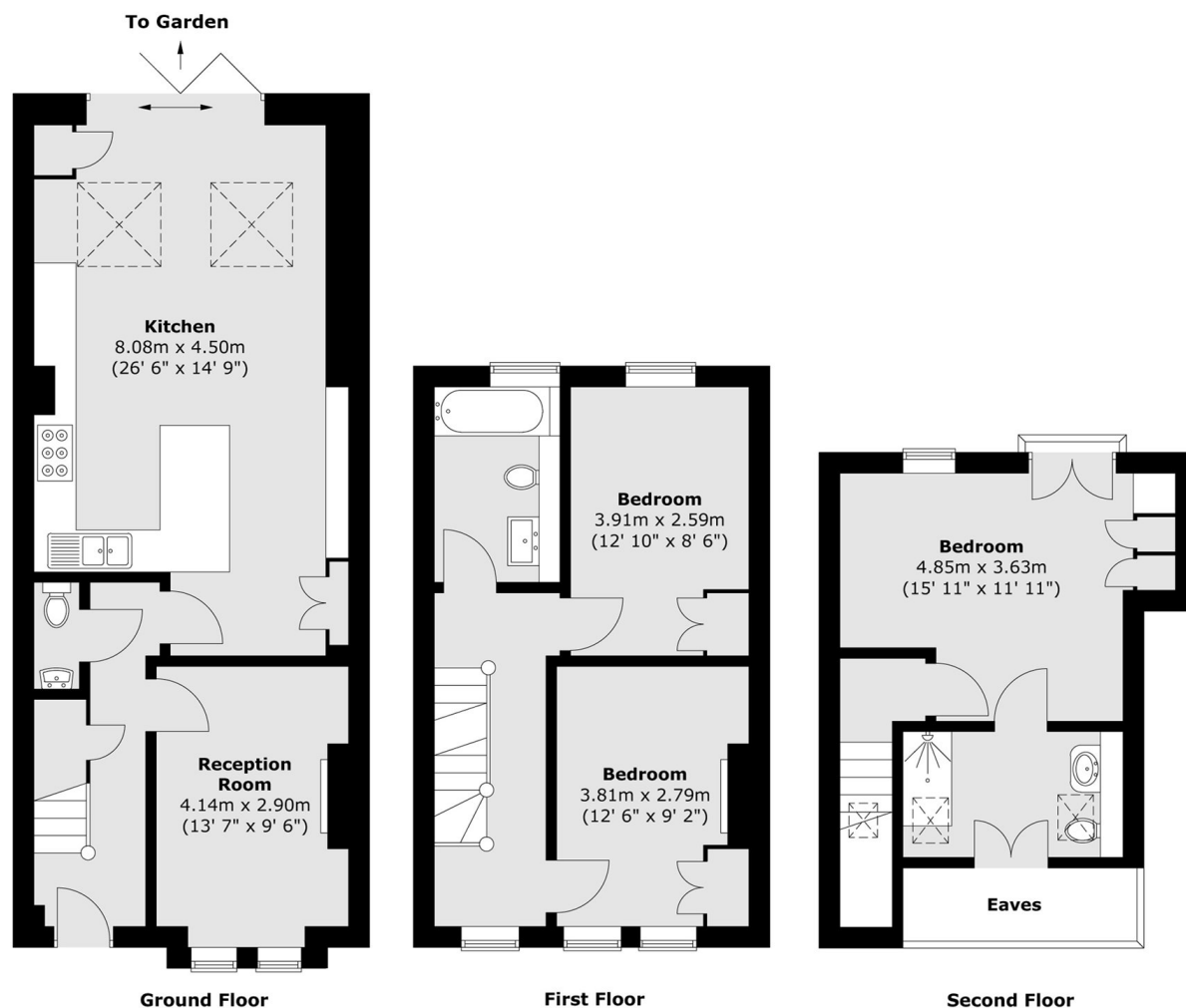

Total area (approx.) : 116.1 sq. m (1250 sq. ft)  
(Excluding eaves)