

HUNTERS[®]

HERE TO GET *you* THERE



Otley Road

ShIPLEY, Bradford, BD18 2PR

£675 Per Calendar Month



A first floor apartment situated within close proximity to ShIPLEY town centre and railway station. The property briefly comprises: entrance hallway, living room, modern kitchen, double bedroom and bathroom with three piece bathroom suite in white and shower over bath. The property has been upgraded with new decoration and flooring. The property is full of character with high ceilings and early viewing is recommended.



Area Map



Floor Plans

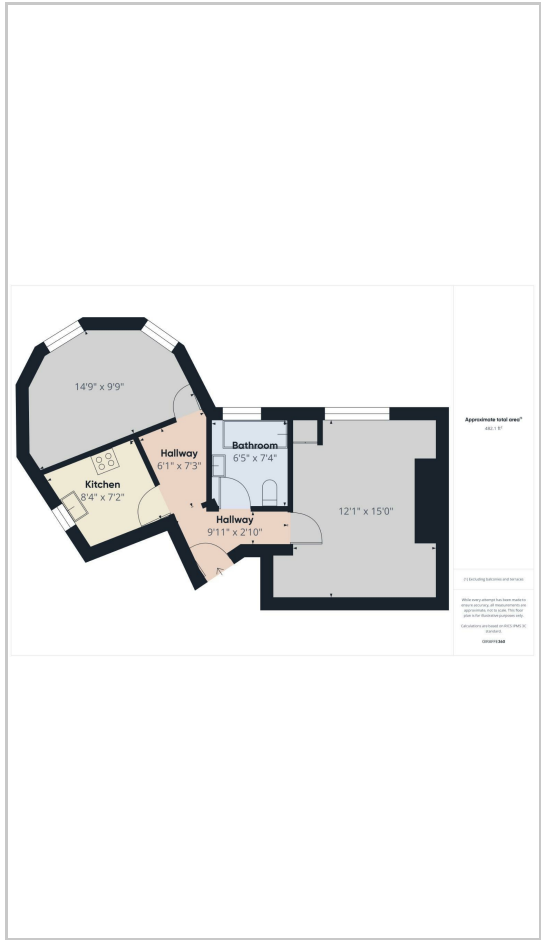

Energy Efficiency Graph

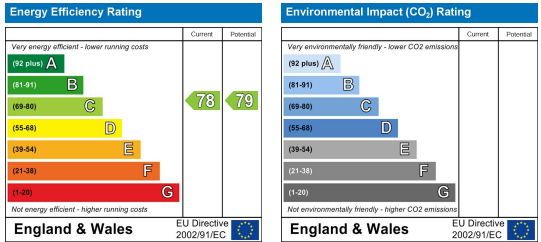

These particulars are intended to give a fair and reliable description of the property but no responsibility for any inaccuracy or error can be accepted and do not constitute an offer or contract. We have not tested any services or appliances (including central heating if fitted) referred to in these particulars and the purchasers are advised to satisfy themselves as to the working order and condition. If a property is unoccupied at any time there may be reconnection charges for any switched off/disconnected or drained services or appliances - All measurements are approximate. **THINKING OF SELLING?** If you are thinking of selling your home or just curious to discover the value of your property, Hunters would be pleased to provide free, no obligation sales and marketing advice. Even if your home is outside the area covered by our local offices we can arrange a Market Appraisal through our national network of Hunters estate agents.