

# KEYSTONE



Lower Higham Road, Gravesend, DA12 2NQ

£1,450 Per Calendar Month

- A beautifully presented two bedroom terraced house
- Private rear garden
- Newly fitted bathroom
- Available now
- Two bedrooms
- Attractive decor and flooring
- Modern Kitchen
- Two reception rooms
- Sought after location of Chalk
- Central heating/double glazing

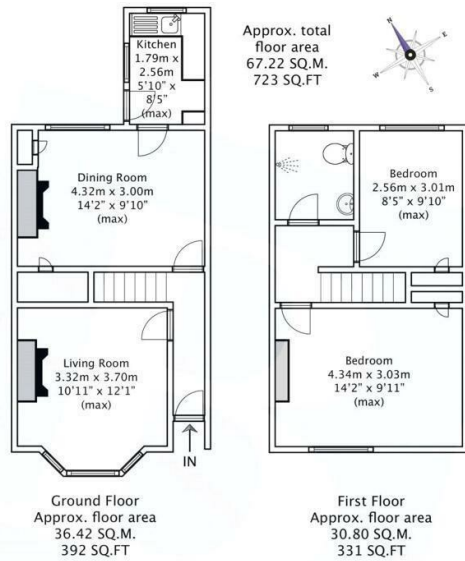

**Disclaimer**  
 All measurements have been taken as a guide to prospective buyers only and are not precise. This plan is for illustrative purposes only and no responsibility is taken for any error, omission, or misstatement. The services, systems and appliances shown have not been tested and no guarantee as to their operability or efficiency can be given. Measurements may have been taken from the widest area and may include wardrobe / cupboard space. No guarantee is given to any measurements including total areas. Buyers are advised to take their own measurements.

REF: AA1973  
 Created by Agents Aperture  
 www.agentsaperture.co.uk  
 © Agents Aperture



## Directions

## Viewings

Viewings by arrangement only. Call 01473 221 399 to make an appointment.

## EPC Rating:

D

| Energy Efficiency Rating                    |  | Current                 | Potential |
|---|--|-------------------------|-----------|
| Very energy efficient - lower running costs |  |                         |           |
| (92 plus) <b>A</b>                          |  |                         |           |
| (81-91) <b>B</b>                            |  |                         | 85        |
| (69-80) <b>C</b>                            |  |                         |           |
| (55-68) <b>D</b>                            |  | 64                      |           |
| (39-54) <b>E</b>                            |  |                         |           |
| (21-38) <b>F</b>                            |  |                         |           |
| (1-20) <b>G</b>                             |  |                         |           |
| Not energy efficient - higher running costs |  |                         |           |
| <b>England &amp; Wales</b>                  |  | EU Directive 2002/91/EC |           |