



Colindale ~ Richmond Park Ave ~ Bournemouth ~ BH8 9DL

16 High Street, Christchurch Dorset BH23 1AY

www.jordanmarksestates.co.uk

01202 484444

JIM
Jordan Marks Estates
Signature Homes



This highly desirable and immaculately presented spacious three bedroom first floor apartment is superbly situated close to excellent public transport links to Bournemouth Town Centre and Poole. The well-appointed accommodation comprises an entrance hallway with doors off leading to the separate generous sitting room with feature bay window with front aspect, the kitchen breakfast room offers a wide range of wall and base units, space for dining, electric oven and hob and a full range of integrated appliances, the kitchen further benefits from a door to the sunny balcony overlooking the front of the property. The accommodation continues with a spacious master bedroom with built in wardrobes and contemporary ensuite shower room with white suite, guest double bedroom and further single bedroom, contemporary family bathroom with white suite and feature tiling. This immaculately presented apartment externally benefits from one allocated off road parking space and use of the communal enclosed rear gardens which are mainly decked with lawned areas.



Floor Plan
812 Internal SQ. FT
75 Internal SQ. M



1 Colindale
Richmond Park Avenue
Bournemouth
BH8

Total area (Approx)

812 sq ft
75 sq m

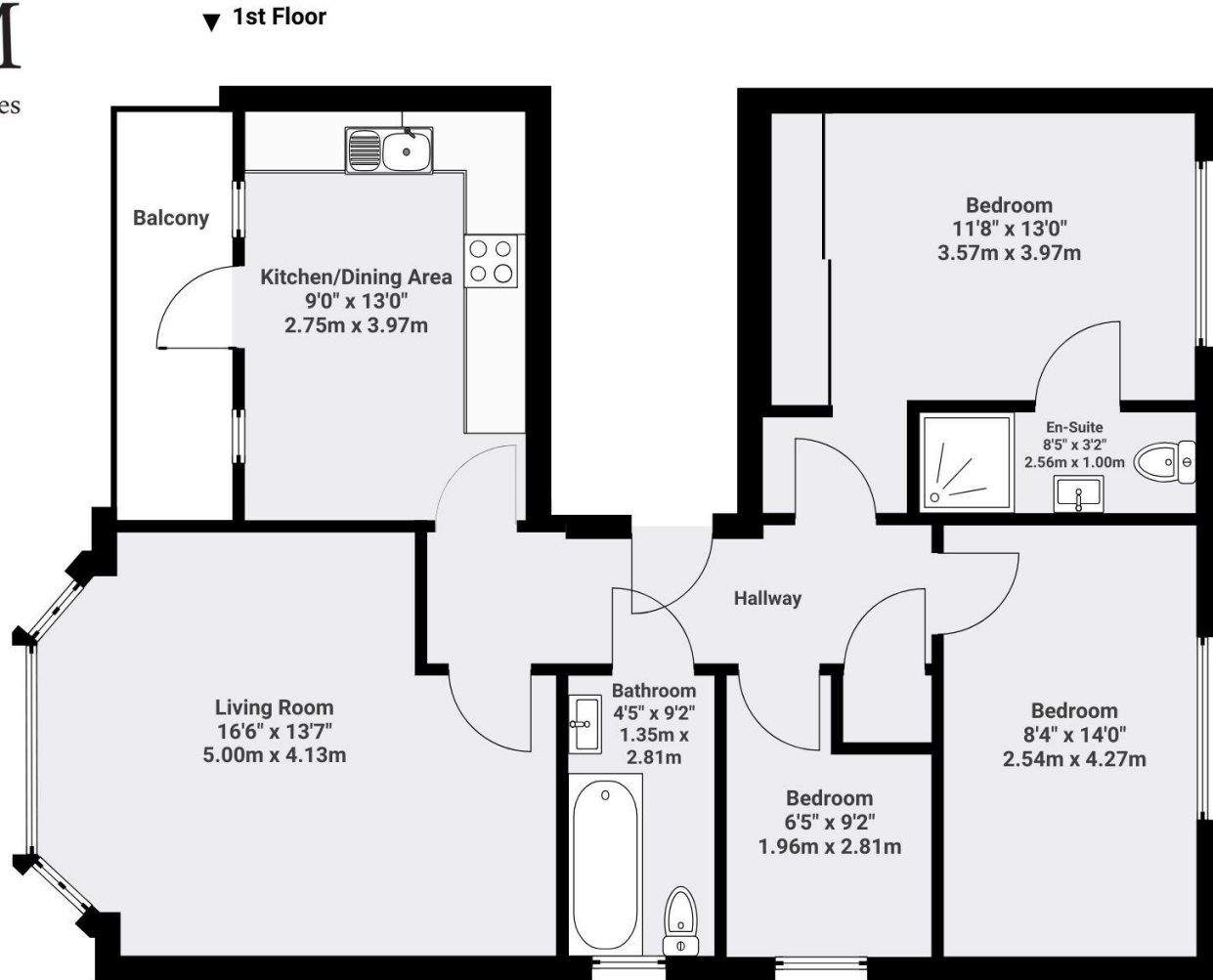

The floorplan is for illustrative purposes only. All dimensions and measurements are approximate. Actual sizes may vary due to construction tolerances, finishing variations, and other factors. Prospective buyers or tenants are advised to verify all measurements independently before making any decisions. FJVISUALS



Situation

This highly desirable first floor apartment is superbly situated close to Bournemouth Town Centre with its blue flag award winning beaches and public gardens. Good public transport links to Poole and Christchurch are located nearby. The New Forest National Park and Southampton Town Centre are an easy commute from the property.

Local Authority and School Catchments

BCP Council ~ Tax Band C

Tenure

Leasehold 120 years remaining ~ £250 Ground Rent.

Service charge - £2100 yearly including Building Insurance.

Asking Price

£275,000





Disclaimer Property Details: These particulars, whilst believed to be accurate are set out as a general outline only for guidance and do not constitute any part of an offer or contract. Intending purchasers should not rely on them as statements or representation of fact, but must satisfy themselves by inspection or otherwise as to their accuracy. We have not carried out a detailed survey nor tested the services, appliances and specific fittings. Room sizes should not be relied upon for carpets and furnishings. The measurements given are approximate. No person in this firms' employment has the authority to make or give any representation or warranty in respect of the property.

16 High Street, Christchurch Dorset BH23 1AY
www.jordanmarksestates.co.uk
01202 484444

