

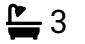

## Mill Lane, Bentley Heath, Solihull, B93 8NZ

Offers Over £740,000

 4  3  2



A four bedroom detached family home situated on Mill Lane, Bentley Heath. Viewings are highly recommended.

## Key Features

- Spacious four bedroom family home
- Large lounge/diner ideal for family living
- Bright conservatory overlooking the rear garden
- Ground floor WC
- Integral garage
- Sought-after location on Mill Lane, B93
- Separate front lounge
- Fitted kitchen with adjoining utility room
- Home office/study
- Ideal long-term family home close to schools, amenities and transport links

GROUND FLOOR  
1245 sq.ft. (115.7 sq.m.) approx.

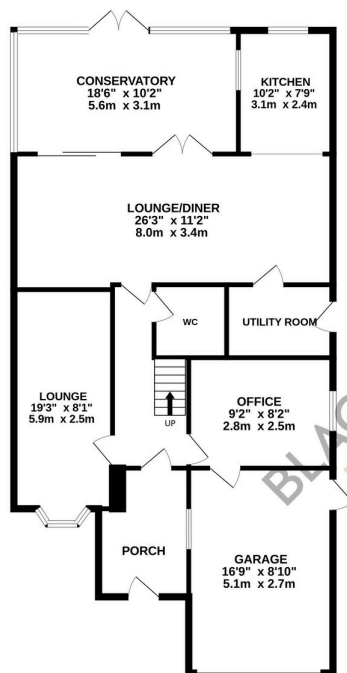

1ST FLOOR  
785 sq.ft. (72.9 sq.m.) approx.

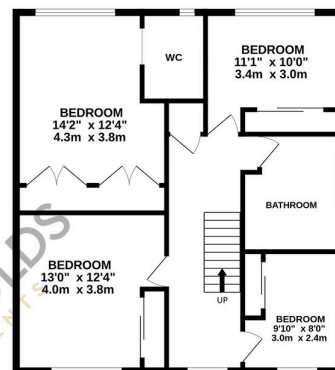

TOTAL FLOOR AREA: 2030 sq.ft. (188.6 sq.m.) approx.

Whilst every attempt has been made to ensure the accuracy of the floorplan contained here, measurements of doors, windows, rooms and any other items are approximate and no responsibility is taken for any error, omission or mis-statement. This plan is for illustrative purposes only and should be used as such by any prospective purchaser. The services, systems and appliances shown have not been tested and no guarantee as to their operability or efficiency can be given.  
Made with Metropix i2026