



House - Terraced

3 CAVELL WALK, FAIRFIELD PARK, STOTFOLD, HITCHIN, SG5 4FE

PCM
£1,500

FEATURES

- **** TWO DOUBLE BEDROOMS ****
- **** Two bathrooms ****
- **Open Plan Kitchen/ Diner**
- **** Separate Lounge ****
- **Private Garden**
- **** Parking ****
- **Garage To Rear Of Property**
- **Within Easy Reach Of The A1M**
- **Close To Both Letchworth and Arlesey Train Stations**
- **EPC Rating C Council Tax Band C**



2 Bedroom House - Terraced located in Hitchin

**** FULLY BOOKED FOR VIEWINGS AT PRESENT **** A beautifully presented two double bedroom house. The property benefits from being located on a peaceful walkway within Fairfield Park and includes modern kitchen / diner, two double bedrooms, one of which en-suite, private garden, parking and garage. EPC C Council Tax Band C

Call us on

01462 659 730

rentals@firststep.ltd

www.firststep.ltd

Council Tax Band

C

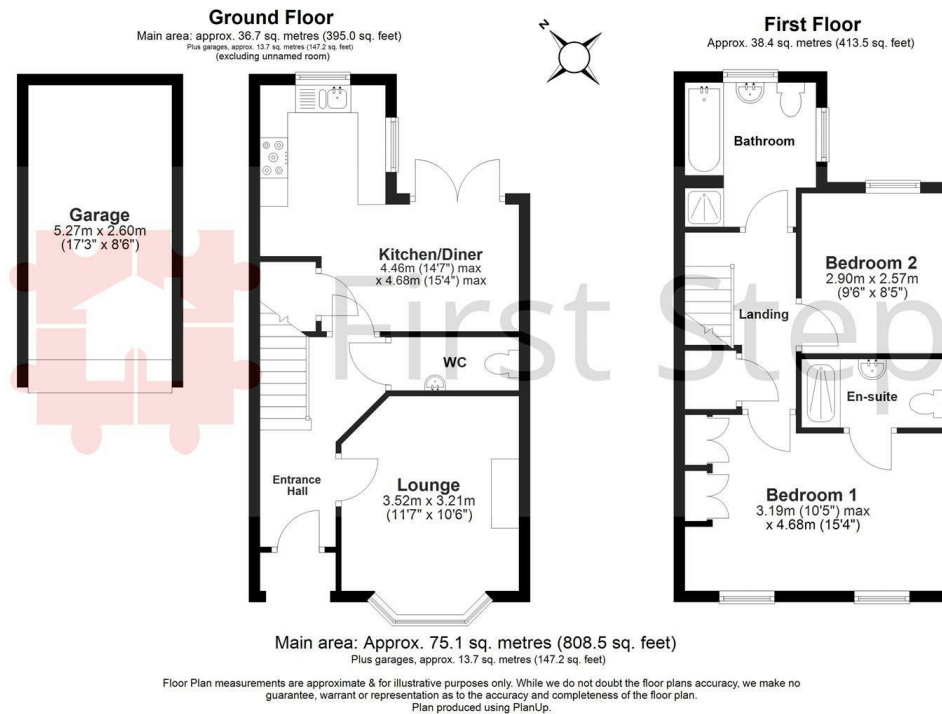

Energy Efficiency Rating		Current	Potential
Very energy efficient - lower running costs			
(92 plus) A			
(81-91) B			88
(69-80) C		69	
(55-68) D			
(39-54) E			
(21-38) F			
(1-20) G			
Not energy efficient - higher running costs			
England & Wales		EU Directive 2002/91/EC	

Agents Note: Whilst every care has been taken to prepare these particulars, they are for guidance purposes only. All measurements are approximate and are for general guidance purposes only and whilst every care has been taken to ensure their accuracy, they should not be relied upon and potential buyers are advised to recheck the measurements.