

Jukes & Co

Estate Agents



Huntly Road

, London, SE25 6QY

£600,000



Beautifully Presented Three-Bedroom Victorian Home

A stunning three-bedroom Victorian home, beautifully decorated throughout and offering the perfect blend of period charm and modern living. Ideally located within walking distance of both Selhurst and Norwood Junction stations, the property provides excellent transport links into Central London, including direct services to London Bridge from Norwood Junction in approximately 12 minutes.

The accommodation features a bright and spacious lounge, a luxury fitted kitchen opening into a separate dining area, ideal for entertaining, and a convenient downstairs cloakroom. Upstairs are three well-proportioned bedrooms and a stylish family bathroom, with further potential for a loft conversion (subject to the usual consents). A beautifully kept garden.

Perfectly positioned for families, the property is close to highly regarded schools, local bus routes, the High Street, shops, cafés and a popular yoga studio. The beautiful South Norwood Lake and Grounds is also just a short walk away, providing a wonderful place to enjoy weekend walks, outdoor activities and family time.

A truly exceptional home in a highly desirable location, offering style, space and convenience in equal measure.



Area Map



Floor Plan

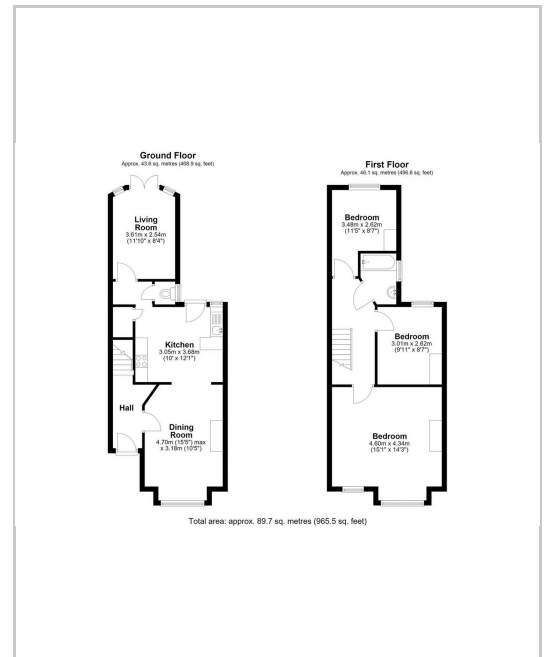

Energy Efficiency Graph

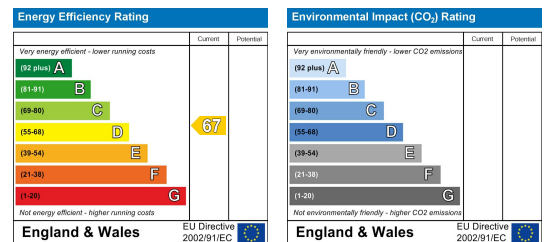

These particulars, whilst believed to be accurate are set out as a general outline only for guidance and do not constitute any part of an offer or contract. Intending purchasers should not rely on them as statements of representation of fact, but must satisfy themselves by inspection or otherwise as to their accuracy. No person in this firm's employment has the authority to make or give any representation or warranty in respect of the property.

Sales and Lettings

76 High Street, South Norwood, London SE25 6EB

T: 020 8653 9393 · F: 020 8771 5551 · E: sales@jukesestateagents.com · E: lettings@jukesestateagents.com

W: jukesestateagents.com