



Shirland Mews | | London | W9

Asking Price - Asking price £1,475,000



- 3 x 1 bedroom apartments • Brand newly refurbished throughout
- Quiet Mews location • Freehold

An exceptional investment opportunity to acquire a trio of beautifully appointed one-bedroom apartments, set within an elegant converted mews house nestled within the charming and highly sought-after Shirland Mews.

This charming property has been thoughtfully refurbished to offer three individually designed apartments, each recently refurbished to an exacting standard. The interiors combine contemporary sophistication with subtle architectural character, featuring high quality finishes, refined detailing, and carefully considered layouts that maximise light and space throughout.

Each apartment offers well proportioned accommodation, including stylish open plan living areas, sleek fully integrated kitchens, and luxurious bathroom suites. The refurbishment has been executed with a clear emphasis on quality and longevity, making the units equally suited to





Shirland Mews
 Approx. Gross Internal Area
 39.31 sq m / 423 sq ft

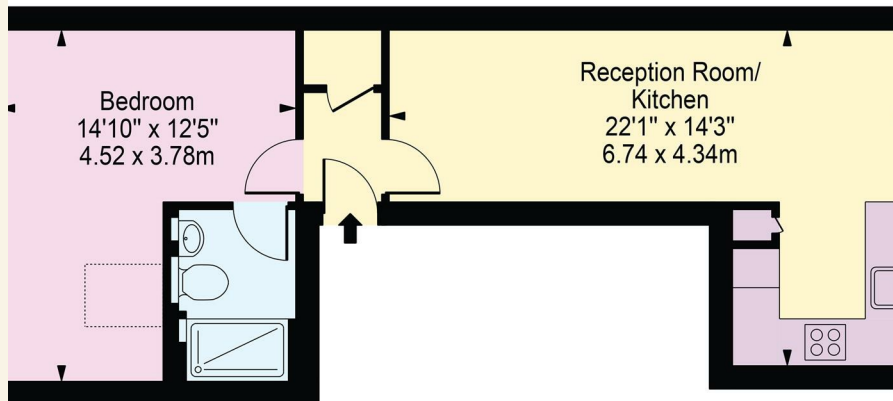

First Floor

For Illustration Purposes Only

This Floor Plan Should Be Used As A General Outline For Guidance Only And Does Not Constitute In Whole Or In Part An Offer Or Contract.
 Any Intending Purchaser Or Lessee Should Satisfy Themselves By Inspection, Searches, Enquiries And Full Survey As To The Correctness Of Each Statement.
 Any Areas, Measurements Or Distances Quoted Are Approximate And Should Not Be Used To Value A Property Or Be The Basis Of Any Sale Or Let.

owner occupiers or as high performing rental investments.

Shirland Mews is a quiet and picturesque enclave, ideally positioned moments from the amenities of Maida Vale and Warwick Avenue, with excellent transport links and the green open spaces of Paddington Recreation Ground nearby.

This rare offering presents a compelling opportunity to secure a fully refurbished, income generating, freehold asset in one of West London's most sought after residential locations.

*please note furniture has been digitally added

Shirland Mews
 Approx. Total Internal Area
 39.50 sq m / 425 sq ft
 (Including Restricted Height Area)

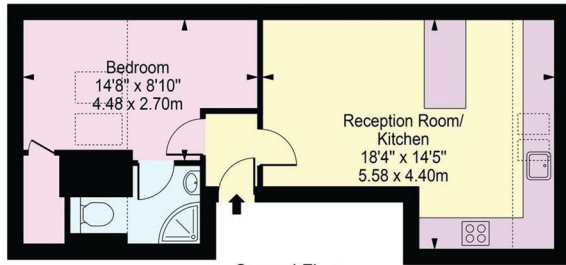

Second Floor

This Floor Plan Should Be Used As A General Guide For Customers Only And Does Not Constitute A Warranty Or Part Of An Offer Or Contract.
 Any Building Particulars Or Details Should Be Verified By Prospective Buyers/ Tenants/ Customers And Not Relied On As To The Correctness Of Such Statements.
 Any Area, Measurements Or Dimensions Given Are Approximate And Should Not Be Used To Value A Property Or Be The Basis Of Any Sale Or Let.

Shirland Mews
 Approx. Gross Internal Area
 54.77 sq m / 590 sq ft

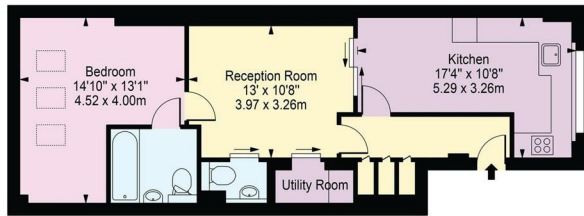

Ground Floor

This Floor Plan Should Be Used As A General Guide For Customers Only And Does Not Constitute A Warranty Or Part Of An Offer Or Contract.
 Any Building Particulars Or Details Should Be Verified By Prospective Buyers/ Tenants/ Customers And Not Relied On As To The Correctness Of Such Statements.
 Any Area, Measurements Or Dimensions Given Are Approximate And Should Not Be Used To Value A Property Or Be The Basis Of Any Sale Or Let.



Council Tax Band D EPC Rating C

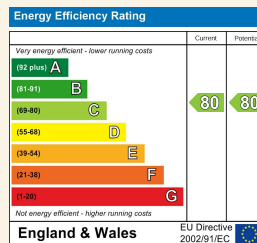

24 Bristol Gardens
 London
 W9 2JQ
 hello@draperlondon.com
 0203 143 1900