



Tarpan Walk, Westbury

£135,000



Key Features

- End of chain
- Allocated Parking
- Open Plan
- Dining space
- EPC rating C
- Leasehold





Smart, Stylish & Well-Connected

This end of chain flat is offered for sale in Westbury and is presented in good condition, appealing to both first-time buyers and investors.



The property provides an open-plan kitchen with dining space, built-in pantries and good natural light, leading to a separate reception room.



There are two double bedrooms and a well-appointed bathroom with bath, overhead shower, toilet and heated towel rail. The flat benefits from electric heating and parking, with an EPC rating of C and Council Tax Band B.

Located in Westbury, the property is well placed for local amenities, including nearby schools and parks. Westbury's town centre offers a range of shops, cafes and everyday services, while local green spaces provide opportunities for walking and leisure.

Public transport links are a key feature of the area. Westbury railway station offers regular services to Bath, Bristol, Salisbury and London Paddington. Typical journey times are around 25-30 minutes to Bath, 45-50 minutes to Bristol Temple Meads and approximately 1 hour 20 minutes to London Paddington, making the flat a practical option for commuters.

With its two double bedrooms, open-plan living and convenient location for transport, schools and parks, this flat represents a practical home or investment opportunity in Westbury.

Approx Gross Internal Area
56 sq m / 607 sq ft

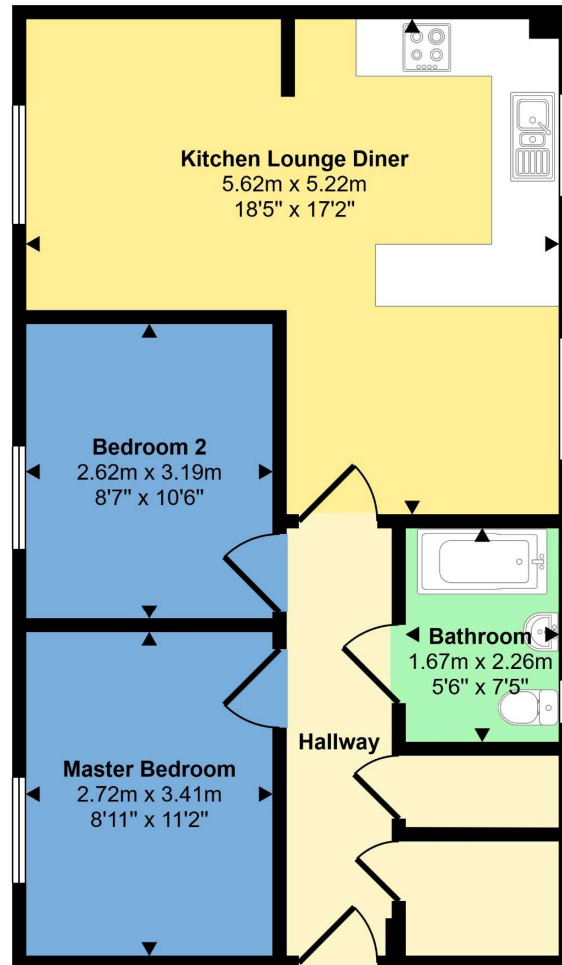

Floorplan

This floorplan is only for illustrative purposes and is not to scale. Measurements of rooms, doors, windows, and any items are approximate and no responsibility is taken for any error, omission or mis-statement. Icons of items such as bathroom suites are representations only and may not look like the real items. Made with Made Snappy 360.

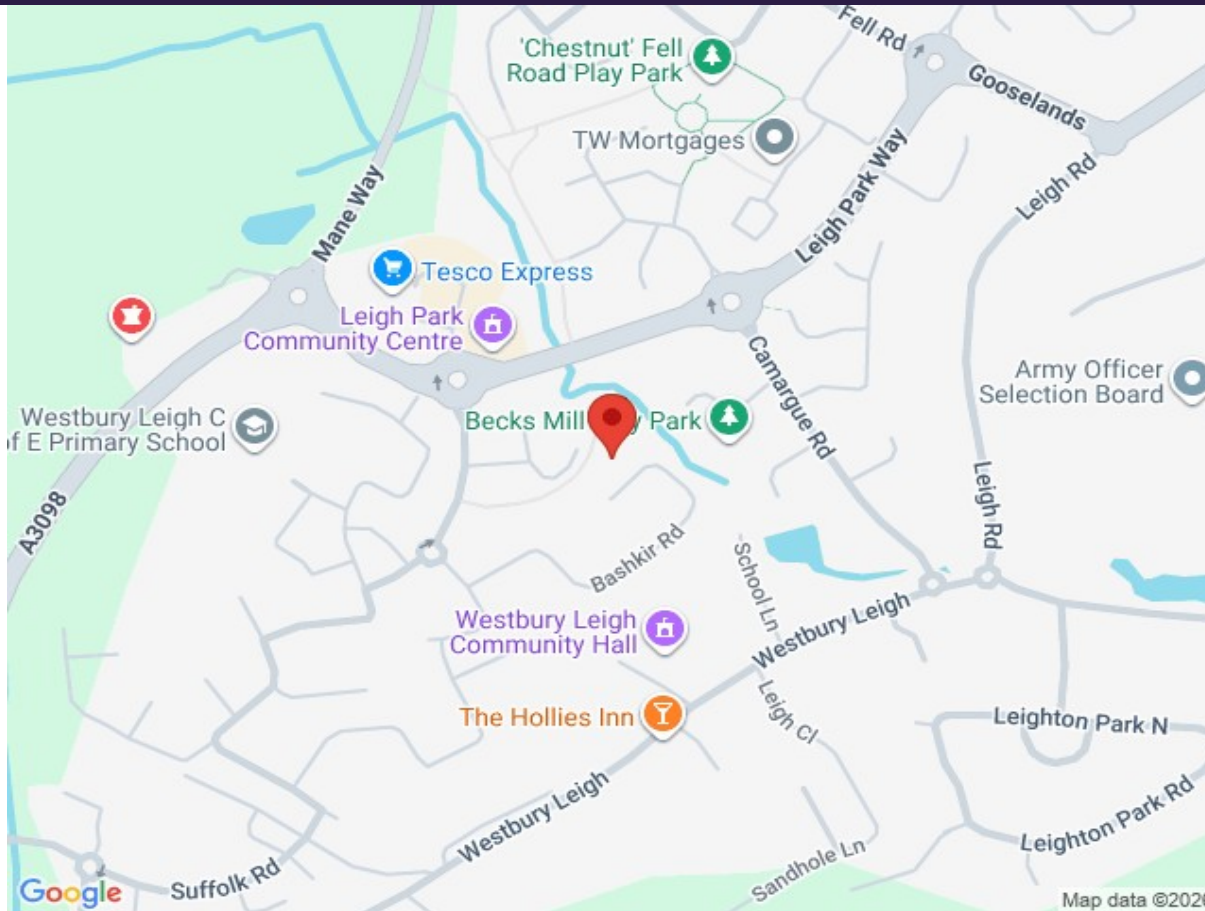

01985 220 290

warminster@northwooduk.com