



- Modernised Throughout
- 2 Double Bedrooms
- Close to Rustington Shops
- Ground Floor Cloakroom
- Gas Central Heating
- Viewing Recommended
- Available Immediately
- Council Tax Band 'C'
- EPC Rating 'E'

30 Arundel Garden, Rustington BN16 3EH

£1,400 pcm

Ground Floor

Approx. 36.8 sq. metres (396.1 sq. feet)



First Floor

Approx. 36.8 sq. metres (396.1 sq. feet)

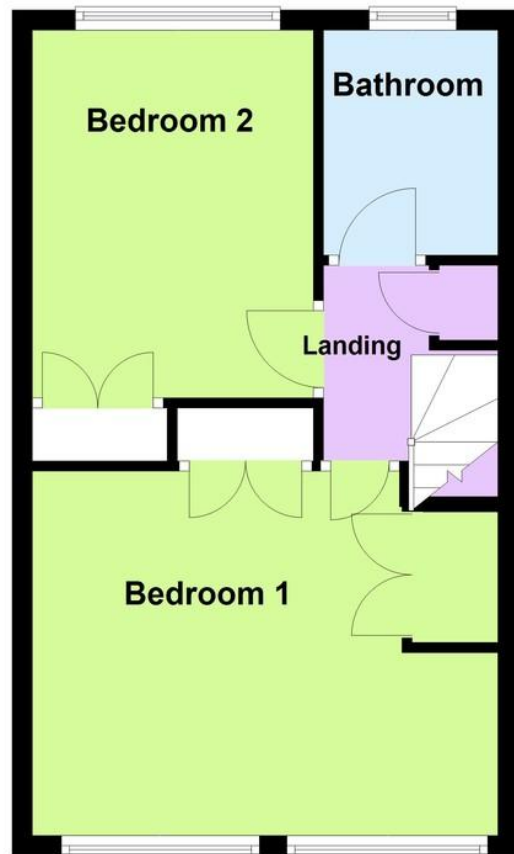

Total area: approx. 73.6 sq. metres (792.2 sq. feet)

AVAILABLE IMMEDIATELY. 2 bedroom house in the heart of Rustington, close to the shops. New kitchen, bathroom, cloakroom and gas central heating. Newly decorated throughout with new floor coverings. Internal viewing recommended to appreciate this lovely home.

ENTRANCE HALL

GROUND FLOOR CLOAKROOM

Newly refurbished

LOUNGE/DINING ROOM

26' 1" x 12' 6" (7.95m x 3.81m)

KITCHEN

9' 9" x 6' 7" (2.97m x 2.01m)

Newly refurbished

BEDROOM 1

15' 5" x 11' 10" (4.7m x 3.61m)

BEDROOM 2

11' 10" x 9' 2" (3.61m x 2.79m)

BATHROOM/WC

Newly refurbished

EASY TO MANAGE GARDEN

The information and measurements contained within these details are for guidance only and do not form part of any contract.



90 THE STREET, RUSTINGTON, WEST
SUSSEX, BN16 3NJ

lettings@hawkemetcalf.co.uk

www.hawkemetcalf.co.uk

01903 850450