

OVER 60?

Secure this property
for up to **59% less!**



Guide Price

£300,000

Freehold

3x  1x  1x 

Minster Road, Minster On Sea, Kent, ME12

Wards

Helping you move forwards



Main features

- This place is oozing potential and perfect to put your own stamp on
- Good size kitchen with breakfast bar area
- Fabulous size well maintained rear garden
- Large in and out driveway to the front and side
- Double doors leading out to the rear garden from the lounge

Accommodation

GROUND FLOOR

- Entrance Hall: 13'4 x 8'9 (4.07m x 2.67m)
- Inner Hallway
- Lounge: 19'5 x 13'1 (5.92m x 3.99m)
- Kitchen: 14'8 x 11'4 (4.47m x 3.46m)
- Bedroom 1: 11'9 up to fitted wardrobes x 10'0 (3.58m x 3.05m)
- Bedroom 2: 11'9 x 10'0 (3.58m x 3.05m)
- Bedroom 3: 9'3 x 8'1 (2.82m x 2.47m)
- Bathroom: 9'4 x 5'6 (2.85m x 1.68m)
- Separate Toilet: 5'5 x 2'7 (1.65m x 0.79m)

OUTSIDE

- Front Garden
- Front Driveway
- Garage
- Rear Garden

Ground Floor
Approx. 98.6 sq. metres (1061.8 sq. feet)

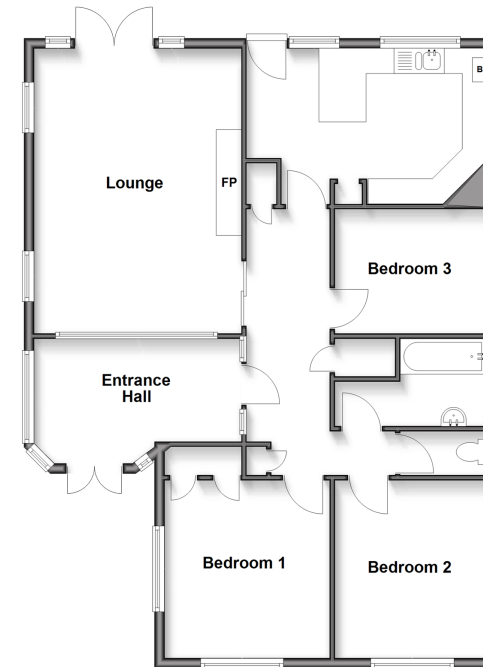

Call Sheerness - 01795 664651 ■ wardsofkent.co.uk

■ Legal advice should be taken to verify fixtures/fittings, planning, alterations and/or lease details
 ■ Through a Homewise Home For Life Plan people aged 60+ can secure this property for up to 50% less, by purchasing a Lifetime Lease.

■ Appliances & services are untested, dimensions are approximate and floor plans are not to scale



11635609/20250922/DS/MH