



Connells

Hillview Manor Park Winchester Road
Fair Oak Eastleigh



Property Description

Situated within the popular Hillview Manor Park in Fair Oak, this well-presented two-bedroom park home offers the perfect blend of peaceful rural living with the convenience of local amenities close by. Offered with no onward chain, the property has been enhanced with new external cladding and new carpets throughout, making it ready for immediate occupation.

The accommodation comprises a bright and spacious lounge featuring a charming bay window, creating a light and welcoming living space. The fitted kitchen comes complete with a range of white goods, providing practicality from day one.

There are two well-proportioned bedrooms, both benefiting from built-in wardrobes and dressing tables, offering excellent storage. The shower room is fitted with a modern walk-in shower for ease and convenience.

Externally, the property enjoys attractive side and rear gardens with a patio seating area, ideal for relaxing or entertaining, together with a useful garden shed.

A private driveway provides off-road parking, while additional visitor parking is available within the development.

Hillview Manor Park enjoys a desirable setting in Fair Oak, offering a peaceful lifestyle surrounded by countryside while remaining within easy reach of shops, transport links and everyday amenities.

This is an excellent opportunity for those seeking comfortable, low-maintenance living in a welcoming community.

Lounge

Double glazed bay window to front aspect. Double glazed window to side aspect. Double glazed door to side aspect. Radiator.

Kitchen

Windows to both side aspect. Radiator. Fitted kitchen with wall and base units. White goods included. Boiler.



Bedroom 1

Double glazed window to rear aspect.
Radiator. Built in wardrobe and dresser.

Bedroom 2

Double glazed window to side aspect.
Radiator. Built in wardrobe and dresser.

Bathroom

Double glazed window to side aspect. Walk in shower. Wash hand basin. Toilet. Radiator,

Outside

Stoned section with shrubs to the front.
Driveway and visitor parking.
To the rear storage units, artificial lawn and a bank with lawn and shrubs.

Agent Notes

New external cladding. New carpets.



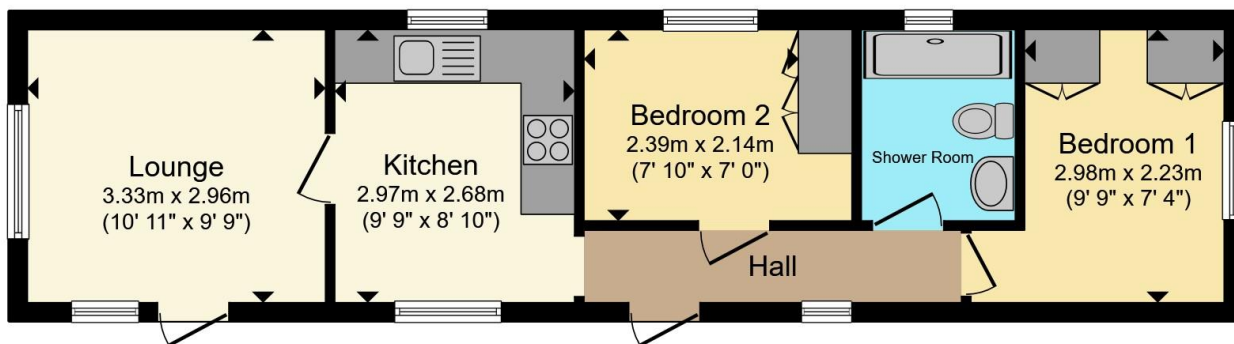

Total floor area 40.8 m² (439 sq.ft.) approx

This floor plan is for illustrative purposes only. It is not drawn to scale. Any measurements, floor areas (including any total floor area), openings and orientation are approximate. No details are guaranteed, they cannot be relied upon for any purpose and they do not form part of any agreement. No liability is taken for any error, omission or misstatement. A party must rely upon its own inspection(s). Powered by www.propertybox.io



To view this property please contact Connells on

T 02380 618 343
E eastleigh@connells.co.uk

19 Market Street
EASTLEIGH SO50 5RH

EPC Rating: Exempt
Council Tax Band: A

Tenure:

view this property online connells.co.uk/Property/EGH309603

We are currently awaiting Tenure details. For further information please contact the branch. Please note additional fees could be incurred for items such as leasehold packs.



1. MONEY LAUNDERING REGULATIONS Intending purchasers will be asked to produce identification documentation at a later stage and we would ask for your co-operation in order that there will be no delay in agreeing the sale. 2. These particulars do not constitute part or all of an offer or contract. 3. The measurements indicated are supplied for guidance only and as such must be considered incorrect. Potential buyers are advised to recheck measurements before committing to any expense. 4. We have not tested any apparatus, equipment, fixtures, fittings or services and it is in the buyers interest to check the working condition of any appliances.

Connells Residential is registered in England and Wales under company number 1489613, Registered Office is Cumbria House, 16-20 Hockliffe Street, Leighton Buzzard, Bedfordshire, LU7 1GN. VAT Registration Number is 500 2481 05.

See all our properties at www.connells.co.uk | www.rightmove.co.uk | www.zoopla.co.uk

Property Ref: EGH309603 - 0002