



**HENDERSON
CONNELLAN**
ESTATE AGENTS

19 Spey Close, Corby, Northamptonshire, NN17 2AS
£52,500

🛏️ 2 🚿 1 🚿 1



"A Shared Ownership Opportunity"

Purchase a 25% share of this well-presented semi-detached house for £52,500. Riverside Housing Association own the remaining 75% for which a subsidised rent is payable by the owner. The property is offered for sale with a well proportioned interior, enclosed rear garden and an allocated parking space. The accommodation comprises hall, guest WC, living room and a fitted kitchen/breakfast room. Upstairs, there is a family bathroom and two double bedrooms. A great opportunity to step onto the property market!

Description:

A modern deceptively sized terrace property which is being offered for sale with NO CHAIN.

The property is located off Rockingham Road and is conveniently situated for the local Aldi supermarket and Lloyds amenities.

The accommodation comprises entrance hall with stairs rising to the first floor landing.

The living room is front facing.

The kitchen/breakfast room is fitted with a range of wall and base level units with work surfaces incorporating a sink with drainer. There is a built in electric oven, gas hob and extractor hood. There is space and plumbing for a washing machine (appliance not included). A door opens onto the rear garden.

Guest WC.

From the first floor landing there are two double sized bedrooms and a bathroom which includes a side panel bath with shower over, WC and a pedestal wash hand basin with ceramic tiled wall surrounds.

Gas fired central heating system and uPVC double glazed windows.

The 75% apportioned rent to the housing association is £335.02 per month and there is a service charge £63.85 per month.

Outside:

This property comes with an allocated parking space while the rear garden is enclosed by timber fencing and has been landscaped for easy maintenance.



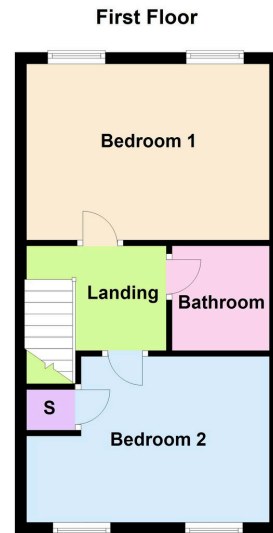
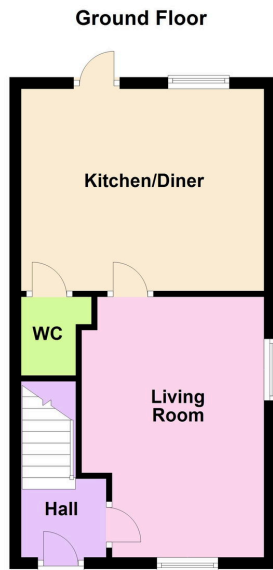

- Kitchen/Diner - 11' 6" x 13' 10" (3.50m x 4.21m)
- Living Room - 14' 10" x 10' 5" (max) (4.52m x 3.20m) (max)
- Guest WC - 3' 0" x 4' 6" (0.91m x 1.37m)
- Bedroom One - 13' 10" x 10' 0" (4.21m x 3.05m)
- Bedroom Two - 13' 10" x 9' 5" (max) (4.21m x 2.87m) (max)
- Bathroom - 5' 7" x 6' 0" (1.70m x 1.88m)



Disclaimer: These particulars do not form part of any offer or contract and should not be relied upon as statements or representations of fact. Any areas, measurements of distances are approximate. The text, photographs and plans are for guidance only and are not necessarily comprehensive.

10 Spencer Court, Corby,
Northamptonshire, NN17 1NU

