



UNEX TOWER, E15

£580,000

A contemporary two bedroom, two bathroom property available in the popular Unex Tower. This apartment features an open plan kitchen/living area with floor-to-ceiling windows the full length of the property for far reaching views, a winter garden, two double bedrooms, one of which is en suite, and a family bathroom.

- Two Double Bedrooms
- Two Bathrooms
- Gym
- Winter Garden
- 24 Hour Concierge
- Roof Terrace

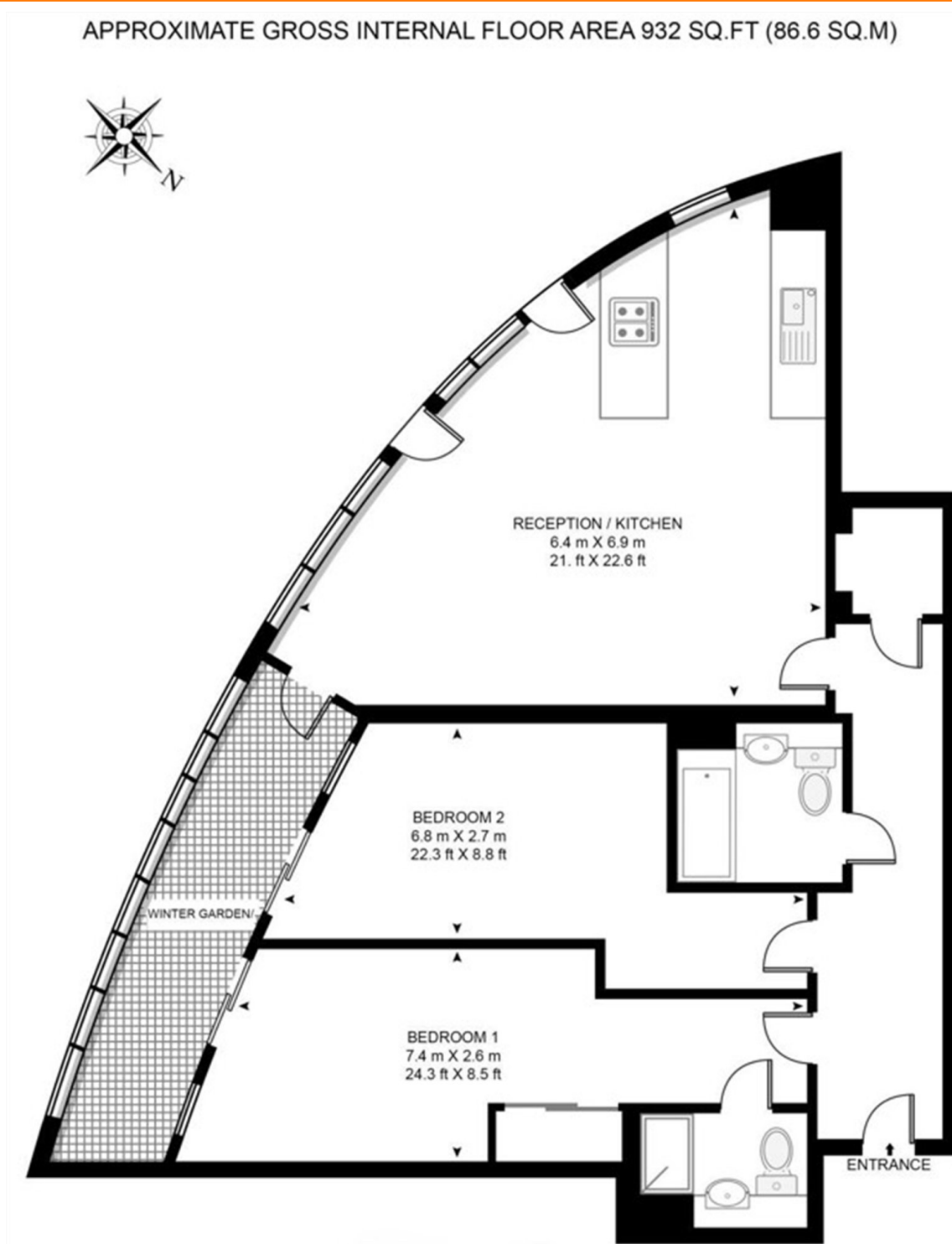

LiFE RESIDENTIAL

16 Royal Crest Avenue,
London, E16 2TQ
Sales: 020 3846 3332
Lettings: 020 3846 3311

Energy Rating: . We aim to make our particulars both accurate and reliable. However they are not guaranteed; nor do they form part of an offer or contract. If you require clarification on any points then please contact us, especially if you're traveling some distance to view. Please note that appliances and heating systems have not been tested and therefore no warranties can be given as to their good working order.