

12 Centenary Way, Bovey Tracey - TQ13 9GY

£315,000 Freehold

Well-presented three-bedroom home with spacious open-plan living, en-suite to the principal bedroom, enclosed rear garden, garage and driveway parking, ideally located in sought-after Bovey Tracey.

chamberlains
the key to your home

Contact Us...

 01626 818094

 boveysales@chamberlains.co

 50 Fore Street
Bovey Tracey TQ13 9AE

ROOM MEASUREMENTS:

Living/ dining room: 17'4" x 15'8" (5.29m x 4.77m)

Kitchen: 9'3" x 8'1" (2.82m x 2.46m)

Bedroom: 12'10" x 10'7" (3.91m x 3.22m)

Ensuite: 6'9" x 5'1" (2.05m x 1.55m)

Bedroom: 10'5" x 8'10" (3.17m x 2.70m)

Bedroom: 10'5" x 6'5" (3.17m x 1.95m)

Bathroom: 6'11" x 6'3" (2.10m x 1.90m)

Garage: 18'1" x 8'10" (5.52m x 2.70m)

USEFUL INFORMATION:

Tenure: freehold

Council Tax Band: C (£2352.93 p.a 2026/27)

EPC rating: C

Local Authority: Teignbridge District Council

Services: Mains water, drainage & electricity.

Heating: Gas Central Heating.

AGENTS INSIGHT:

"This is a fantastic home for first-time buyers, professionals or those looking to downsize without compromising on space. The open-plan living area creates a sociable and welcoming environment, while the generous principal bedroom with en-suite adds a real sense of comfort. Outside, the enclosed rear garden provides a private space to relax, and the garage and driveway offer the practicality that is often sought after. Situated in the popular town of Bovey Tracey, the property enjoys easy access to local amenities, schools and the beautiful surroundings of Dartmoor."



STEP OUTSIDE:

Stepping out through the patio doors, you are welcomed into the south-facing rear garden, which is predominantly laid to lawn and complemented by a paved patio area directly outside the property. The garden is enclosed by timber fencing, offering a good degree of privacy, with a side gate providing access to a shared pedestrian passage between the neighbouring properties that leads to the front of the house. To the front of the property is a single driveway providing off-road parking directly in front of the garage, accompanied by a neatly maintained frontage.



LOCATION:

This property is positioned in a small and quiet residential development, within easy access to the town centre. Known as the "Gateway to the Moors", Bovey Tracey offers a comprehensive range of shops and amenities including a health centre, library, primary school, inns and churches. The town also benefits from good sporting facilities, including a swimming pool, a sports field/ tennis courts, a whisky distillery and art galleries plus the many cycle routes including Newton Abbot, Lustleigh and Moretonhampstead. The A38 dual carriageway, linking Exeter and Plymouth to the M5 motorway is within two miles of the town and there are mainline railway stations at Newton Abbot and Exeter. The open spaces of Dartmoor lie just to the west of the town and the South Devon beaches are mostly within 30 mins driving distance.



STEP INSIDE:

Stepping through the front door, you are welcomed into the entrance hallway, with a convenient ground floor WC positioned immediately to the right. A door directly ahead leads into the main living accommodation, which has been thoughtfully designed to provide predominantly open-plan living, with the kitchen set slightly apart from the lounge and dining area. The living and dining space is generously proportioned and benefits from an understairs storage cupboard, ideal for coats, shoes and household items. Patio doors provide plenty of natural light and open directly onto the rear garden, creating an excellent connection between the indoor and outdoor spaces. The kitchen is well equipped with a range of integrated appliances, including a fridge freezer, dishwasher, washing machine, and an oven with hob. To the first floor are three well-proportioned bedrooms, the principal bedroom offers ample space for a full range of bedroom furniture and benefits from its own en-suite shower room. The second bedroom is another good size double bedroom that overlooks the rear of the property and flooded with natural light. The third bedroom is the single bedroom which is currently used as a home office. Completing the first floor is the family bathroom, fitted with a panelled bath incorporating a shower over, a WC and a wash hand basin. The loft space has been professionally boarded which gives good additional storage if required along with a ladder and lighting.



Ground Floor
53.5 sq.m. (576 sq.ft.) approx.

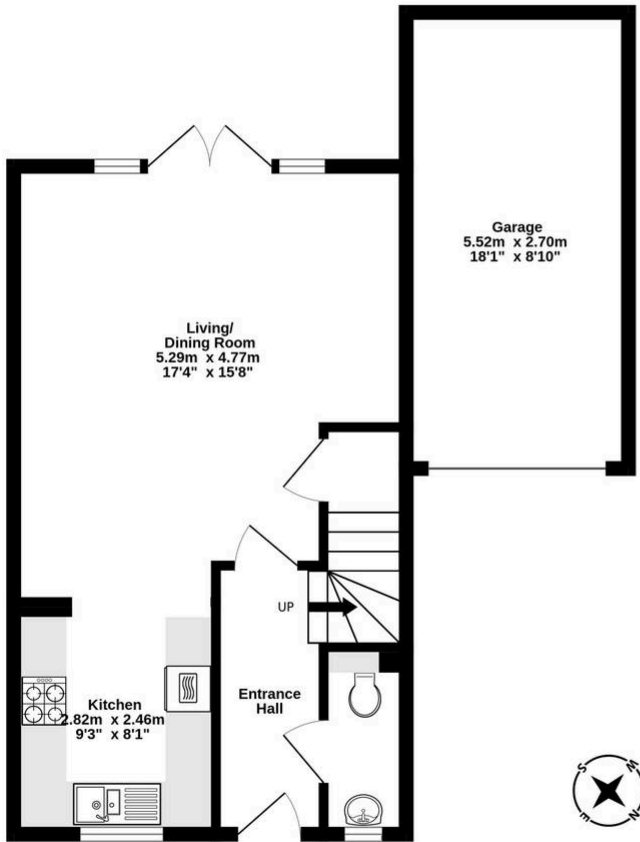

1st Floor
38.2 sq.m. (411 sq.ft.) approx.

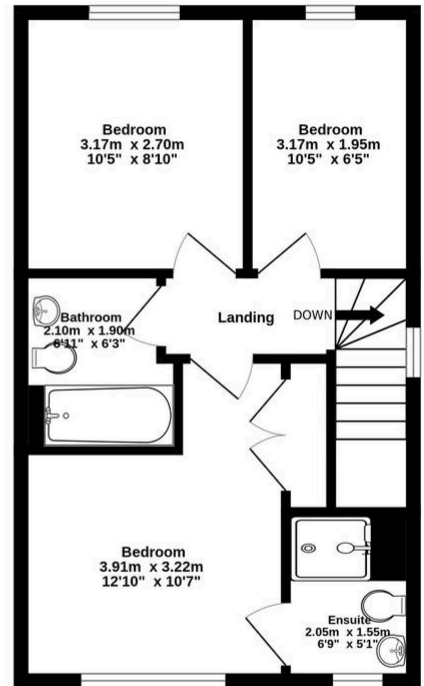

TOTAL FLOOR AREA : 91.7 sq.m. (987 sq.ft.) approx.

Whilst every attempt has been made to ensure the accuracy of the floorplan contained here, measurements of doors, windows, rooms and any other items are approximate and no responsibility is taken for any error, omission or mis-statement. This plan is for illustrative purposes only and should be used as such by any prospective purchaser. The services, systems and appliances shown have not been tested and no guarantee as to their operability or efficiency can be given.
Made with Metropix ©2026

