

The Davenham

3 bedroom detached home with garage.

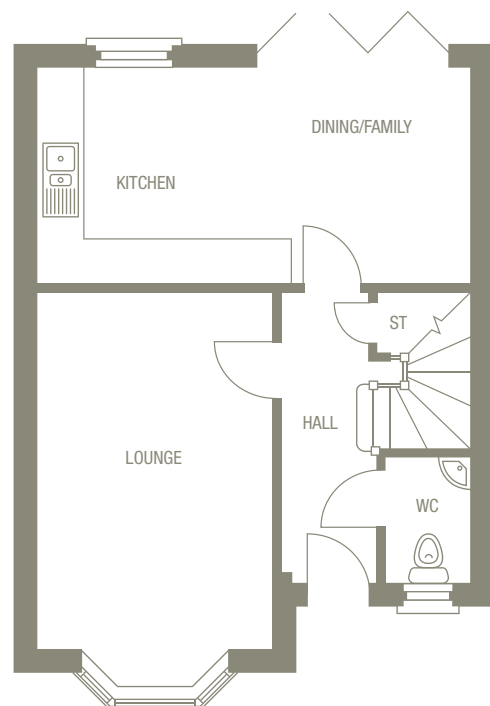

Classic architecture and contemporary style create the perfect combination in the Davenham. With a generous lounge and an open-plan kitchen/dining/family room leading out to the garden, this is a home designed for easy living. The master bedroom has a private ensuite while the 2 further bedrooms share a sleek and stylish family bathroom.



Ground Floor		
Room	Size	
Lounge	3150 x 5310*mm	10'4" x 17'5"**
Kitchen/Dining/Family	5825 x 2890mm	19'1" x 9'6"
Cloaks/WC	1150 x 1700mm	3'9" x 5'7"

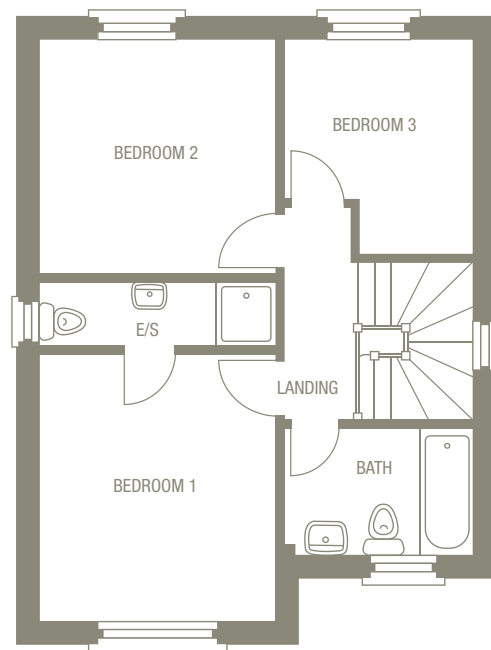

First Floor		
Room	Size	
Bedroom 1	3150 x 3585mm	10'4" x 11'9"
En-suite	3150 x 895mm	10'4" x 2'11"
Bedroom 2	3150 x 3205mm	10'4" x 10'6"
Bedroom 3	2585* x 2950*mm	8'5"* x 9'8"**
Bathroom	2585 x 1700mm	8'5" x 5'7"

957 total sq ft

*Denotes maximum room dimensions.
This is a computer generated image of The Davenham, elevation treatment may vary. All internal images are indicative of a Morris house type. Room sizes are approximate. Plots may be handed and any garages may be single or double. Kitchen and bathroom layouts are indicative. These plans are correct at time of going to press, but may be subject to change during construction. Please ensure that you check for specific plot details.

