

HENDERSON CONNELLAN

ESTATE AGENTS



West Furlong, Kettering NN15

"Expansive Level Living"

"Expansive Level Living"

This beautifully presented two-bedroom detached bungalow in an ultra-desirable location offers an exceptional opportunity for spacious and versatile level living, thoughtfully designed for comfort and modern lifestyles. The heart of the home is a superb open-plan kitchen/breakfast/family room, extensively fitted with a range of units and work surfaces, complemented by French doors leading to the garden. Further generous reception spaces include a bright living room with French doors to the garden and a substantial dining room with an electric fireplace. Enjoy two well-proportioned double bedrooms, two with fitted wardrobes, and the main bedroom featuring an ensuite with a walk-in shower. A contemporary family bathroom with a bath and shower screen serves the remaining rooms. Outside, a block-paved driveway provides off-road parking for multiple vehicles leading to a single garage, while the expertly maintained private rear garden boasts a natural stone patio, neatly laid lawn, and mature planted borders, creating a serene outdoor sanctuary. This superb home combines practical features with elegant design, offering an ideal setting for relaxed living.

Living Room - 4.8m x 3.81m (15'9" x 12'6")

Dining Room - 4.85m x 3.63m (15'11" x 11'11")

Kitchen/Breakfast/Family Room - 6.68m x 3.58m (21'11" x 11'9")

Ensuite - 2.62m x 1.88m (8'7" x 6'2")

Bedroom One - 4.22m x 3.33m (13'10" x 10'11")

Bedroom Two - 3.51m x 3.51m (11'6" x 11'6")

Bathroom - 2.62m x 2.11m (8'7" x 6'11")

- Offered With NO CHAIN
- Extended Accommodation
- Beautifully Kept Inside and Out
- En-Suite
- Off Road Parking with Garage
- Ultra-Desirable Location
- Stunning Gardens
- Versatile Layout Options
- EPC RATING: D
- COUNCIL TAX: D

Council Tax Band: D

Tenure: Freehold





Ground Floor

Approx. 109.7 sq. metres (1180.7 sq. feet)

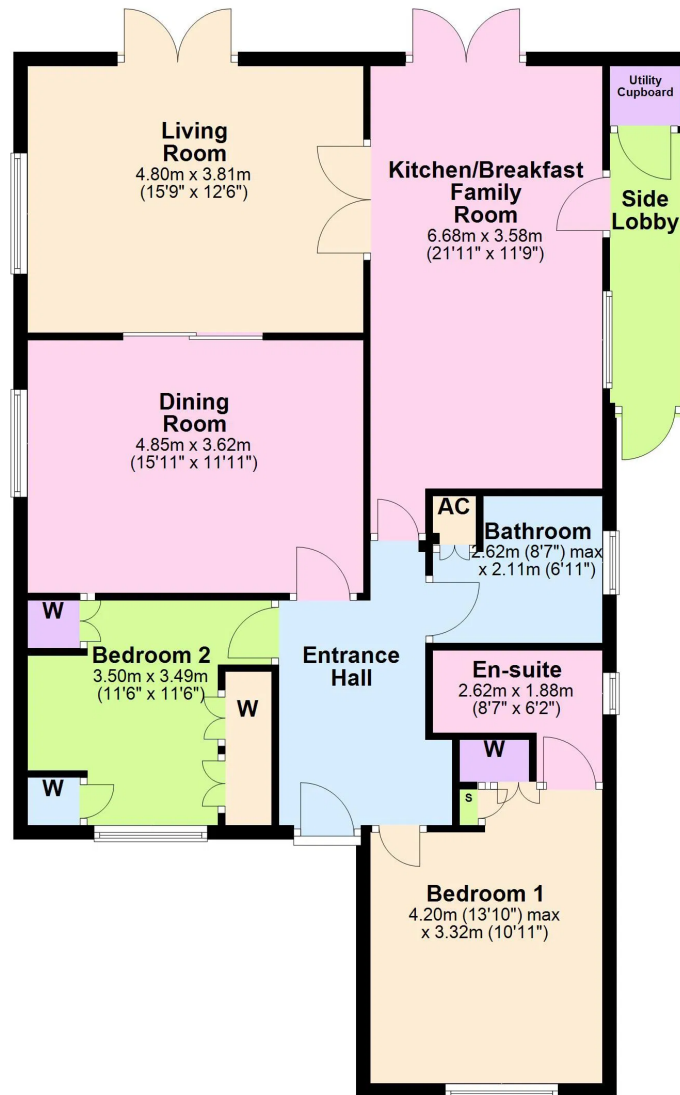

Total area: approx. 109.7 sq. metres (1180.7 sq. feet)