



Coates Road, Whittlesey Peterborough
Offers In Region Of £475,000 Freehold

**Sharman
Quinney**

Key Features



- Five bedroom detached chalet bungalow
- Possible annex
- Two large reception rooms
- UPVc conservatory
- Four-piece bathroom and shower room
- Off road parking for several vehicles
- Tandem garage
- Approximately ¼ acre plot

Entrance hallway 2.4m x 4.76m (7'9" x 15'6")

Bedroom one 3.62m x 3.6m (11'9" x 11'8")
maximum into recess

Bedroom two 3.66m x 3.6m (12' x 11'8")
maximum including wardrobes

Family bathroom 4.38m x 2.11m (14'4" x 6'9")
maximum into recess



Inner hallway Understairs cupboard

Kitchen/breakfast room 3.28m x 4.21m (10'8" x 13'8")

Lobby Door leading outside

Living/dining room 7.58m x 3.41m (24'9" x 11'2")
maximum into recess

Inner hallway

Bedroom three 3.39m x 4.03m (11'1" x 13'2")
maximum including wardrobes

Shower room 2.25m x 2.44m (7'4" x 8') maximum
into recess

Lounge 4.8m x 4.02m (15'7" x 13'2")

Conservatory 3.62m x 4.05m (11'9" x 13'3")

Utility room

First floor landing Storage eaves

Bedroom four 2.77m x 3.14m (9'1" x 10'3")

Bedroom five 3.56m x 2.21m (11'7" x 7'3")

WC





Ground Floor

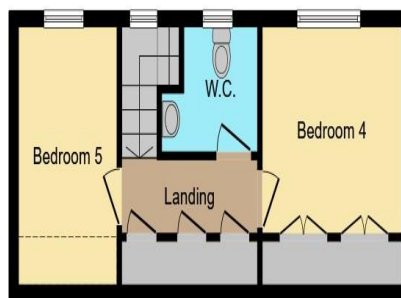

First Floor

Outside: Mostly laid to gravel to the front offering off road parking for several vehicles leading to the tandem length garage. Mature hedging to the front with a variety of flowers and shrubs. Large secluded rear garden laid to lawn with a large paved patio area and a variety of conifers, flowers and ornamental shrubs. Also has a large vegetable garden to the rear.

This floor plan is for illustrative purposes only. It is not drawn to scale. Any measurements, floor areas (including any total floor area), openings and orientation are approximate. No details are guaranteed, they cannot be relied upon for any purpose and they do not form part of any agreement. No liability is taken for any error, omission or misstatement. A party must rely upon its own inspection(s). Powered by www.focalagent.com

To view this property call Sharman Quinney on:
01733 205000

Selling your property?

Contact us to arrange a **FREE** home valuation.

 01733 205000

 46a Market Street, Whittlesey, PETERBOROUGH,
Cambridgeshire, PE7 1BD

 whittlesey@sharmanquinney.co.uk

 www.sharmanquinney.co.uk



 SCAN ME



Sharman Quinney Holdings Limited is registered in England and Wales under company number 4174227, Registered Office is Cumbria House, 16-20 Hockliffe Street, Leighton Buzzard, Bedfordshire, LU7 1GN. VAT Registration Number is 500 2481 05.

1: These particulars do not constitute part or all of an offer or contract. 2: The measurements indicated are supplied for guidance only and as such must be considered incorrect. 3: Potential buyers are advised to recheck the measurements before committing to any expense. 4: Sharman Quinney has not tested any apparatus, equipment, fixtures, fittings or services and it is the buyers interests to check the working condition of any appliances. 5: Sharman Quinney has not sought to verify the legal title of the property and buyers must obtain verification from their legal representative. 6: Intending purchasers will be asked to produce identification documentation at a later stage and we would ask your co-operation in order that there will be no delay in agreeing the sale. Ref: WHT204707 – 0005 - DDM

