



Chiswick High Road, W4 £400,000

A well-presented, centrally located one bedroom apartment offered with a share of freehold, loft storage and no onward chain - ideal as a first-time purchase or investment.

The apartment is close to Turnham Green and Chiswick Park stations (District line), with a wide range of shops, cafés and restaurants nearby. There is also easy access to the A4/M4.

Features

- Top Floor
- Period Conversion
- One Double Bedroom
- Share Of Freehold
- Ample Storage
- No Onward Chain

Chiswick High Road,
London, W4

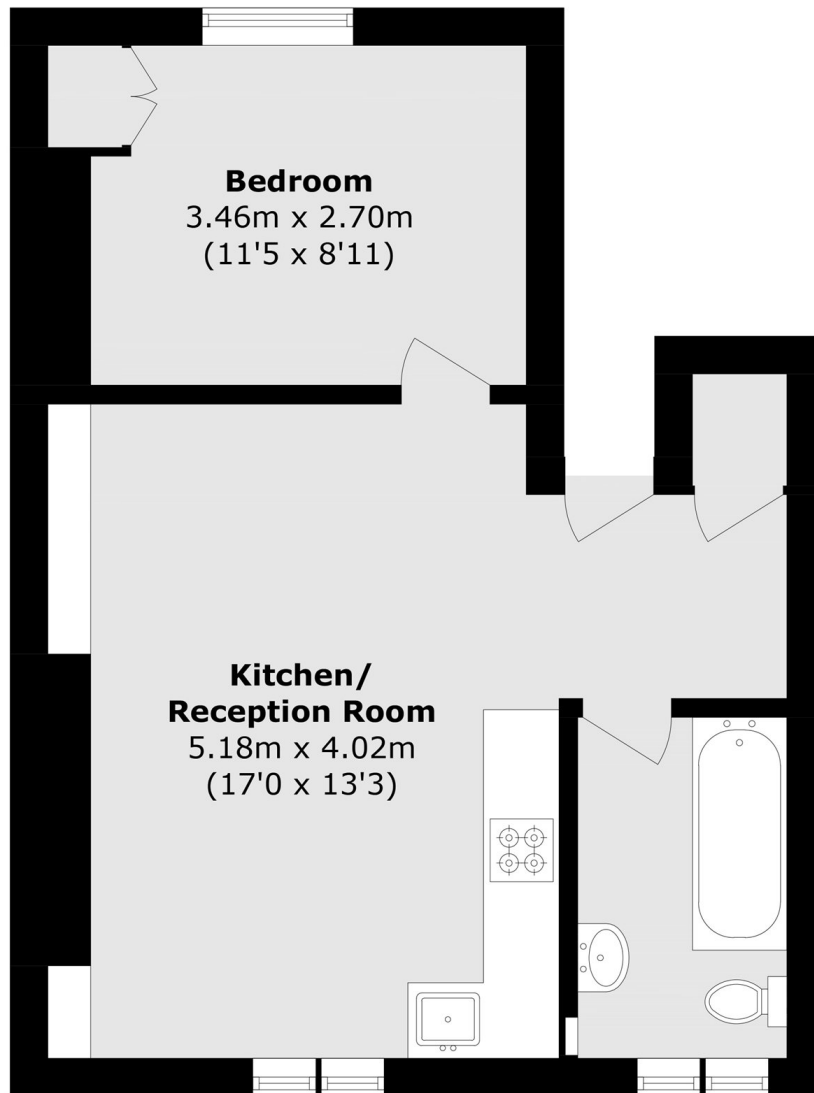

Total area (approx.): 40.6 sq. m (437.0 sq. ft)

Dexters

Chiswick
388 Chiswick High Road
London
W4 5TF
Sales
020 8995 4321

Energy Rating: C. We aim to make our particulars both accurate and reliable. However they are not guaranteed; nor do they form part of an offer or contract. If you require clarification on any points then please contact us, especially if you're traveling some distance to view. Please note that appliances and heating systems have not been tested and therefore no warranties can be given as to their good working order.

 **RICS** | Regulated
Estate Agent
and Letting Agent

dexters.co.uk