

## Beaumont Crescent, W14

£2,500 Per calendar month

A fabulous, spacious raised ground floor apartment offering wooden flooring- living room, two good size bedrooms with storage and entertaining contemporary lounge with open plan kitchen.

Beaumont Crescent is conveniently located with 200 yards to West Kensington underground station, local shops and the A4 for easy access into and out of central London.

### Features

- Two Bedrooms
- Raised Ground Floor
- Red Brick Building
- Close To Tube
- Wooden Floor
- Good Storage

# Beaumont Crescent, London, W14

Raised Ground Floor

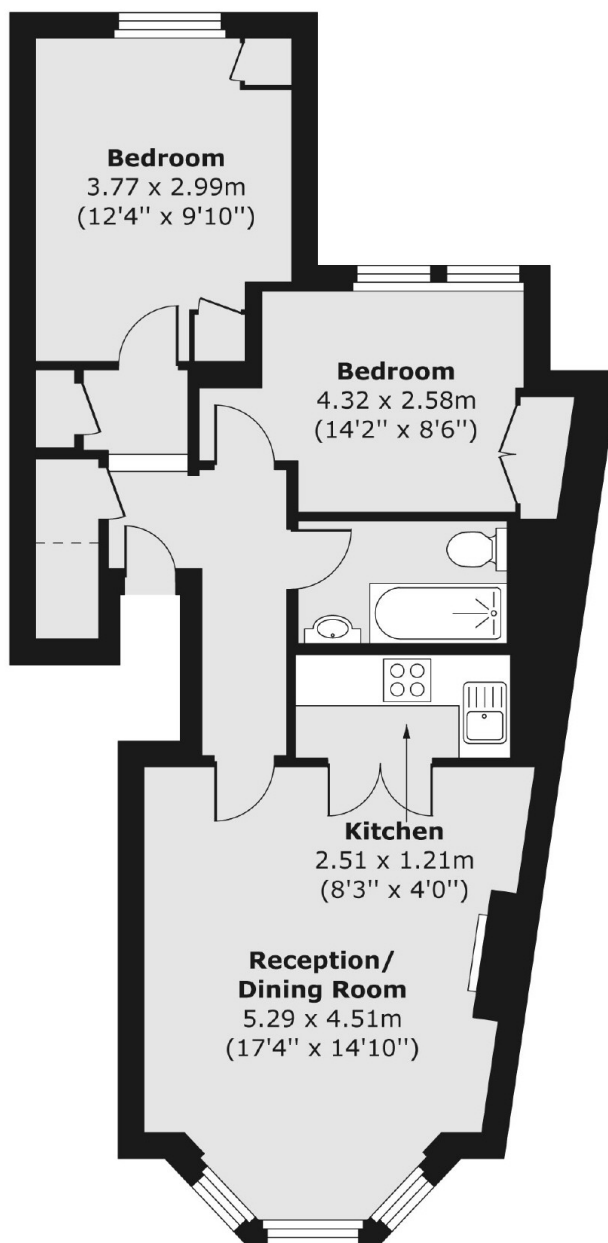

Total area (approx.) 58.14 sq. m (626 sq. ft)