



32 Bengrove
Milton Keynes, MK12 5SG



William Coulson
Partnered With
Simpsons
Property Experts

Attention First Time Buyers and Downsizers!

Situated within the ever-popular Wolverton Mill, this impressive three bedroom property offers room to grow with its generous proportions throughout, open plan kitchen/diner, pretty rear garden and off road parking!

Conveniently located within close proximity to local amenities, local schools and the train station are also within walking distance.

Entrance through the composite front door leading into the inviting entrance hall with access to the bright and airy living room and stairs rising to the first floor.

Spacious and naturally lit living room is ideal for both relaxing and entertaining, and offers ample space for a large sofa.

The stylish kitchen comprises an array of eye and base-level units, a laminate work surface, a stainless-steel sink with mixer tap and draining board, an electric oven, gas hob, dishwasher, fridge/freezer, and washing machine. There is also double glazed French doors to the rear aspect offering access to the rear garden.

Guest WC with wood effect vinyl flooring and a white two-piece suite.

The first floor offers three generously proportioned bedrooms with one and two benefitting from being double in size. The master also boasts an ensuite which includes a walk in shower, low level WC and wash hand basin. The modern main bathroom services the two other bedrooms and gives the additional option of a bath.

Outside provides a well sized rear garden laid mainly to lawn with a patio area and is enclosed by wood panel fencing. There is off road parking for two vehicles to the front aspect.

£360,000

 3  2  1



GROUND FLOOR

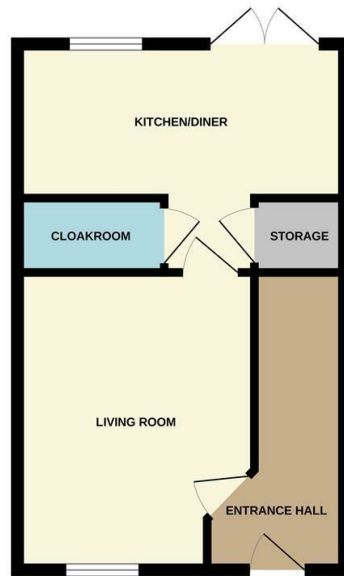

1ST FLOOR



Whilst every attempt has been made to ensure the accuracy of the floor plan contained here, measurements of doors, windows, rooms and any other items are approximate and no responsibility is taken for any error, omission, or mis-statement. The plan is copyright to Simpson and Partners and is for illustrative purposes and should only be used as such by any prospective purchaser. The services, systems and appliances shown have not been tested and no guarantee as to their operability can be given.
Made with Metreapp C2024

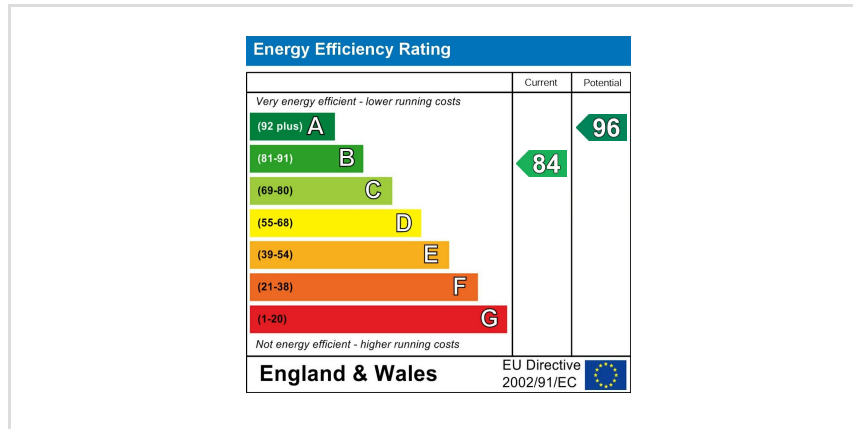



William Coulson
Partnered With

Simpsons
Property Experts

Tel: 01908 040289

Email: william.coulson@simpsonspropertyexperts.co.uk

Web: <https://simpsonspropertyexperts.co.uk/our-locations/milton-keynes>

