

RAINBOW REID

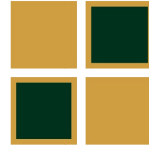

ESTATE AGENTS || LETTING AGENTS || PROPERTY MANAGEMENT



48B Frimley High Street , Frimley, GU16 7JF

Newly constructed two bedroom flat on Frimley High street, located close to all the local shops and transport links in Frimley.

The flat is located on the second floor (above shops with rear access) and comprises: spacious open plan living/dining with brand new kitchen and appliances, two good size bedrooms and a full bathroom.

Parking is available on a first come first serve basis (subject to additional charges)

The property is perfectly located near to Frimley train station, Frimley Park Hospital and has easy access to the A331 and M3.

The property is available Now, Unfurnished.

£1,400 Per Month

48B Frimley High Street

, Frimley, GU16 7JF



[Directions](#)



Floor Plan

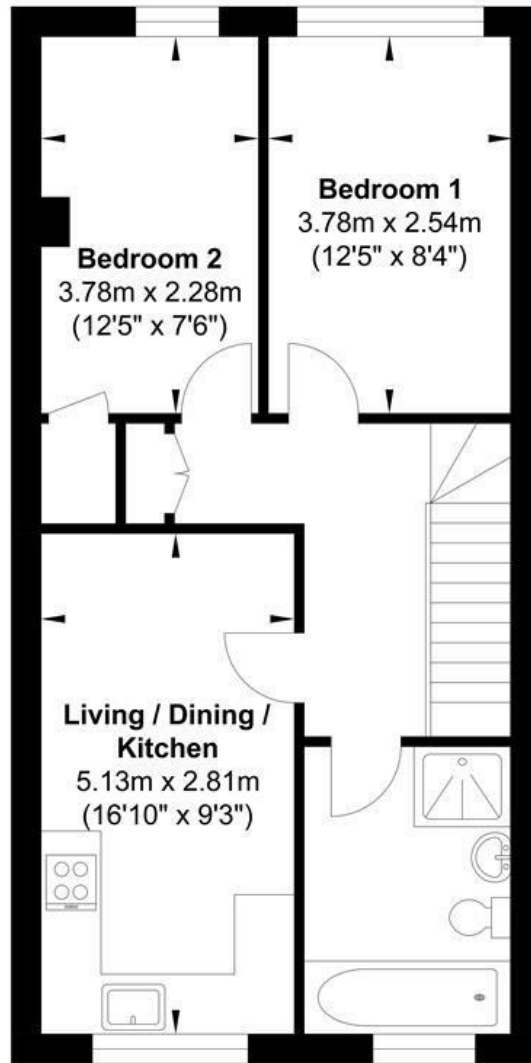

First Floor

Gross Internal Floor Area : 47.13 m2 ... 507.30 ft2

Whilst every attempt has been made to ensure the accuracy of the floor plan contained here, measurements of doors, windows, rooms and any other items are approximate and no responsibility is taken for any error, omission, or mis-statement. This plan is for illustrative purposes only and should be used as such by any prospective purchaser. The services, systems and appliances shown have not been tested and no guarantee as to their operability or efficiency can be given.

These particulars, whilst believed to be accurate are set out as a general outline only for guidance and do not constitute any part of an offer or contract. Intending purchasers should not rely on them as statements of representation of fact, but must satisfy themselves by inspection or otherwise as to their accuracy. No person in this firm's employment has the authority to make or give any representation or warranty in respect of the property.

