

11 Kirklandneuk Road, Renfrew, Renfrewshire, PA4 9BN

Offers Over £67,995

EPC Rating: C Council Tax Band: A



PEACHTREE
PROPERTY



Peachtree Property are delighted to welcome to the market this stunning one bedroom flat nestled on the charming Kirklandneuk Road in Renfrew, Renfrewshire, this delightful apartment offers a perfect blend of comfort and convenience. With one well-proportioned bedroom, this property is ideal for individuals or couples seeking a cosy living space. The apartment features a welcoming reception room, providing a warm atmosphere for relaxation or entertaining guests.

The bathroom is thoughtfully designed, ensuring both functionality and style. The layout is designed to maximise space and comfort, making it a practical choice for modern living.

Situated in a desirable area, residents will benefit from easy access to local amenities, including shops, parks, and transport links, making daily life both convenient and enjoyable. This apartment presents an excellent opportunity for those looking to establish themselves in a vibrant community.

Whether you are a first-time buyer or seeking a rental opportunity, this property on Kirklandneuk Road is worth considering. Embrace the chance to make this charming apartment your new home.



28 Hairst Street Hairst St
 Renfrew
 PA4 8QY
 0141 577 1111
 info@peachtreeproperty.co.uk

Approx Gross Internal Area
 53 sq m / 570 sq ft

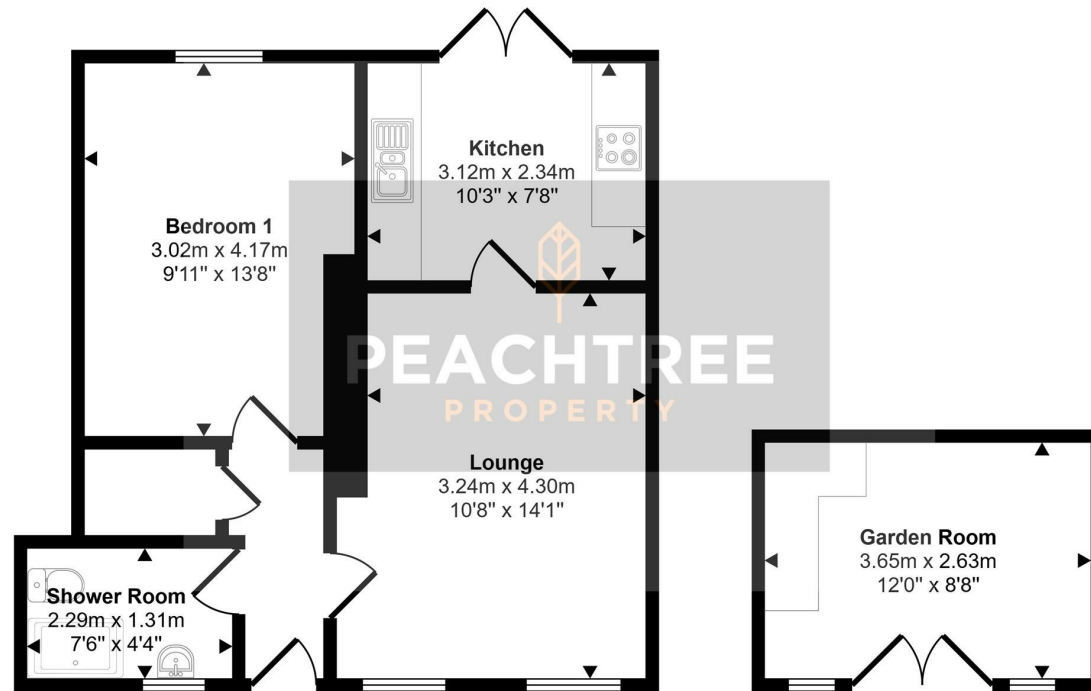

Floorplan
 Approx 43 sq m / 466 sq ft

Garden Room
 Approx 10 sq m / 103 sq ft

This floorplan is only for illustrative purposes and is not to scale. Measurements of rooms, doors, windows, and any items are approximate and no responsibility is taken for any error, omission or mis-statement. Icons of items such as bathroom suites are representations only and may not look like the real items. Made with Made Snappy 360.

| Energy Efficiency Rating | | Current | Potential |
|---|--|-------------------------|-----------|
| Very energy efficient - lower running costs | | | |
| (92 plus) A | | | |
| (81-91) B | | | |
| (69-80) C | | | |
| (55-68) D | | 73 | 76 |
| (39-54) E | | | |
| (21-38) F | | | |
| (1-20) G | | | |
| Not energy efficient - higher running costs | | | |
| Scotland | | EU Directive 2002/91/EC | |