

Parr Bridge Pastures, Tyldesley, M29 8SF
£1,295 PCM

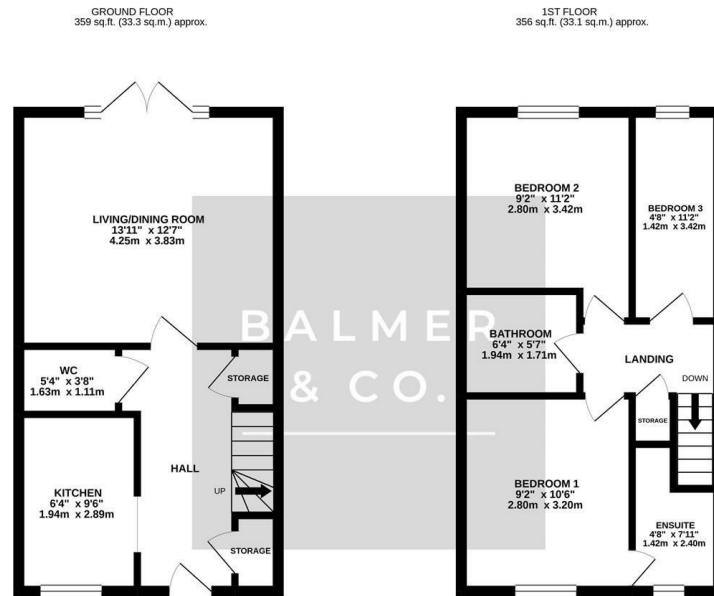

BALMER & CO are delighted to offer TO RENT this modern three bedroom property located on the popular Garret Meadows development by Redrow, offered FURNISHED/PART FURNISHED. Ground floor accommodation comprises in brief, entrance hall with downstairs cloakroom, modern fitted kitchen with integrated appliances and white goods, and sitting room with French doors opening to the rear gardens. To the first floor are three well proportioned bedrooms, master with en-suite shower room, and further bathroom. Outside are landscaped rear gardens with driveway to front providing off road parking.

Floor Plan



BALMER & CO.
SALES & LETTINGS

TOTAL FLOOR AREA: 714 sq.ft. (66.4 sq.m.) approx.
 While every attempt has been made to ensure the accuracy of the floorplan contained herein, measurements of doors, windows, rooms and any other items are approximate and no responsibility is taken for any error, omission or risk statement. This plan is for illustrative purposes only and should be used as such by any prospective purchaser. The services, systems and appliances shown have not been tested and no guarantee as to their operability or efficiency can be given.
 Made with Hergo 02022



Area Map

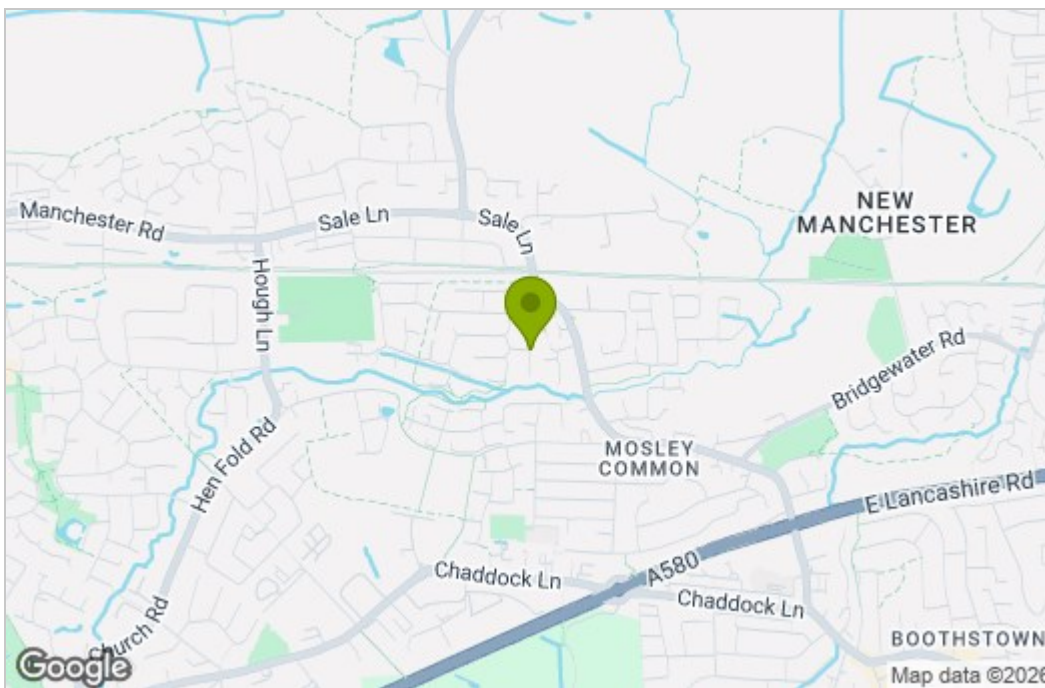

Energy Efficiency Graph

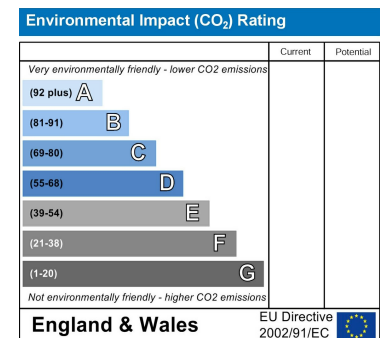
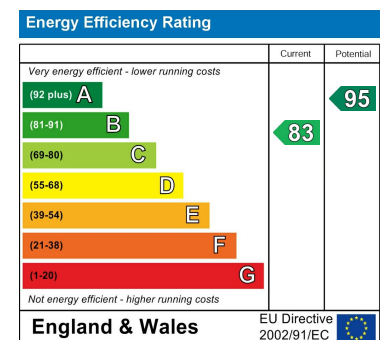

These particulars, whilst believed to be accurate are set out as a general outline only for guidance and do not constitute any part of an offer or contract. Intending purchasers should not rely on them as statements of representation of fact, but must satisfy themselves by inspection or otherwise as to their accuracy. No person in this firm's employment has the authority to make or give any representation or warranty in respect of the property.