

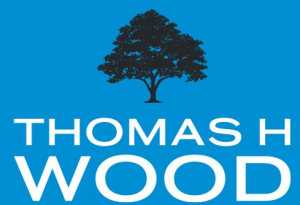

Wyncliffe Gardens,
Pentwyn, Cardiff,
CF23 7FD



PCM
£800 PCM

1 Bedrooms
Apartment

A super one bedroom modern apartment on the first floor of this well maintained development in Pentwyn/Pontprenau. This immaculate property has been exceptionally well appointed and decorated and is conveniently located for Waitrose/Lidl supermarkets, major road networks M4 and A48 as well as UHW. UNFURNISHED with kitchen appliances. Off road parking bay. Electric heating. EPC Rating B. Council Tax band C. Available June 2026 for initial minimum term of twelve months.

Features

- Exceptional First Floor Apartment/Modern Development
- One Double Bedroom/Large Open Plan Living Room/Kitchen
- Immaculately Presented
- UNFURNISHED with Kitchen Appliances
- Super Location Near Supermarkets/M4/UHW
- Council Tax Band C/EPC Rating B
- Off Road Parking Bay
- Electric Heating
- Available June 2026/Minimum Twelve Month Term



Information

- Tenure:
- Council Tax Band: C
- Floor Area: 503.40 sq ft
- Current EPC Rating: B
- Potential EPC Rating: B



1 BEDROOMS



1 BATHROOMS



1 RECEPTION ROOMS



ENERGY RATING: B

Ground Floor

Approx. 503.4 sq. feet

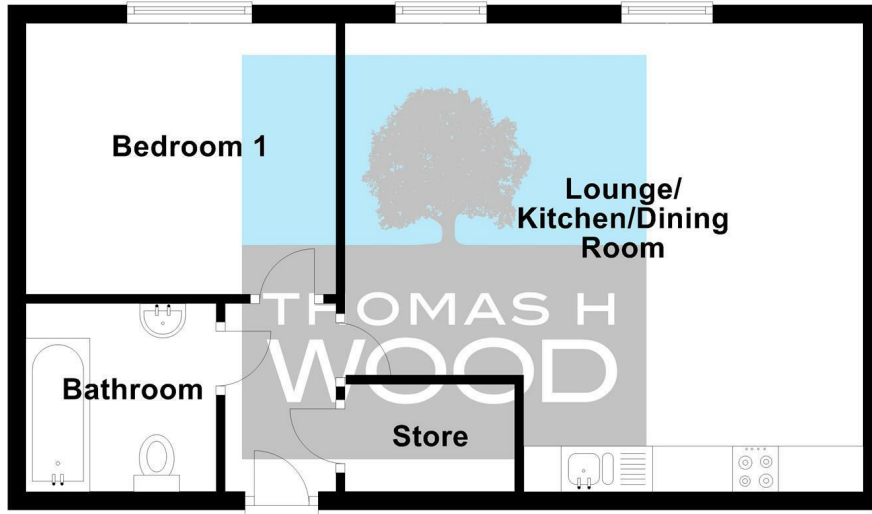

Total area: approx. 503.4 sq. feet



Agents Note: Whilst every care has been taken to prepare these sales particulars, they are for guidance purposes only. All measurements are approximate and for general guidance purposes only and whilst every care has been taken to ensure their accuracy, they should not be relied upon and potential buyers are advised to recheck the measurements

Energy Efficiency Rating		Current	Potential
Very energy efficient - lower running costs			
(92 plus) A			
(81-91) B		83	87
(69-80) C			
(55-68) D			
(39-54) E			
(21-38) F			
(1-20) G			
Not energy efficient - higher running costs			
England & Wales		EU Directive 2002/91/EC	

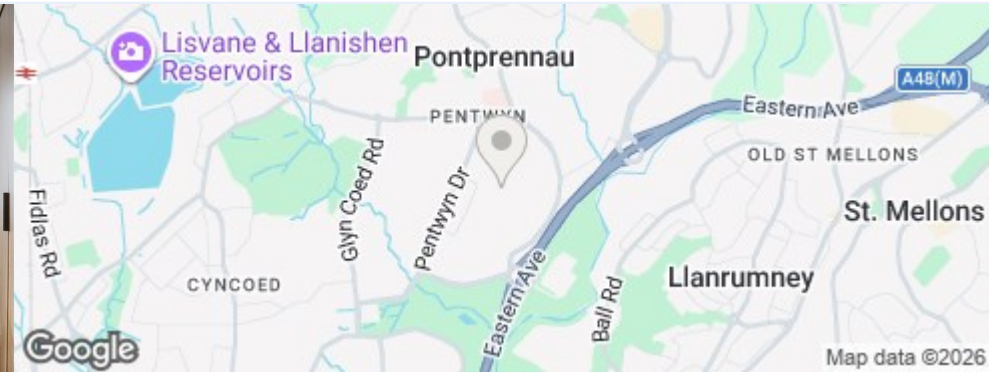

CONTACT

sales@thomashwood.com
02920 626 252
thomashwood.com

WHITCHURCH BRANCH

14 Park Road,
Whitchurch
CF14 7BQ

RADYR BRANCH

5 Station Road,
Radyr, Cardiff
CF15 8AA