



Prestwich Terrace, SW4

£850,000

A freehold terraced home naturally arranged over two floors with a south-west facing garden, comprising a forward facing reception room, a large kitchen/dining room, three bedrooms and a bathroom. Offered to the market with no onward chain and the potential to extend into loft and garden (STPP).

Prestwich Terrace is located within the Abbeville Village, a highly sought-after area known for its independent shops, restaurants and bars. Clapham Common and its corresponding station (Northern line) are just moments away, whilst Clapham Old Town is just around the corner. The area is also served by an excellent selection of outstanding primary schools in both the state and private sectors.

Features

- Freehold
- Three Bedrooms
- South West Garden
- Chain Free
- Potential To Extend
- Superb Location

Prestwich Terrace, London, SW4

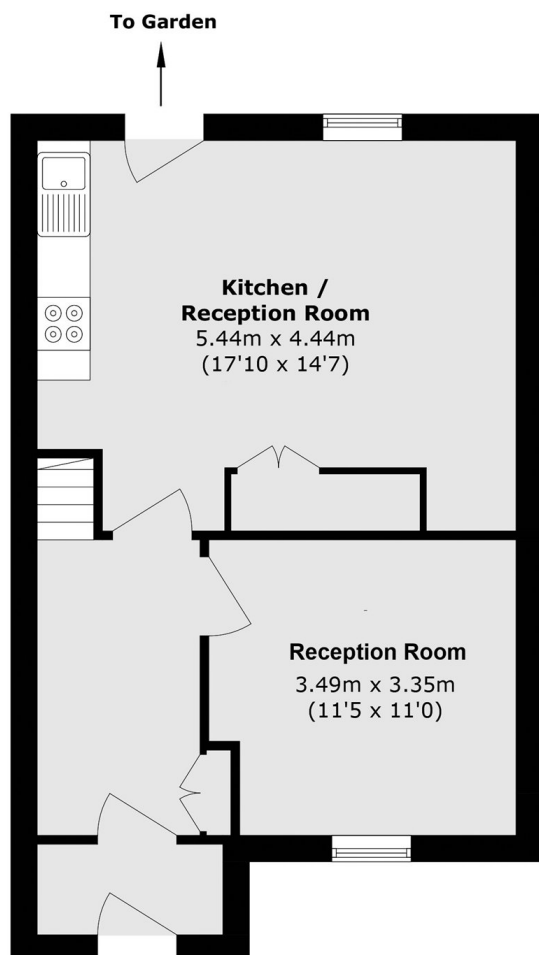

Ground Floor

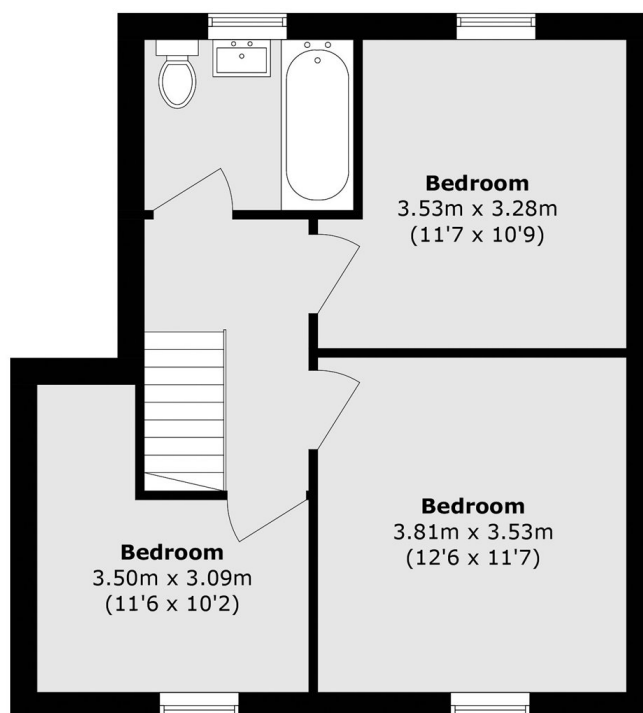

First Floor

Total area (approx.): 90.2 sq. m (970.9 sq. ft)