



Fermoy Road, W9

£485,000

A well-presented first floor flat set in a period conversion. This property comes complete with two bedrooms, one of which features a bay window, a sizeable reception, bathroom and separate kitchen.

Fermoy Road is less than half a mile from Westbourne Park underground station (Circle and Hammersmith and City lines) and multiple other transport links to central London. It is within walking distance of all the local amenities of Maida Vale, Queen's Park, Portobello Road and Westbourne Grove, along with the sporting facilities of Paddington Recreational Ground.

Features

- First Floor Flat
- Two Bedrooms
- Bay Window
- Separate Kitchen
- Chain Free
- Great Transport Links

Fermoy Road, Maida Vale, W9

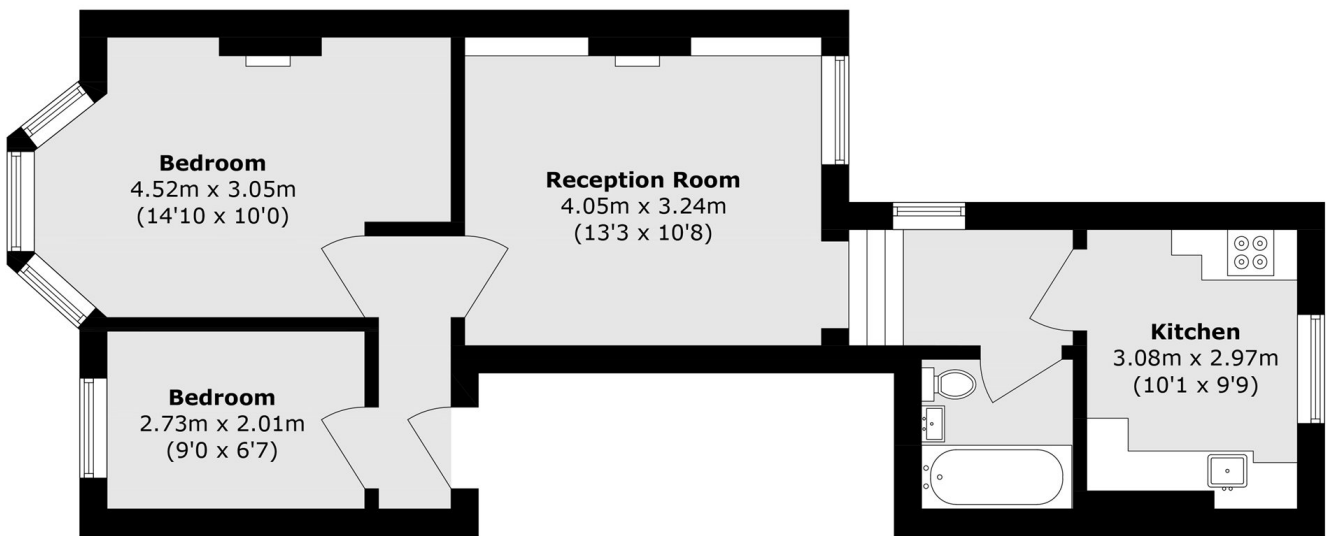

First Floor

Total area (approx.): 49.1 sq. m (528.5 sq. ft)