



Glaisdale Road Hall Green, Birmingham

- A Beautifully Presented & Extended Semi Detached Home
- Three Bedrooms
- Lounge
- Dining Area Opening to Extended L Shaped Kitchen

£325,000

Current EPC Rating 66 (D)
Current Council Tax Band C





Property Description

A beautifully presented extended semi detached home benefiting from three bedrooms, lounge, dining area opening to extended L shaped kitchen, re-fitted bathroom and separate WC, ample off-road parking and easterly facing rear garden



Tenure

We are advised by the vendor that the property is freehold. We would advise all interested parties to obtain verification through their own solicitor or legal representative

EPC supplied by Nigel Hodges
Current council tax band – C



Rooms & Measurements

Entrance Hall

Lounge to Front
4.7m x 3.66m (15'5" (into bay) x 12'0")

Dining Room
3.68m x 3.33m (12'1" x 10'11")

Extended L Shaped Kitchen to Rear
5.16m x 5.05m (16'11" x 16'7") narrowing to 6' 6"

Bedroom One to Front
4.7m x 3.43m (15'5" x 11'3")

Bedroom Two to Rear
3.89m x 3.4m (12'9" x 11'2")

Bedroom Three to Front
2.03m x 2.49m (6'8" x 8'2")

Family Bathroom to Rear

Separate WC to Side

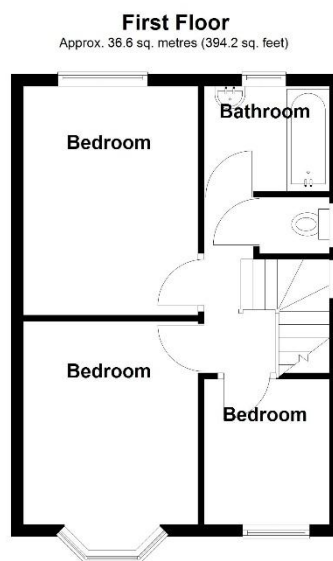
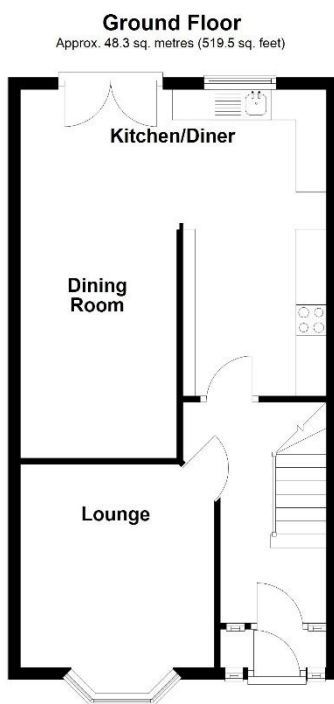

Total area: approx. 84.9 sq. metres (913.7 sq. feet)

316 Stratford Road
Shirley
Solihull
B90 3DN

www.smart-homes.co.uk
0121 744 4144

Agents Note: Whilst every care has been taken to prepare these particulars, they are for guidance purposes only. We believe all information to be correct from the day of marketing however, we advise and recommend that your conveyancer and or surveyor verifies all information supplied. All measurements are approximate are for general guidance purposes only and whilst every care has been taken to ensure their accuracy, they should not be relied upon and potential buyers are advised to recheck the measurements.