



The Drive, West Finchley, N3 1AE

Guide Price £475,000 Leasehold - Share of Freehold Council Tax Band E

REAL ESTATES

Est.1981

Estate Agents · Residential Sales · Investments · Lettings

Real Estates are delighted to bring to the market this 2 BEDROOM GROUND FLOOR apartment set in the iconic GRADE II LISTED Cedar Court, accessed via a GATED DRIVEWAY with residents parking and surrounded by stunning COMMUNAL GARDENS.

This SHARE OF FREEHOLD property offers an abundance of character throughout, including sash windows and fireplaces.

Cedar Court is a unique building in a quiet, secluded location just a stone's throw away from West Finchley Northern Line Underground Station whilst the shops, cafes and restaurants of Ballards Lane are within easy reach.

SHARE OF FREEHOLD. Service Charge: £330 pm. Lease 949 years. Ground Rent £0. Sole Agent





Cedar Court, The Drive, London, N3

Approximate Area = 720 sq ft / 66.9 sq m
For identification only - Not to scale

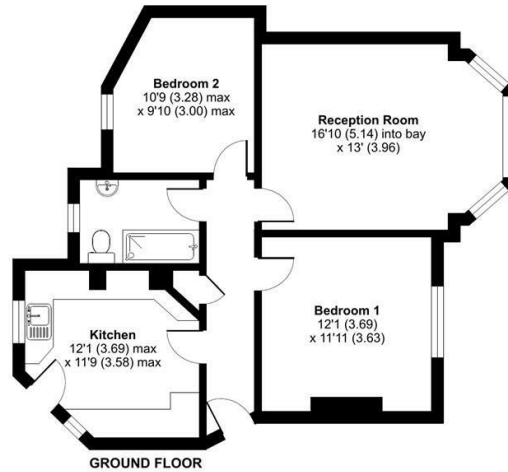

Floor plan produced in accordance with RICS Property Measurement 2nd Edition, incorporating International Property Measurement Standards (IPMS2 Residential). © richcom 2025. Produced for Real Estates. REF: 1362788

Energy Efficiency Rating		Current	Potential
Very energy efficient - lower running costs	A		
Energy efficient - lower running costs	B		
Decent energy efficiency - lower running costs	C		
Some energy efficiency - lower running costs	D	66	
Low energy efficiency - higher running costs	E		
Very low energy efficiency - higher running costs	F		
Very poor energy efficiency - higher running costs	G		77

EU Directive

