

£150,000



AKS
THE ESTATE AGENCY

This property at a glance:



Watch the video

Mill Street, Derby



Jodie says:

“Set on the second floor of the popular West Gate development, this spacious two double bedroom apartment is in a really convenient spot, just a short walk from Derby city centre.

What stands out straight away is how bright and spacious the apartment feels. The living/dining room is a really good size with plenty of room to relax or entertain, and the Juliet balcony lets lots of natural light pour in, making the whole space feel open and airy.

The kitchen is another lovely bright room thanks to its own Juliet balcony. There's loads of cupboard space, good worktop space, and room for under-counter appliances, so it feels practical as well as welcoming.

Both bedrooms are comfortable doubles, and the main bedroom has its own ensuite which is always a great extra to have. There's also a separate main bathroom.

Outside, there's some communal outdoor space to enjoy during the warmer months, and the gated parking adds that extra bit of convenience and security.

Overall, it's a really well-kept apartment that feels spacious, light, and easy to live in, in a great location for enjoying everything the city centre has to offer.”



Mill Street, Derby



Did you spot...

This great 2 bedroom apartment is available with no onward chain



A message from the seller:

AKS
THE ESTATE AGENCY



Floor Plan

Ground Floor

Approx. 72.9 sq. metres (784.5 sq. feet)

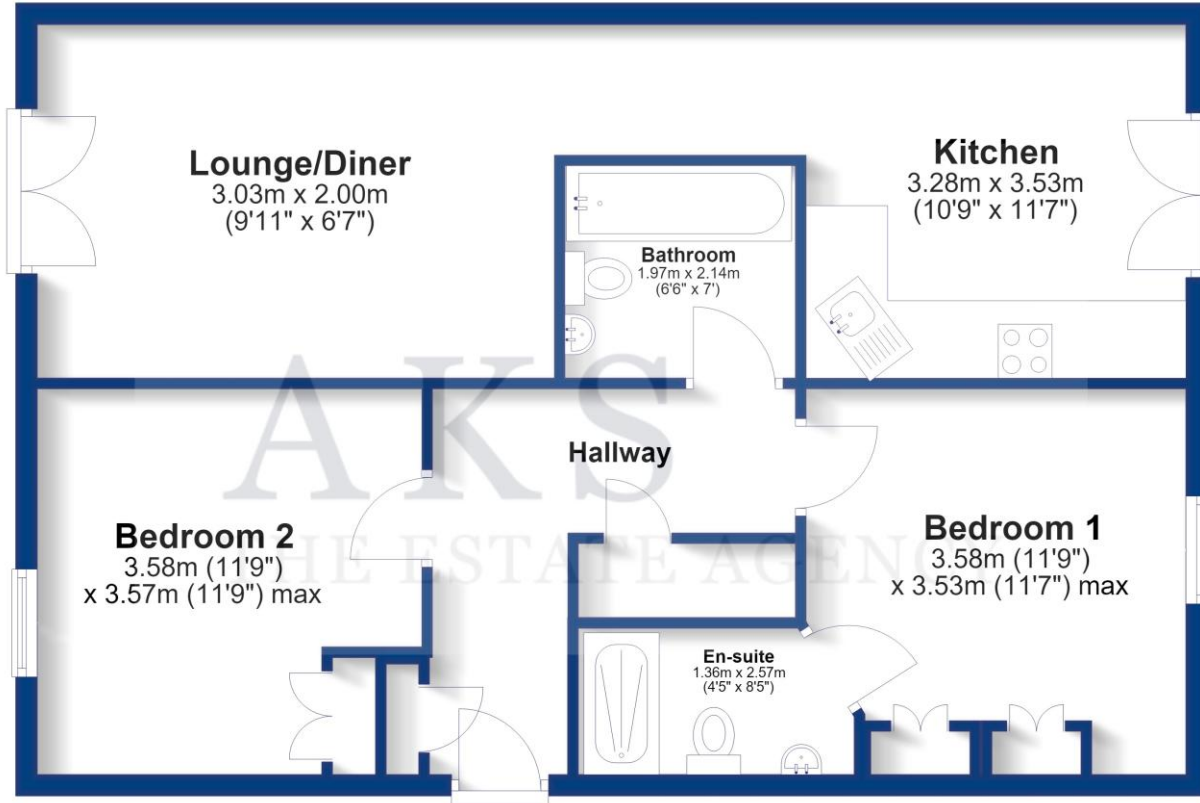

Total area: approx. 72.9 sq. metres (784.5 sq. feet)

AKS
THE ESTATE AGENCY
aksresidential.com



Energy Performance Certificate

Score	Energy rating	Current	Potential
92+	A		
81-91	B		84 B
69-80	C	75 C	
55-68	D		
39-54	E		
21-38	F		
1-20	G		

Mill Street, Derby

Presented by

AKS

THE ESTATE AGENCY



300+ 5 star Google Reviews



Key Features:

- TWO BEDROOM SECOND FLOOR APARTMENT
- SPACIOUS LOUNGE WITH A JULIET BALCONY
- MASTER BEDROOM WITH BUILT IN WARDROBES & EN-SUITE SHOWER ROOM
- FURTHER DOUBLE BEDROOM WITH BUILT IN WARDROBES
- GATED ACCESS TO ALLOCATED PARKING
- EPC RATING C
- NO ONWARD CHAIN



About the area:

Westgate is located within the City Centre of Derby making it a great location for any buyer with having all local amenities within walking distance to the property. As well as this, you're a very short walk away from the bus stop which gives easy access into the City Centre, Bus Station and Train Station as well as access to the Royal Derby Hospital. Also, within proximity to the property, there is Markeaton Park and easy access to the A38 leading to both the M1, A52 and A50 making it a great spot for commuters.



Schools:



Don't miss out on the chance to own this incredible property!

To book a viewing with **Jodie** call **01332 30 30 30**

[Click here to watch the property video](#)

