



Brondesbury Road, NW6

TO LET - £2,250 Per Month

AVAILABLE TO LET- A beautifully presented one bedroom flat on the Raised Ground Floor of a period conversion in the heart of Queens Park. The property boasts a fully integrated and modern eat-in kitchen, a separate bright and spacious reception room with wonderful high ceilings, a modern family bathroom and a generous south facing principal bedroom with endless amounts of built-in storage. Further benefits include hardwood floors, ample storage and the property is presented in immaculate condition throughout.

Brondesbury Road is a wonderful tree-lined street moments from Queens Park station (Bakerloo & Lioness Line- Zone 2) and Kilburn High Road (Lioness Line- Zone 2) and the local amenities of Salusbury Road and Kilburn High Road.

- AVAILABLE TO LET- FURNISHED/UNFURNISHED
- One bedroom Raised Ground Floor flat
- Hardwood floors and ample storage throughout
- Excellent transport links
- Close to local amenities
- DEPOSIT: £2596
- COUNCIL: Brent (C)



020 8450 9377

rentals@cameronsstiff.co.uk

cameronsstiff.co.uk



Denotes Restricted
Head Height

Brondesbury Road, NW6

Approximate Area = 67.2 sq m / 723 sq ft

Limited Use Area(s) = 1.3 sq m / 13 sq ft

Total = 68.5 sq m / 736 sq ft

For Identification only - Not to Scale

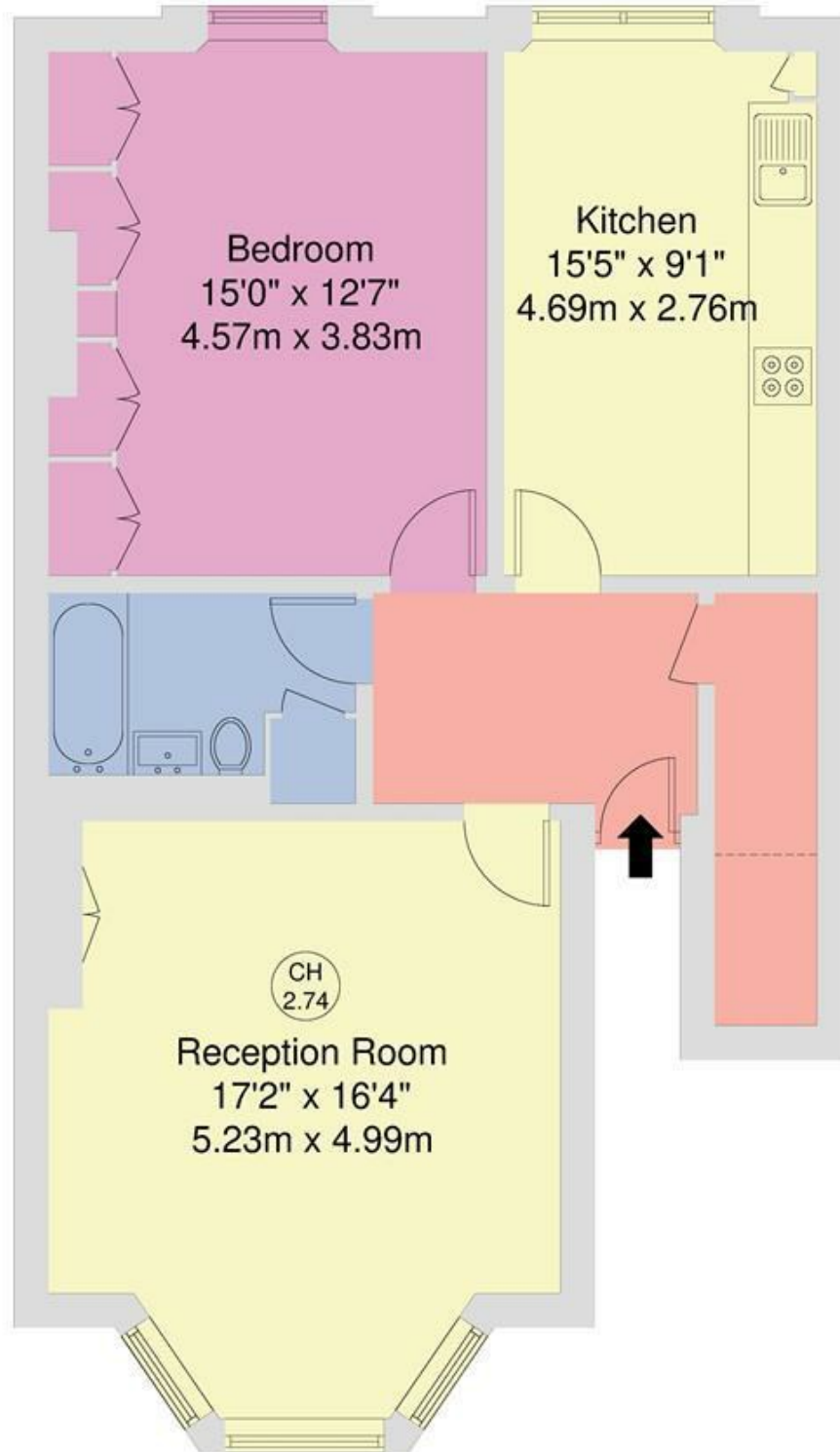

EPC: C

Ref: 19615109

RAISED GROUND FLOOR

Disclaimer: Floorplan produced in accordance with RICS guidelines. While we do not doubt the floorplan accuracy and completeness, you or your advisors should conduct a careful, independent investigation of the property in respect of monetary valuation. Produced for Camerons Stiff & Co.

