



Ashridge Close, London, N3

£915,000

Welcome to Ashridge Close, Finchley, N3 - a stunning property that is sure to capture your heart! This end terrace house, built in 2015 by The Berkeley Group, boasts a modern design and spacious layout perfect for comfortable living.

As you step inside, you are greeted by not one, but two inviting reception rooms, offering ample space for entertaining guests or simply relaxing with your loved ones. With four bedrooms and two bathrooms, there is plenty of room for the whole family to enjoy.

Spanning across 1850 square feet, this property provides a generous amount of space for you to personalise and make your own. The EPC rating of B ensures that this home is energy efficient, helping you save on those utility bills.

Located in the desirable area of Finchley, you'll have easy access to local amenities, schools, and transport links, making it a convenient location for both work and leisure.

Don't miss out on the opportunity to make this house your home. Contact us today to arrange a viewing and take the first step towards owning this beautiful property in Finchley.

Offers In Excess

Please note there is annual service charge of circa £600 to maintain the grounds as the property is located on a private road.

4  2  2  B 



**FINCHLEYS
ESTATES**

CLIENT FOCUSED. RESULTS DRIVEN.



- Modern Townhouse
- Chain Free
- 4 Bedrooms / 2 Bathrooms
- 1850 Sq Ft (excluding Eves)
- Energy Efficient B Rating

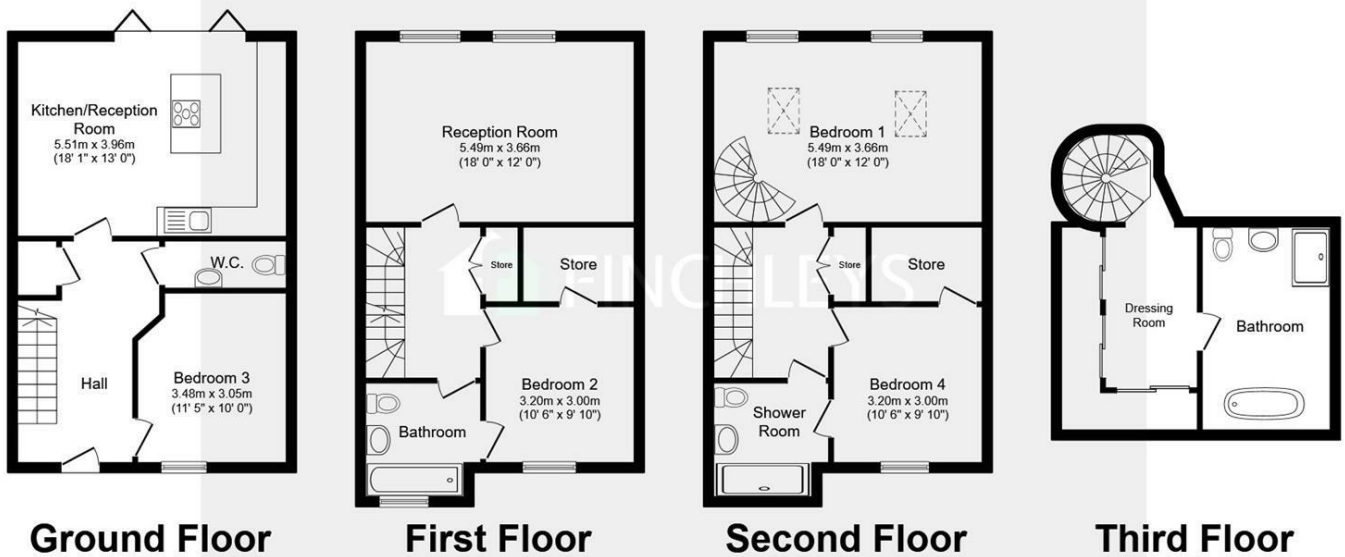
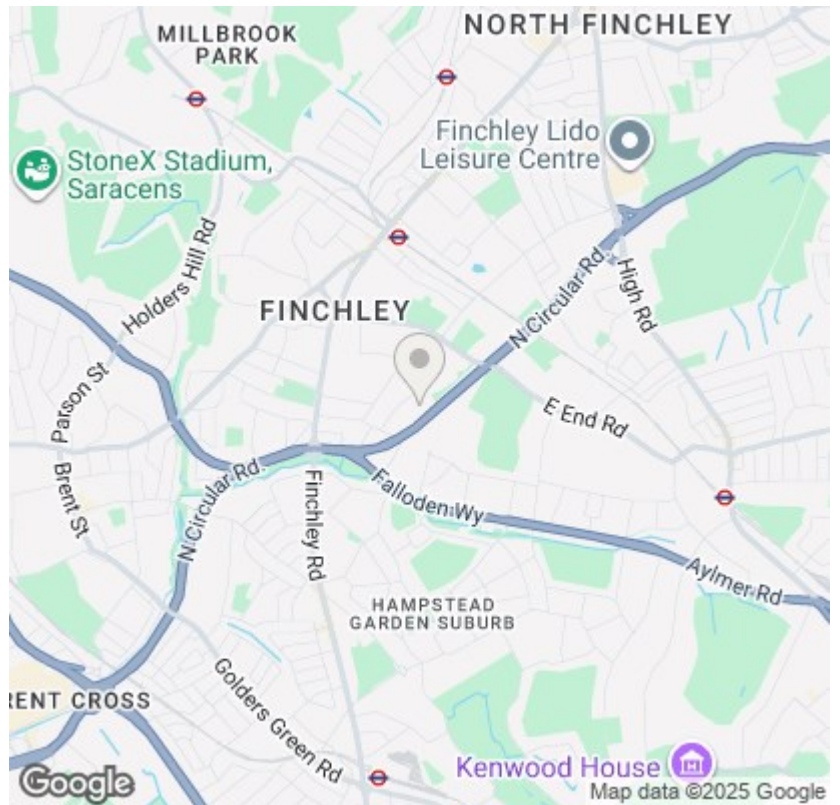

Total floor area 172.2 m² (1,853 sq.ft.) approx

This floor plan is for illustrative purposes only. It is not drawn to scale. Any measurements, floor areas (including any total floor area), openings and orientation are approximate. No details are guaranteed, they cannot be relied upon for any purpose and they do not form part of any agreement. No liability is taken for any error, omission or misstatement. A party must rely upon its own inspection(s).
Powered by www.focalagent.com



11 STATION ROAD
FINCHLEY
LONDON
N3 2SB
02083461180