



## CALEDONIAN ROAD, N1

£590,000

Private Garden  
Two Bedrooms  
No Onward Chain  
Share of Freehold  
Kitchen  
Reception Room

@marshandparsons  
marshandparsons.co.uk

MARSH &  
PARSONS



# ABOUT THE PROPERTY

A period conversion garden flat, complete with two bedrooms, a family bathroom, a kitchen, and a reception room, offering direct access to a private garden. The property is offered to the market with no onward chain.

Caledonian Road is situated on one of Islington's most accessible and well-connected thoroughfares in London, N1. The property enjoys excellent transport links with Caledonian Road & Barnsbury Overground, Caledonian Road Underground (Piccadilly Line) and major national rail connections at King's Cross & St Pancras International all within easy walking distance.



# STEP INSIDE CALEDONIAN ROAD

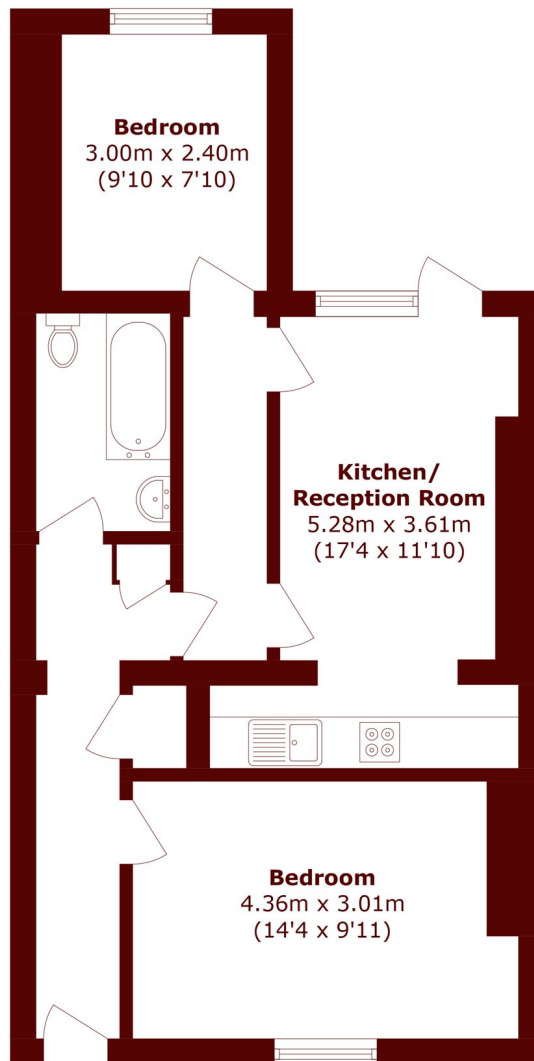

Total area (approx.): 56.5 sq. m (608.2 sq. ft)

Camden  
020 7244 2200

Energy Rating: C We aim to make our particulars both accurate and reliable. However, they are not guaranteed; nor do they form part of an offer or contract. If you require clarification on any points then please contact us, especially if you're traveling some distance to view. Please note that appliances and heating systems have not been tested and therefore no warranties can be given as to their good working order

MARSH &  
PARSONS