



# FELIKS AUGUSTINE

PROPERTY SALES AND LETTINGS



## £2,000 Per

A stunning, larger than usual apartment with expansive views across South East London. This property has an excellent layout making it easily one of the best in the Colorado Building in the Deals Gateway development. Two large double bedrooms with a good sized bathroom. Wooden flooring throughout much of the apartment and a quality fitted kitchen with integrated fridge freezer, induction hob and oven. The Deals Gateway development also benefits from services such as a gymnasium, training pool, bar, restaurant and 24 hour concierge as well as excellent links with the Docklands Light Railway. Greenwich is also only a short walk away.

This property has one reception room, two well-proportioned bedrooms, and a contemporary bathroom, making it an ideal choice for individuals or small families seeking comfort and convenience.

The flat is located just two minutes from the Docklands Light Railway (DLR), providing excellent transport links to key destinations such as Bank, Canary Wharf, Greenwich, and Lewisham as well as to Victoria, London Bridge, Cannon Street, Charing Cross, and Waterloo.









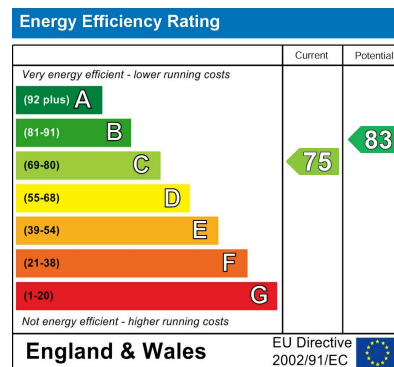
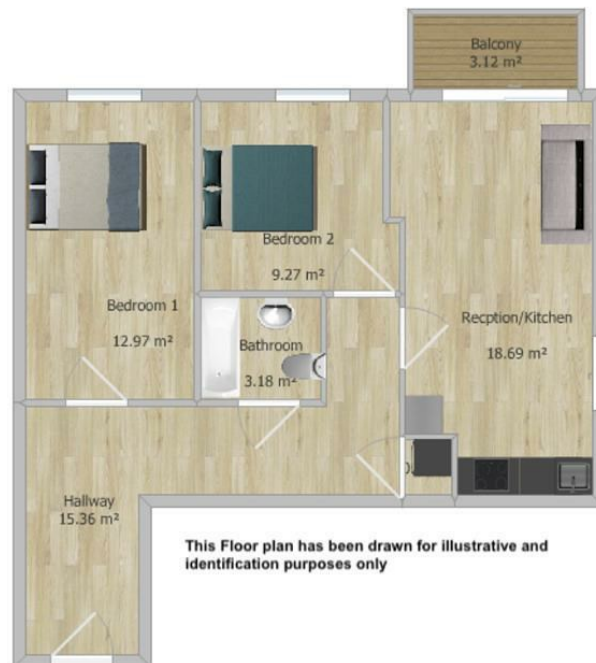

Agents Note: Whilst every care has been taken to prepare these particulars, they are for guidance purposes only. All measurements are approximate and are for general guidance purposes only and whilst every care has been taken to ensure their accuracy, they should not be relied upon and potential buyers/tenants are advised to recheck the measurements

London Bridge  
52 Weston Street  
London  
SE1 3QJ

lettings@feliksaugustine.com  
<http://www.feliksaugustine.com/>

