



ALDERWOOD
ESTATE AGENTS

104 Foredrove Lane, Solihull
£1,400 pcm









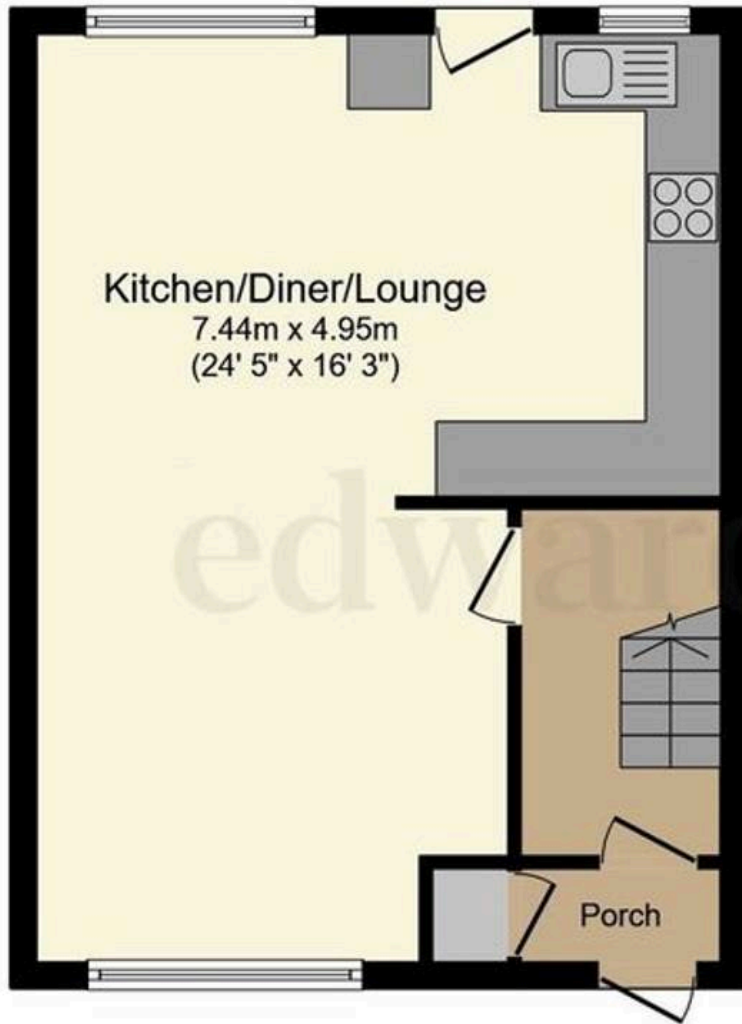

Kitchen/Diner/Lounge
 7.44m x 4.95m
 (24' 5" x 16' 3")

Porch

Ground Floor

Floor area 40.8 sq.m. (439 sq.ft.)

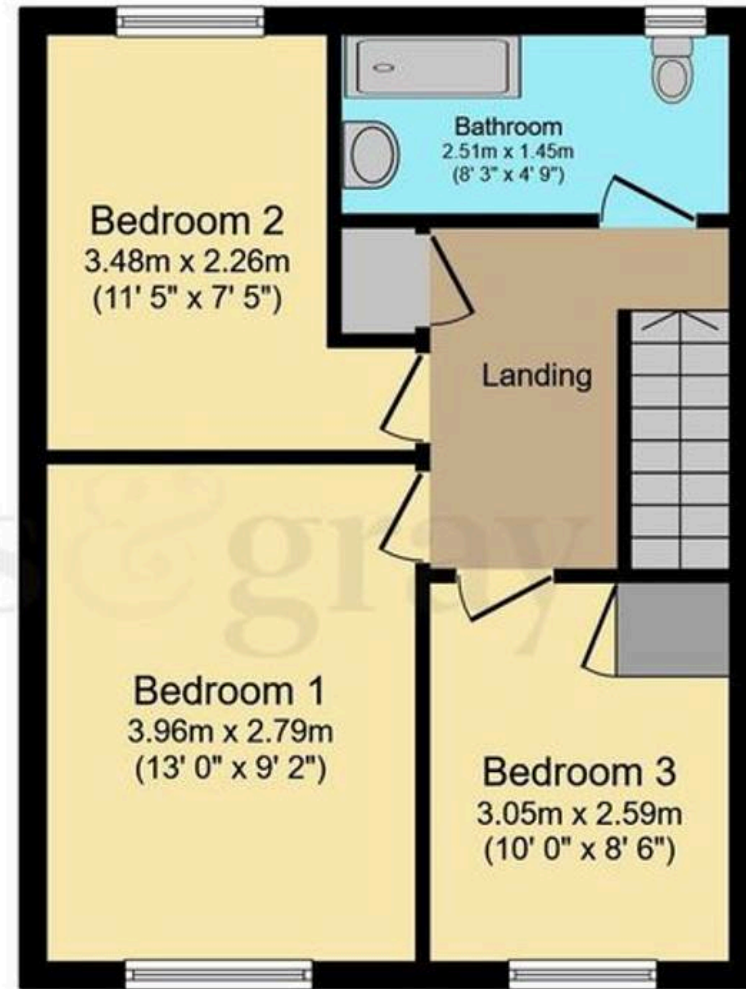

Bedroom 2
 3.48m x 2.26m
 (11' 5" x 7' 5")

Bathroom
 2.51m x 1.45m
 (8' 3" x 4' 9")

Landing

Bedroom 1
 3.96m x 2.79m
 (13' 0" x 9' 2")

Bedroom 3
 3.05m x 2.59m
 (10' 0" x 8' 6")

First Floor

Floor area 40.8 sq.m. (439 sq.ft.)

Total floor area: 81.6 sq.m. (879 sq.ft.)

This floor plan is for illustrative purposes only. It is not drawn to scale. Any measurements, floor areas (including any total floor area), openings and orientations are approximate. No details are guaranteed, they cannot be relied upon for any purpose and do not form any part of any agreement. No liability is taken for any error, omission or misstatement. A party must rely upon its own inspection(s). Powered by www.Propertybox.io