



Connells

Great Hampton Street
Whitmore Reans Wolverhampton



Property Description

Samuel Thorneywork from the award winning Connells Wolverhampton branch is delighted to bring to the market this extended and immaculately presented three bedroom mid-terraced family home situated in a popular location near to Wolverhampton city centre.

Internally the property comprises of a entrance porch, entrance hall, ground floor wc, modern styled lounge, extended entertainment kitchen area with integrated appliances and living area. On the first floor there are three bedrooms and a stylish family bathroom.

Externally to front there is a front garden whilst the rear benefits from a low maintenance rear garden.

Viewing is highly recommended to appreciate the accommodation on offer and would be suitable for first time buyers, investors and families.

Location And Area

Wolverhampton City Centre within walking distance of West Park, ideally placed for commuting links and there are numerous local schools.

Approach

Set back from the roadside behind a front garden with access to the main accommodation.

Porch

Double glazed windows, ceiling spotlights, door to entrance hallway.

Entrance Hallway

Ceiling spotlights, stairs to first floor, radiator, doors to ground floor wc, lounge and entertainment kitchen/ living area.

Lounge

15' 1" x 11' 5" (4.60m x 3.48m)
Double glazed window to front, inset LED strip lighting, vertical radiator, ceiling light point.

Ground Floor Wc

Low flush wc, wash hand basin unit, panelled walls, ceiling light point, double glazed window to front.



Entertainment Kitchen

20' 7" x 16' 9" (6.27m x 5.11m)

Matching wall and base units with sink and drainer with mixer tap, integrated fridge, freezer, oven, microwave, dishwasher, washing machine, partly tiled walls, electric hob with extractor screen above, built in bluetooth speakers, radiator, wall mounted boiler, vertical radiator, double glazed window to rear, ceiling spotlights, french doors to rear.

First Floor Landing

Ceiling light point, loft access, two storage cupboards, doors to all bedrooms and family bathroom.

Bedroom One

13' 5" x 9' 9" (4.09m x 2.97m)

Double glazed window to front, ceiling light point, radiator.

Bedroom Two

12' 5" x 9' 6" (3.78m x 2.90m)

Double glazed window to rear, ceiling light point, radiator.

Bedroom Three

8' 5" x 7' 6" (2.57m x 2.29m)

Double glazed window to front, ceiling light point, radiator.

Bathroom

P-shaped bath with shower attachment, electric shower over, vanity wash hand basin with wc and bidet, heated towel rail, extractor fan, wall mounted heater, shaver point, tiled walls, double glazed window to rear and ceiling spotlights

Outside Rear

Indian sandstone paving patio area with lawn, timber fencing, double socket point, hot and cold taps, rear gate to shared access.







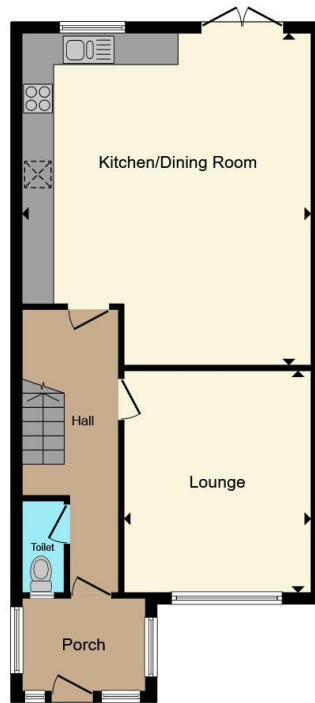

Ground Floor

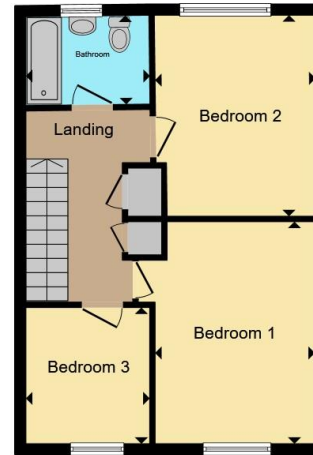

First Floor

Total floor area 107.2 m² (1,154 sq.ft.) approx

This floor plan is for illustrative purposes only. It is not drawn to scale. Any measurements, floor areas (including any total floor area), openings and orientation are approximate. No details are guaranteed, they cannot be relied upon for any purpose and they do not form part of any agreement. No liability is taken for any error, omission or misstatement. A party must rely upon its own inspection(s). Powered by www.propertybox.io

Connells

To view this property please contact Connells on

T 01902 710 170

E wolverhampton@connells.co.uk

81-83 Darlington Street
WOLVERHAMPTON WV1 4EX

EPC Rating: Council Tax
Awaited Band: A

Tenure: Freehold

view this property online connells.co.uk/Property/WVH335312



1. MONEY LAUNDERING REGULATIONS Intending purchasers will be asked to produce identification documentation at a later stage and we would ask for your co-operation in order that there will be no delay in agreeing the sale. 2. These particulars do not constitute part or all of an offer or contract. 3. The measurements indicated are supplied for guidance only and as such must be considered incorrect. Potential buyers are advised to recheck measurements before committing to any expense. 4. We have not tested any apparatus, equipment, fixtures, fittings or services and it is in the buyers interest to check the working condition of any appliances.

Connells Residential is registered in England and Wales under company number 1489613, Registered Office is Cumbria House, 16-20 Hockliffe Street, Leighton Buzzard, Bedfordshire, LU7 1GN. VAT Registration Number is 500 2481 05.

See all our properties at www.connells.co.uk | www.rightmove.co.uk | www.zoopla.co.uk

Property Ref: WVH335312 - 0004