

## Marsham Road, Birmingham, B14 5HD

Offers Over £230,000

3 1 1



Viewings are highly recommended for this three bedroom semi-detached property situated on Marsham Road, B14. Located in a popular residential area, this home offers an excellent opportunity for buyers looking to put their own stamp on a property, and it is being sold with no upward chain with a garage to rear.

## Key Features

- Three bedroom semi-detached property
- Popular residential location
- Offered for sale with no upward chain
- Spacious lounge/diner with bay window
- Conservatory overlooking rear garden
- Kitchen with access to conservatory
- Two double bedrooms and one single
- Family bathroom to first floor
- Large rear garden with excellent potential
- Garage to Rear

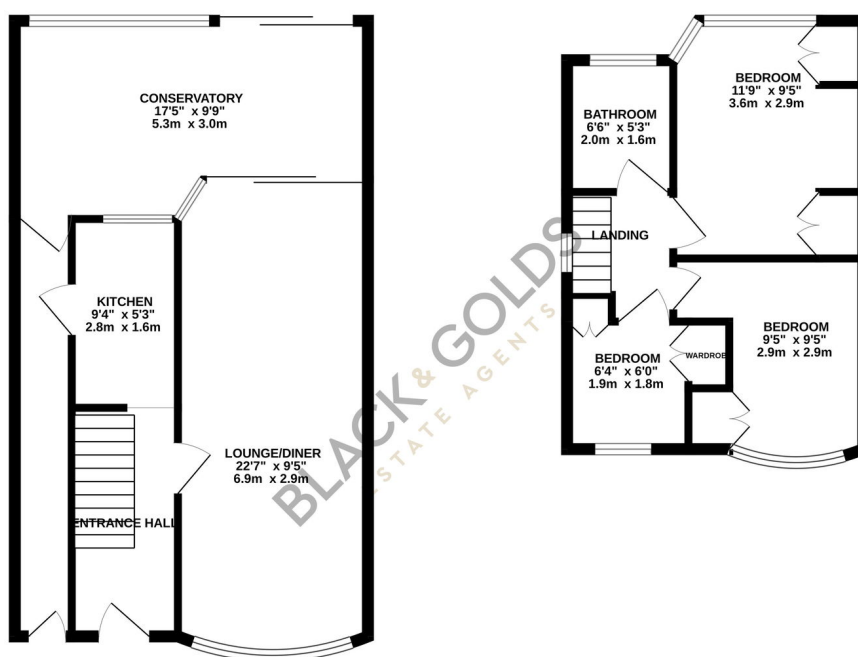

TOTAL FLOOR AREA: 836 sq.ft. (77.7 sq.m.) approx.

Whilst every attempt has been made to ensure the accuracy of the floorplan contained here, measurements of doors, windows, rooms and any other items are approximate and no responsibility is taken for any error, omission or mis-statement. This plan is for illustrative purposes only and should be used as such by any prospective purchaser. The services, systems and appliances shown have not been tested and no guarantee as to their operability or efficiency can be given.

Made with Metropix ©2025