



Levellers Road, Saffron Walden £633,500 **Freehold**

KH Kevin
Henry

Key Features

 4  2  B  F

- Immaculately presented detached house
- Four double bedrooms
- Spacious lounge and separate study room
- Stunning kitchen/diner
- Large west facing rear garden

Step into this beautifully presented executive-style detached home, where light-filled interiors and generous proportions create an inviting sense of space and sophistication. The welcoming hallway sets the tone, leading to a grand lounge ideal for both relaxation and entertaining. At the heart of the home lies a stunning kitchen and dining area, designed for modern living and perfect for family gatherings or dinner parties. A private study offers the ideal retreat for working from home, while a stylish cloakroom completes the ground floor.

Upstairs, four luxurious double bedrooms provide comfort for the whole family. The principal suite boasts a sleek en suite bathroom, while the remaining bedrooms are served by an equally stylish family bathroom. Thoughtful touches such as loft access and an airing cupboard add practicality to this elegant home. The west-facing rear garden is a true highlight,



with a generous patio and lawned area - the perfect setting for summer entertaining or tranquil evenings. To the front, a private driveway and integral garage offer convenience and curb appeal. Blending modern design with timeless comfort, this exceptional home is a rare opportunity not to be missed. Set within a popular development, this home also benefits from approximately 7.5 years remaining on the NHBC warranty. Ideally located close to Saffron Walden town centre, residents enjoy easy access to local shops, schools, and amenities. Saffron Walden is a fine old market town with a good range of shopping, schooling and recreational facilities, including the renowned Saffron Hall, which is situated at the County High School. The town also boasts an independent, award-winning cinema showing mainstream and art house films, a museum and art galleries. There are several sports facilities, including The Lord Butler Fitness and Leisure Centre, with its two swimming pools, squash and tennis courts, health suite, gym and creche. Audley End mainline station (with fast trains to Liverpool Street and Cambridge) is just two miles distance and the M11 access point at Stump Cross 4 miles.

Hallway
Under-stair storage cupboard.

Lounge
5.36m x 3.45m
17'7" x 11'4"

Kitchen/Diner
7.36m x 3.43m
24'2" x 11'3"



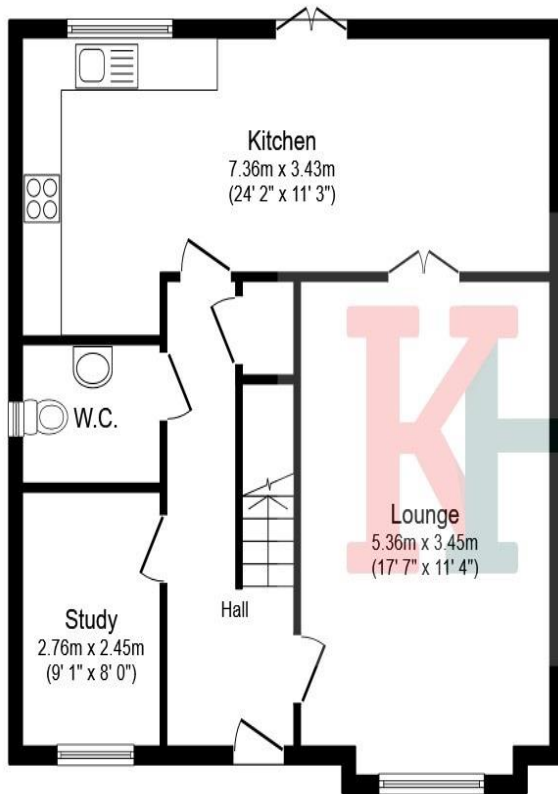

Ground Floor

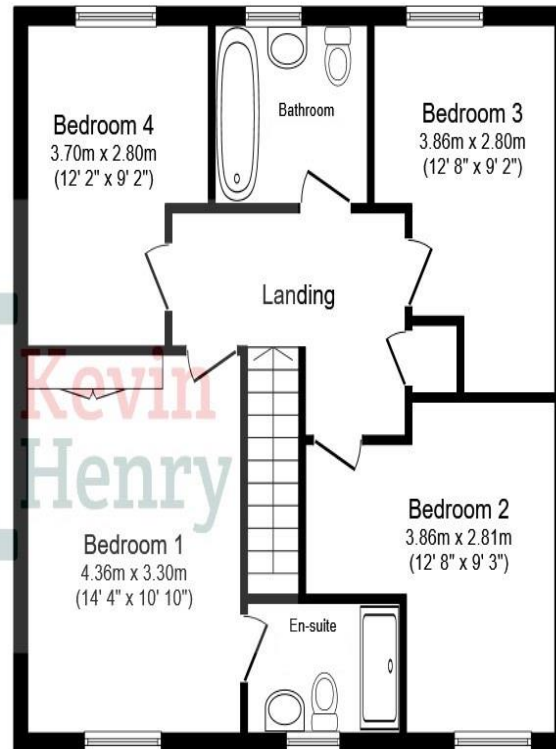

First Floor

Study
2.76m x 2.45m
9'1" x 8'0"

Downstairs Cloakroom

First Floor Landing
Access to loft and airing cupboard.

Bedroom One
4.36m x 3.30m
14'4" x 10'10"
Built in wardrobes.

Shower en-suite

Bedroom Two
3.86m x 2.81m max
12'8" x 9'3" max

Bedroom Three
3.86m x 2.80m max
12'8" x 9'2" max

Bedroom Four
3.70m x 2.80m
12'2" x 9'2"

Bathroom

Garden
Private fully enclosed west facing rear garden with patio and lawn.

Front
Entrance to garage and driveway parking.

This floor plan is for illustrative purposes only. It is not drawn to scale. Any measurements, floor areas (including any total floor area), openings and orientation are approximate. No details are guaranteed, they cannot be relied upon for any purpose and they do not form part of any agreement. No liability is taken for any error, omission or misstatement. A party must rely upon its own inspection(s). Powered by www.focalagent.com

To view this property call Kevin Henry on:
01799 513632

Selling your property?

Contact us to arrange a FREE home valuation.

 01799 513632

 1 Market Street, SAFFRON WALDEN, Essex, CB10 1JB

 sales@kevinhenry.co.uk

 www.Kevinhenry.co.uk



 SCAN ME



Kevin Henry is a trading name of Sharman Quinney Holdings Limited which is registered in England and Wales under company number 4174227, Registered Office is Cumbria House, 16-20 Hockliffe Street, Leighton Buzzard, Bedfordshire, LU7 1GN. VAT Registration Number is 500 2481 05.

1: These particulars do not constitute part or all of an offer or contract. 2: The measurements indicated are supplied for guidance only and as such must be considered incorrect. 3: Potential buyers are advised to recheck the measurements before committing to any expense. 4: Kevin Henry has not tested any apparatus, equipment, fixtures, fittings or services and it is the buyers interests to check the working condition of any appliances. 5: Kevin Henry has not sought to verify the legal title of the property and buyers must obtain verification from their legal representative. 6: Intending purchasers will be asked to produce identification documentation at a later stage and we would ask your co-operation in order that there will be no delay in agreeing the sale. Ref: SAF103595 - 0005

