

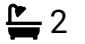

Earlswood Common, Earlswood, Solihull, B94 5SJ

Offers Over £650,000

 4  2  2



Immaculate and Spacious Four Bedroom Dormer Bungalow with No Upward Chain

Key Features

- Immaculate four bedroom dormer bungalow
- Beautifully modernised and extended throughout
- Spacious lounge opening into extended reception room
- Modern fitted kitchen
- Three ground floor bedrooms
- First floor main bedroom with private shower room
- Contemporary family bathroom
- Large driveway providing ample off-road parking
- Well-maintained rear garden with open views
- No upward chain

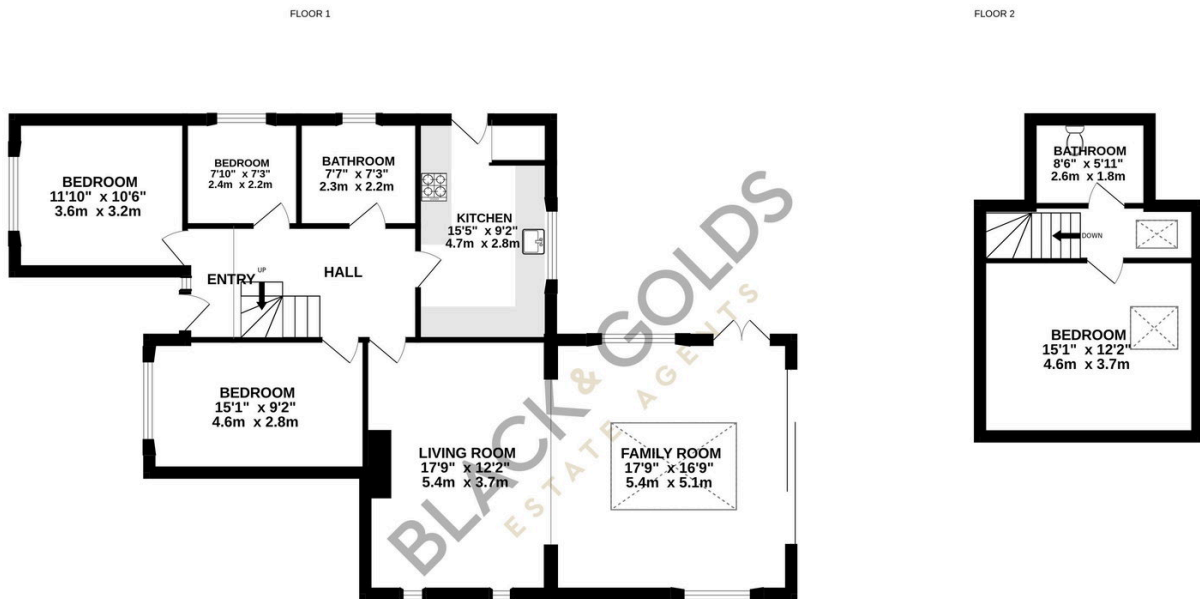

Whilst every attempt has been made to ensure the accuracy of the floorplan contained here, measurements of doors, windows, rooms and any other items are approximate and no responsibility is taken for any error, omission or mis-statement. This plan is for illustrative purposes only and should be used as such by any prospective purchaser. The services, systems and appliances shown have not been tested and no guarantee as to their operability or efficiency can be given.
Made with Metropix ©2026