



Shelley Road,

£355,000

FOR SALE



- Vendor found!
- Great sized bedrooms
- Tidy rear garden
- Extended home
- Spacious floorplan
- Garage with electric door

THE PROPERTY

This extended three bedroom semi detached home is situated in the heart of the popular "Janes Estate". With easy access to secondary and primary schools, play parks and cycle track links to Midsomer Norton and Radstock it makes a fantastic family home which plenty of space to grow.

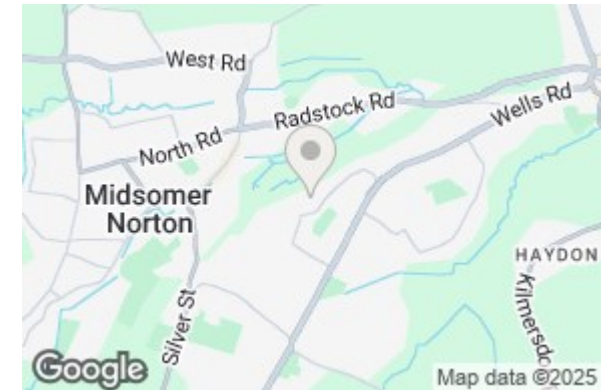
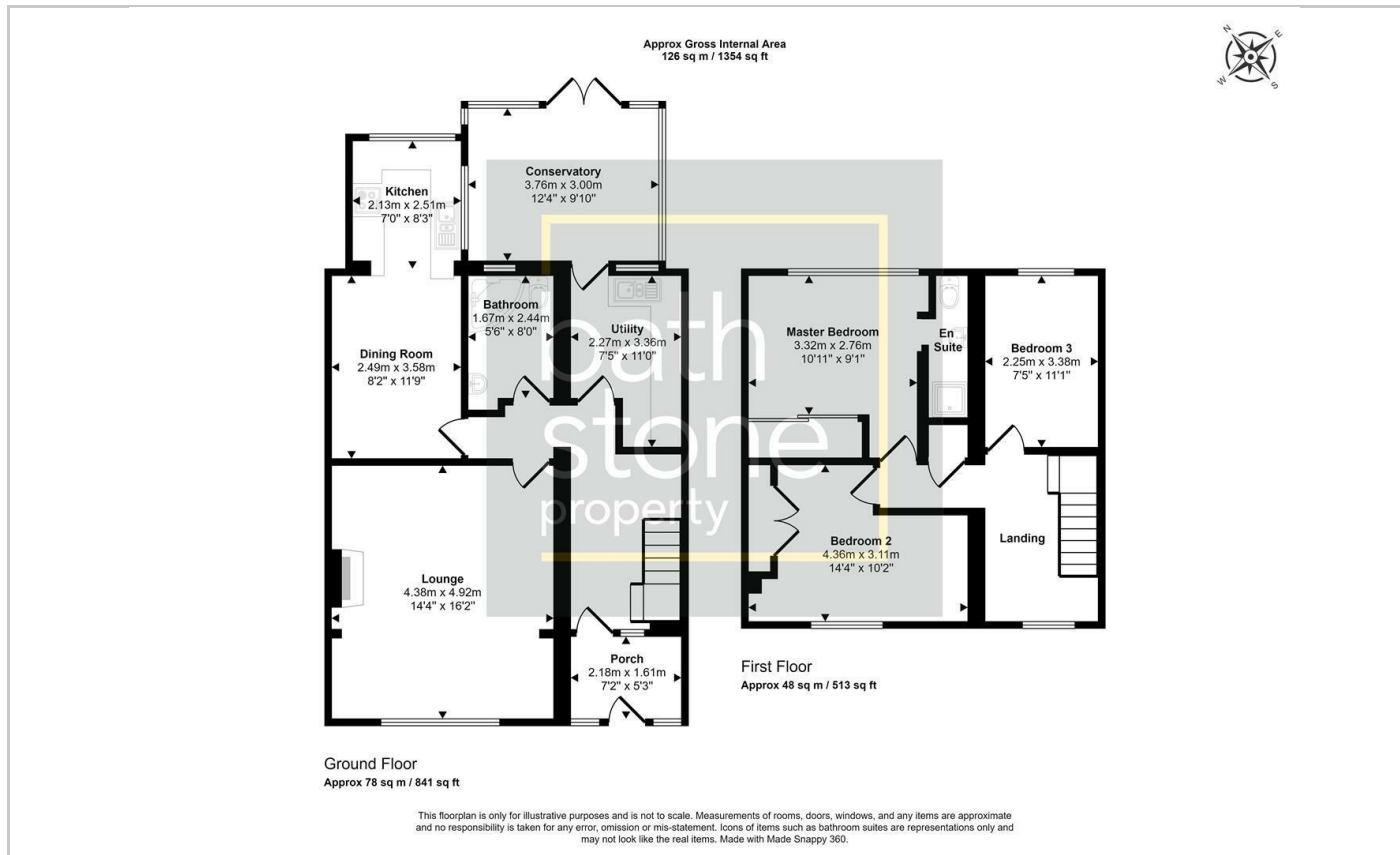

Energy Efficiency Rating		
	Current	Potential
<i>Very energy efficient - lower running costs</i>		
(92 plus) A		
(81-91) B	82	87
(69-80) C		
(55-68) D		
(39-54) E		
(21-38) F		
(1-20) G		
<i>Not energy efficient - higher running costs</i>		
England & Wales		
EU Directive 2002/91/EC		