

1 The Mount, Normanton, WF6 1NU

This exceptional huge four-bedroom semi-detached period home, discreetly positioned off Snyderdale Road in Normanton, offers a rare opportunity to acquire a property of true character and distinction. Extending to approximately 180 sqm, around 50 Sq more than your average 4 bedroom detached, the home boasts generous proportions and impressive high ceilings, seamlessly combining original period features with stylish modern living.

The property has been thoughtfully and comprehensively renovated throughout, creating a beautifully presented interior ready to move straight into. Outside, a charming garden and a private courtyard accessed from the kitchen provide ideal spaces for relaxing and entertaining.

With the vendor considering part exchange a unique home of this calibre must be seen to be fully appreciated—early viewing is highly recommended.

- Four Bedroom Semi Detached Period Home
- Part Exchange Considered
- Beautifully Renovated Throughout
- Modern Fitted Kitchen and Dining Space
- Impressive High Ceilings
- Rear Courtyard and Large Garden
- Driveway for Two Cars
- Secluded Location
- Approximately 180 Sqm Of Living Space

£350,000

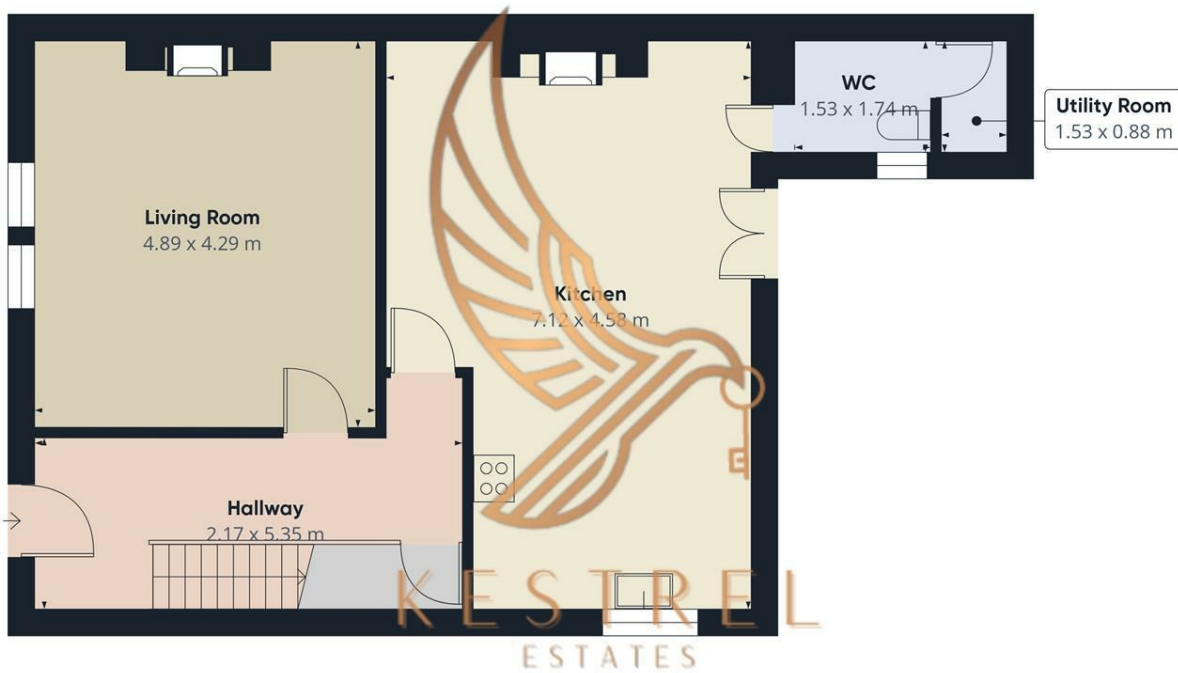

Approximate total area⁽¹⁾
66.5 m²

(1) Excluding balconies and terraces

Calculations reference the RICS IPMS 3C standard. Measurements are approximate and not to scale. This floor plan is intended for illustration only.

GIRAFFE360

Energy Efficiency Rating		Current	Potential
Very energy efficient - lower running costs			
(92 plus) A			
(81-91) B			
(69-80) C			
(55-68) D			
(39-54) E			
(21-38) F			
(1-20) G			
Not energy efficient - higher running costs			
England & Wales	EU Directive 2002/91/EC	69	80