



43 Lime Street, Harrogate

£315,000 Guide Price



**YOUR AWARD
WINNING AGENT**

#DARINGTOBEDIFFERENT



A spacious three-bedroom detached family home occupying a generous corner plot in this highly regarded residential location, within walking distance of the famous Stray, Harrogate town centre and an excellent range of local amenities.

The property has been lovingly maintained over many years and now offers an exciting opportunity for a purchaser to modernise and create a superb family home in a sought-after setting.

A substantial driveway provides ample off-street parking, and the rear garden also benefits from useful timber garden sheds for additional storage.

Council Tax band: D

Tenure: Freehold



The well-proportioned accommodation comprises a welcoming entrance hall with staircase leading to the first floor, a guest WC, and a generous bay-fronted sitting room filled with natural light. Double doors open through to the dining room, providing an excellent flow for both everyday living and entertaining, with French doors leading directly onto the garden. The adjoining kitchen is fitted with a range of wall and base units, work surfaces, and space for freestanding appliances, together with direct access outside.

To the first floor, there are three well-sized bedrooms, including a spacious principal bedroom with fitted wardrobes providing excellent storage. The remaining bedrooms offer versatile accommodation ideal for family living, guest rooms, or home-working space. The house bathroom is fitted with a three-piece suite comprising a panelled bath with shower attachment, wash hand basin, and WC.

A particular feature of the property is the attractive outside space. Occupying a generous corner plot, the mature gardens extend to the front, side, and rear and enjoy a good degree of privacy, with established hedging, shaped lawns, colourful planted borders, and a variety of shrubs and trees creating a delightful setting throughout the seasons. Paved pathways and seating areas provide ideal spaces for outdoor relaxation and entertaining.



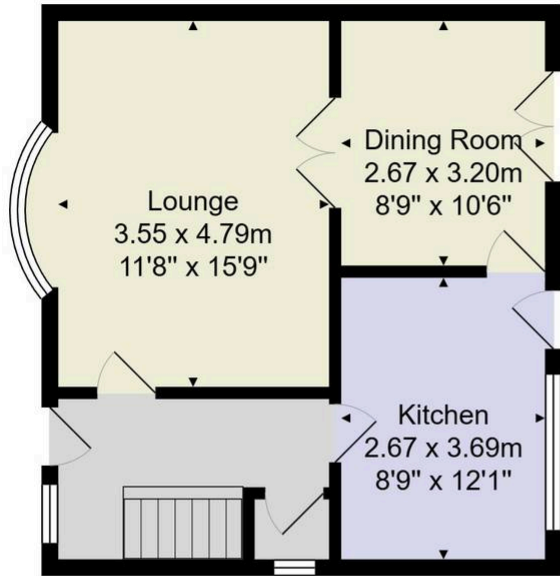

Ground Floor

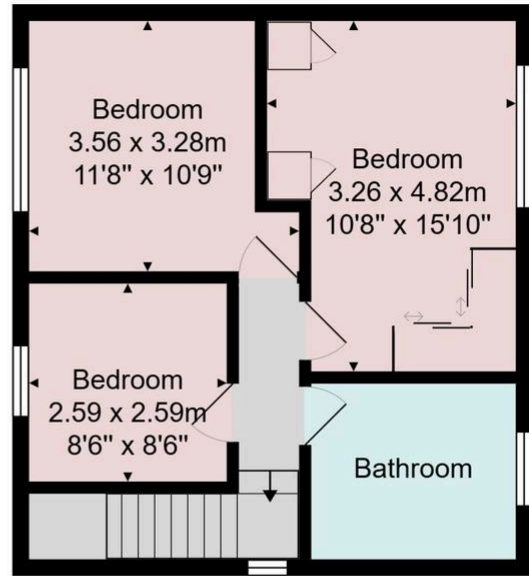

First Floor

Total Area: 90.4 m² ... 973 ft²

All measurements are approximate and for display purposes only.

No liability is accepted by either the agency or Box Property Solutions Ltd as to the exact measurements of the rooms. Box Property Solutions Ltd retains the copyright on this plan and allows agents to use it with agreed permission.

